

CLIP-ON & ADAPTER SADDLE INSTALLATION

1

2390

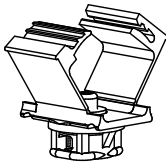

2389

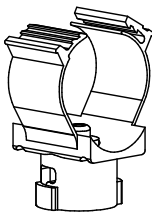
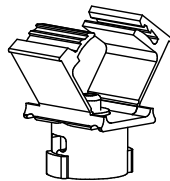

2386

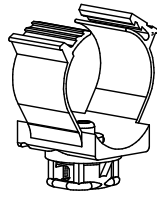

2385

2

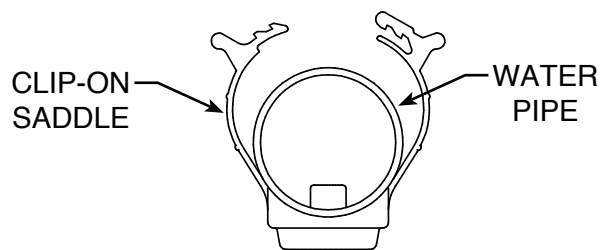

POSITION CLIP-ON SADDLE
ONTO WATER PIPE

3

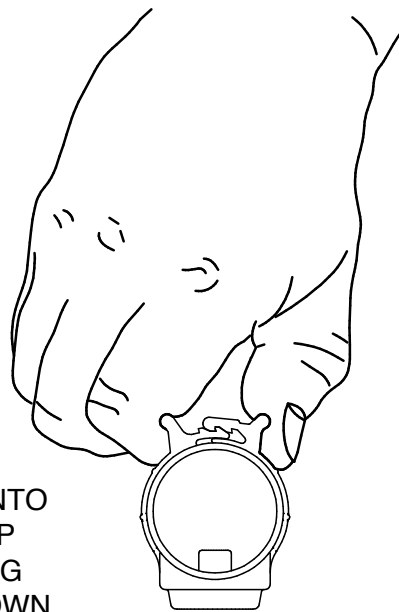

SQUEEZE CLIP INTO
ITS FIRST SNAP
POSITION USING
FINGERS AS SHOWN

4

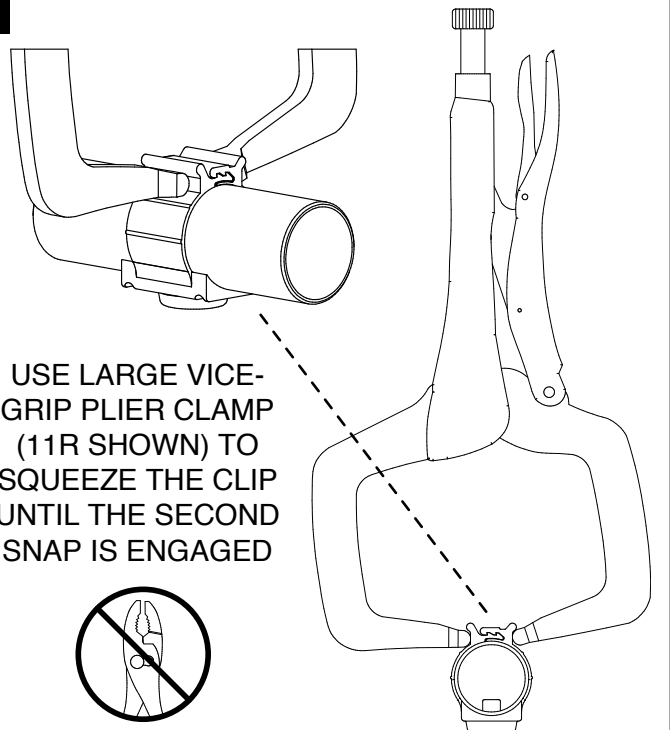

USE LARGE VICE-
GRIP PLIER CLAMP
(11R SHOWN) TO
SQUEEZE THE CLIP
UNTIL THE SECOND
SNAP IS ENGAGED