

FOR THESE CLIP-ON SADDLE TYPES:

SCALE: 40%

2898

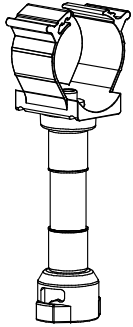

2388

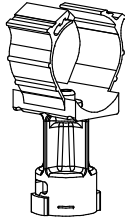

2386

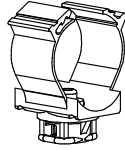

2385

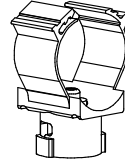

FIRST SNAP POSITION

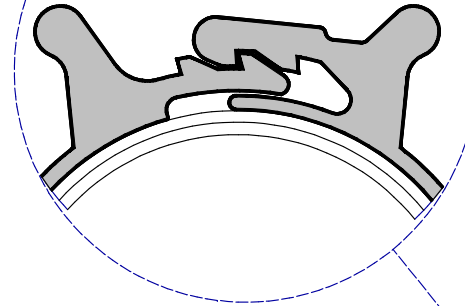

①

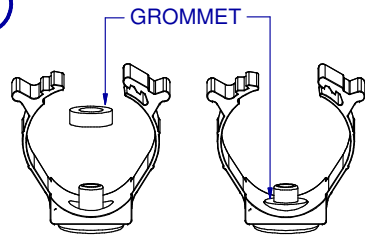

INSTALL THE GROMMET
ONTO THE SADDLE

②

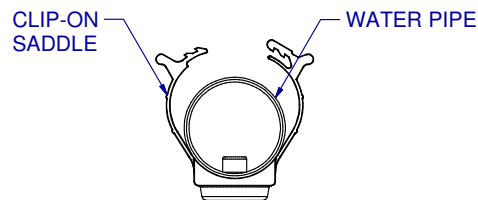

POSITION CLIP-ON SADDLE
ONTO WATER PIPE

③

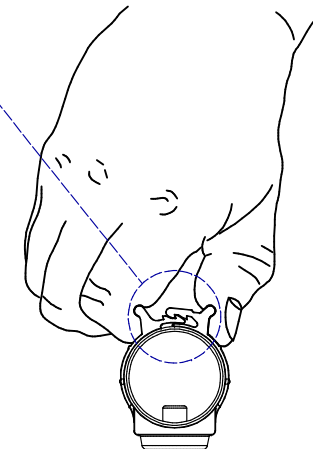

SQUEEZE CLIP INTO ITS FIRST
SNAP POSITION USING
FINGERS AS SHOWN
NOTE: STEP 4 ON NEXT PAGE

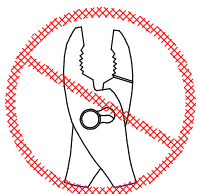

**WARNING: DO NOT USE
ADJUSTABLE PLIERS
OR CHANNEL LOCKS!**



INSTALLATION INSTRUCTIONS: CLIP-ON SADDLES
PAGE 1 OF 2

DATE: 07-27-18

REVISION: 2

PART NR.:

GL1079

USE PN 3817 OR VISE-GRIP PLIER "11R" TO COMPLETE STEP 4 OF THE INSTALLATION.

SCALE: 40%

④



CENTER PN 3817 ON THE CLIP ON SADDLE AS SHOWN

PN 3817

USE PN 3817 TO SQUEEZE THE CLIP UNTIL THE SECOND SNAP IS ENGAGED

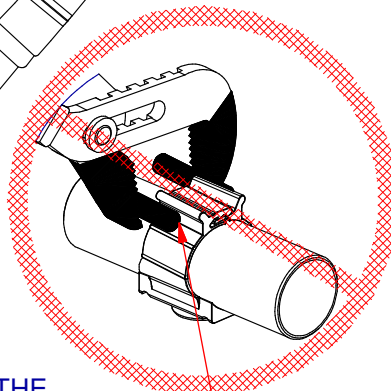

DO NOT OFFSET THE TOOL TO ONE SIDE. THIS WILL CAUSE DAMAGE AND PRODUCT TO FAIL

④

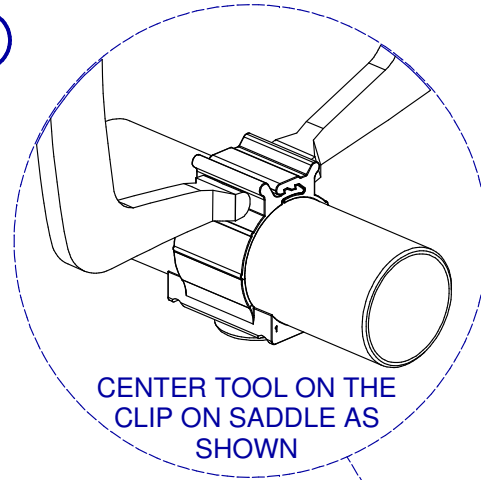

CENTER TOOL ON THE CLIP ON SADDLE AS SHOWN

VICE-GRIP 11R

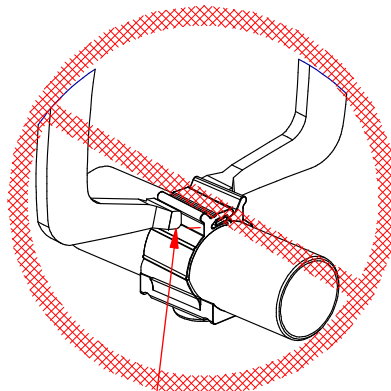

DO NOT OFFSET THE TOOL TO ONE SIDE. THIS WILL CAUSE DAMAGE AND PRODUCT TO FAIL

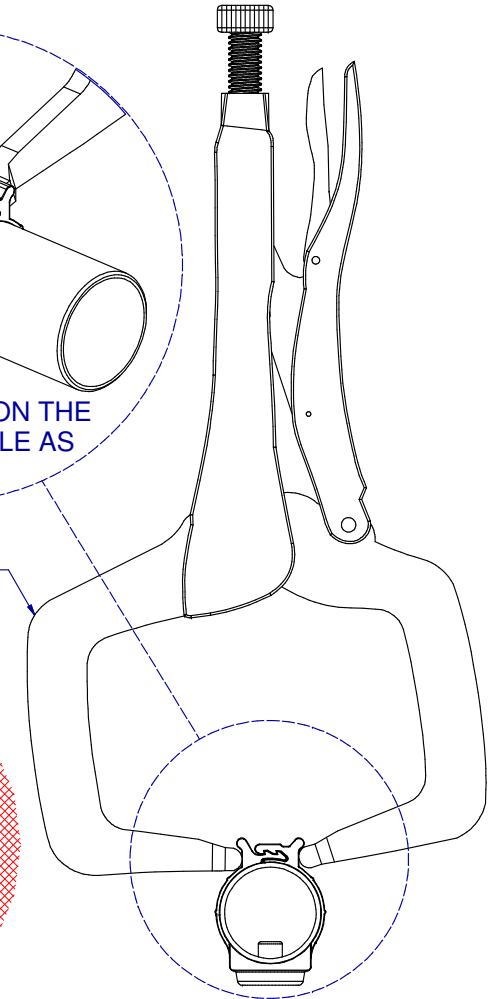

USE LARGE VICE-GRIP PLIER CLAMP (11R SHOWN) TO SQUEEZE THE CLIP UNTIL THE SECOND SNAP IS ENGAGED