

The Poultry Watering Specialists



Installation Manual: D-Max & T-Max System Featuring Nuvo™ Product Line

Issued: August 2023

Superior performance, exceptional durability and easy management.

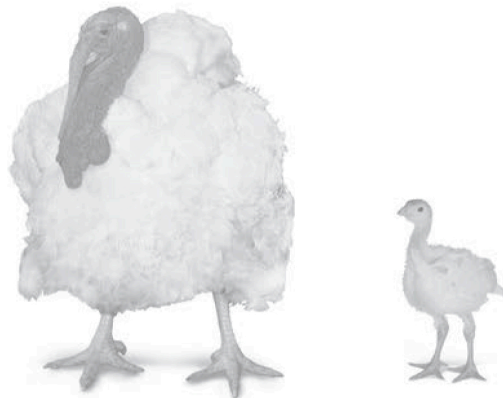

ZIGGITY SYSTEMS, INC.
STANDARD LIMITED WARRANTY

Ziggity Systems, Inc. ("Ziggity") warrants to the original retail purchaser ("Purchaser") of any Ziggity product ("Product"), sold by an authorized Ziggity distributor, that for one (1) year from the date of original retail purchase, the Product will be free from defects in materials and workmanship that are material in nature. The sole remedy available to Purchaser in the event of such a defect will be the repair or replacement (at Ziggity's sole option) of the materially defective Product, excluding labor. Purchaser will be responsible for the expense of shipping the defective Product to Ziggity and, upon Ziggity's approval of the warranty claim, Ziggity will be responsible for the expense of shipping the repaired or replaced Product to Purchaser. Any Product or Product replacement parts provided by Ziggity under this warranty are only warranted for the remainder of the warranty period for the original Product. Any Product or Product replacement part replaced by Ziggity under this warranty becomes the property of Ziggity. For warranty service, please contact an authorized Ziggity distributor. Alternatively, warranty requests may be sent directly to Ziggity at 101 Industrial Parkway East, Middlebury IN, 46540, USA.

This limited warranty excludes liability for defects in or damage to the Product (both internal and external) caused, directly or indirectly, by misuse, neglect, negligence, alteration, accident, excessive mineral or chemical contact, corrosive chemical use, minerals or sediment in the water, poor quality water, acts of nature or failure to: (A) follow Ziggity's guidelines and recommendations for the Product, (B) follow installation and operating instructions for the Product, (C) use potable and filtered water in and with the Product, or (D) properly maintain the Product. It also excludes used Products or Products acquired from sellers who are not authorized Ziggity distributors. Furthermore, this warranty does not extend to any item that is manufactured by others, including without limitation, items such as: galvanized support pipe, water filters, water meters, sight gauges and proportioners. These items are warranted separately by the original manufacturer, if at all.

Ziggity makes no other representations or warranties of any kind except as expressly stated in this warranty. Implied warranties, if any, arising by state law, including any implied warranties of merchantability or of fitness for a particular purpose, are limited in duration and scope to the terms of this limited warranty. Ziggity disclaims any and all implied warranties, including the warranty of merchantability and the warranty of fitness for a particular purpose, on components and items not covered by this limited warranty. To the fullest extent permitted by applicable law, Ziggity shall not be liable to Purchaser for any consequential, incidental, exemplary, punitive, special, or indirect damages, and Ziggity shall not be liable for any damages that are based on negligence, breach of warranty, or strict liability. Ziggity's liability under this warranty shall in no event exceed the purchase price paid by Purchaser for the defective Product. Some states do not allow limitations on how long an implied warranty lasts or the exclusion or limitation of incidental or consequential damages, so the above exclusions and limitations may not apply fully to you.

Ziggity may from time to time, through its issuance of formal Information Update documents, provide for supplemental warranty coverage in addition to this standard limited warranty for certain products, or may provide for deviations or exclusions from this standard warranty for certain products. If any such supplemental, deviation, or exclusion Information Updates apply to your Product, you will be provided with a copy of such Information Updates at the time of your original retail purchase and the standard limited warranty provided for above will be deemed modified accordingly.

No person, including any dealer, distributor, agent, or other representative of Ziggity, is authorized to make any representation or warranty concerning the Product other than as specifically contained in this standard limited warranty and any Information Update from Ziggity providing for any supplemental warranty coverage or deviation or exclusion from warranty coverage. Ziggity reserves the right to change Product models, make changes to the Product and Product specifications, at any time and without notice or obligation to Purchaser.

[CONTINUES ON NEXT PAGE]

ZIGGITY SYSTEMS, INC.
EXTENDED DRINKER WARRANTY

In addition to its standard limited warranty, Ziggity provides an extended warranty for certain Drinkers manufactured by Ziggity. All other provisions of the standard limited warranty apply to the Extended Drinker Warranty. If any covered Drinker is determined by Ziggity to be defective in materials or workmanship after the expiration of the one (1) year standard warranty period and prior to ten (10) years after the date of the original retail purchase, Ziggity will provide a replacement Drinker or Drinker components, as applicable, to the original retail purchaser at the following discount off of published list/brutto prices:

End User Purchase Date	End User Discount
0 - 36 months	100% (No charge)
37 - 60 months	65%
61 - 120 months	40%

WARNING – AVOID USE WITH OR EXPOSURE TO CORROSIVE PRODUCTS

Do not allow Ziggity products to come into contact with petroleum, phenol or aldehyde based products or any other corrosive product in general. Contact with such corrosive products is likely to result in damage to or failure of the Ziggity product. Additionally, aggressive chlorination and/or acidification programs (greater than 1 ppm and/or pH less than 6) will shorten the life of Ziggity products. Failure to follow this warning will void any otherwise applicable warranty coverage for the Ziggity product when the product is chemically damaged.

WARNING – GALVANIZED SUPPORT PIPE SPECIFICATIONS

Please note that using a support pipe that does not conform to the specifications noted in Ziggity's official written publications, including but not limited to, Information Update 2065 and our Installation Manuals, will compromise system performance and make null and void Ziggity's warranty provisions.

PLEASE NOTE

Extended Drinker Warranty does not apply to Ziggity drinkers with the following metering pin colors:
Blue, Gray, Gold, Red, and Black.

Extended Drinker Warranty does not apply to T-Max Drinkers.

SPECIFICATIONS / INSTALLATION INSTRUCTIONS / NOTES / WARNINGS ETC.

GALVANIZED SUPPORT PIPE SPECIFICATIONS:

- Outside Diameter (O.D.): 1.050 in (± 0.005 in) or 26.90 mm (± 0.30 mm)
- Wall Thickness: 19 Gauge or 1.00 mm (minimum acceptable wall: 0.037 in or 0.94 mm)
- ASTM - A513 or equivalent standard
- Swage element coaxial or concentric to the remainder of the pipe
- Bow tolerance: 0.031 in or 0.80 mm per 3 feet or 1 meter section
- G60 Coating or better
- Ends deburred and painted with a polyester-based polymer containing zinc oxide

SLOPE FLOOR APPLICATIONS: There are two resources available for proper set-up and installation of slope neutralizers in slope poultry houses. "Installation Manual: Slope Neutralizer Floor Applications" and a video entitled "How to install Ziggity Slope Neutralizer". Both can be found under the Support tab (Installation Manuals and Installation Videos) on the Ziggity.com website.

SELF-TAPPING SCREWS: For ease of installation, use an 18V or stronger impact driver

WARNINGS:

- All Ziggity water bearing pipes must be installed in a manner to accommodate temperature induced pipe expansion and contraction. Failure to do so will cause pipes to snake, break, or gap resulting in water floods. These potential problems can be avoided by following the procedures as spelled out in Ziggity's Floor Installation Manuals.

The Poultry Watering Specialists



CONTENTS

T-MAX SYSTEM FLOOR APPLICATION INSTALLATION

Support Pipe	6
Nuvo™ Regulator and Riser Assembly	7
Clip-On Saddle Assembly	9
Clip-On Bracket Orientation	10
Clip-On Bracket	11
Pipe Gapping with Ink Mark on End of Pipe	12
Pipe Gapping without Ink Mark on Pipe	13
Nuvo™ Flush End & Riser Assembly	14
Screw Placement for Clip-On Bracket	14
Clip-On Bracket Screw	15
D-Max Lock Drinker	15
T-Max Drinker Assembly With Cordless Drill and Nutsetter	16
T-Max Drinker Assembly and Installation - Hand Assembly	17
T-Max to Flex Saddle Reinforcement Assembly	18
Heavy Duty Anti-Roost	19
PN 2970	20
PN 2971	22
Drain Hose	24

OPTIONAL EQUIPMENT

Air Release and Shut-Off Assembly + Inline Riser Assembly	26
Control Clock/Controller/Solenoid Flush	27
Regulator Ball Valve Lock	28

BEST PRACTICES

Disassembly: D-Max Drinker	30
Assembly: D-Max Drinker	31
Disassembly: T-Max Drinker	32
Assembly: T-Max Drinker	33
Solenoid Valve Maintenance	34

APPENDIX

Normal Operation Mode/Flush Mode	36
Nuvo™ Regulator Assembly	37
Nuvo™ Flush End Assembly	38
Nuvo™ Riser Assembly	39

SUPPORT PIPE

1

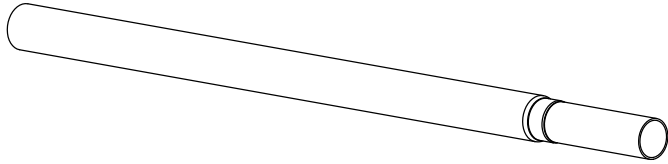

Outside Diameter (O.D.): 1.050 in (± 0.005 in) or 26.90 mm (± 0.30 mm)
 Minimum Wall Thickness: 19 Gauge (0.037 in or 0.95 mm)
It can be thicker but not thinner!
 ASTM - A513 or equivalent
 G60 Coating or better

2

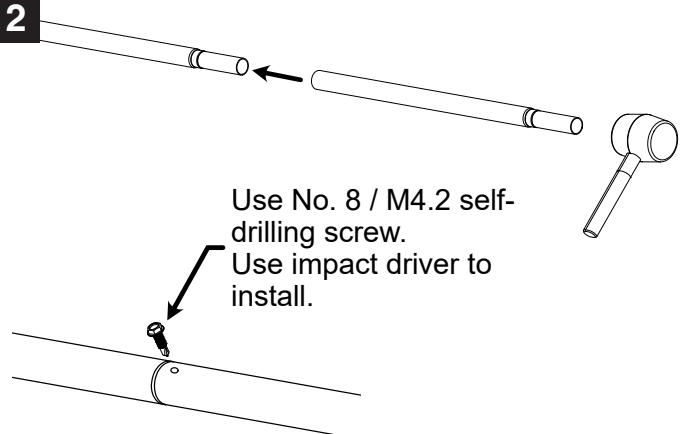

Use No. 8 / M4.2 self-drilling screw.
 Use impact driver to install.

3

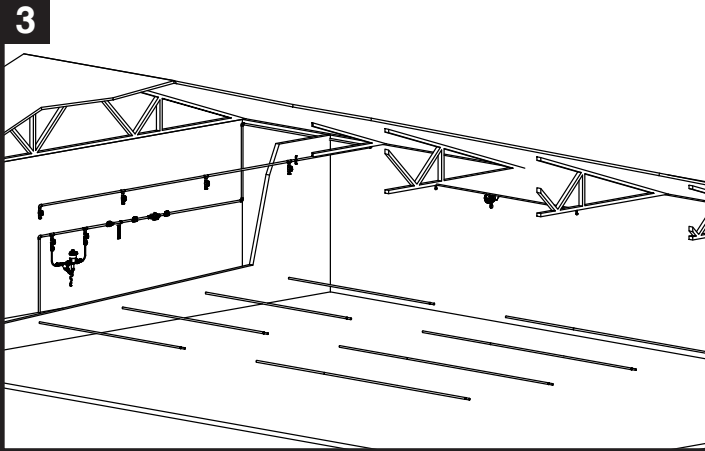

4

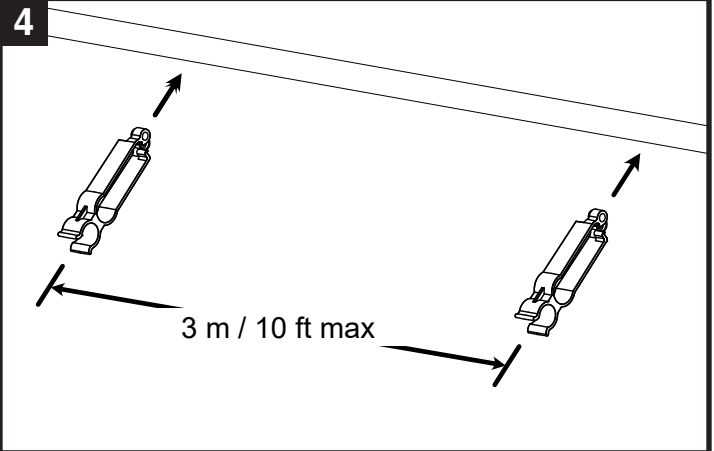

3 m / 10 ft max

5

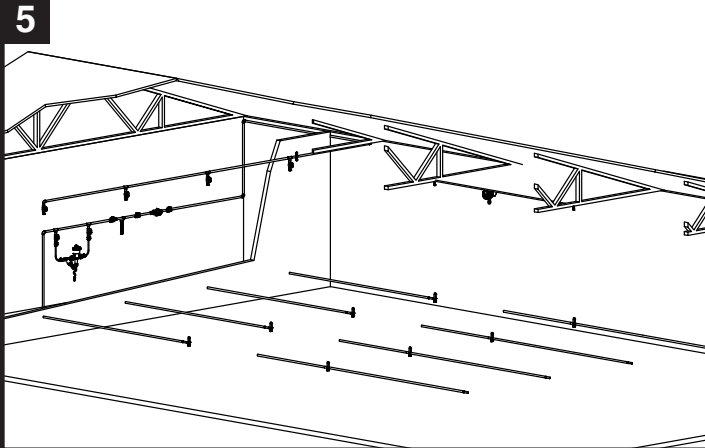

6

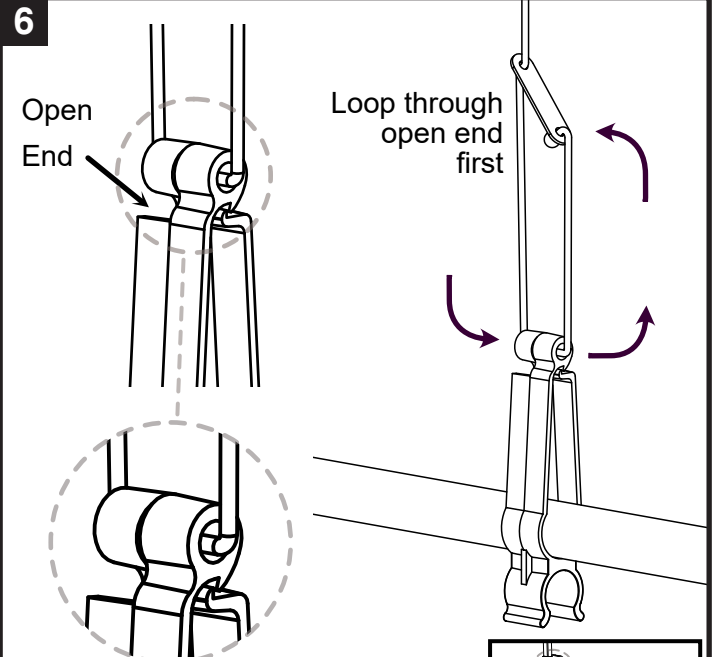

Open End

Loop through open end first

7

Raise lines to 121 cm / 48 in

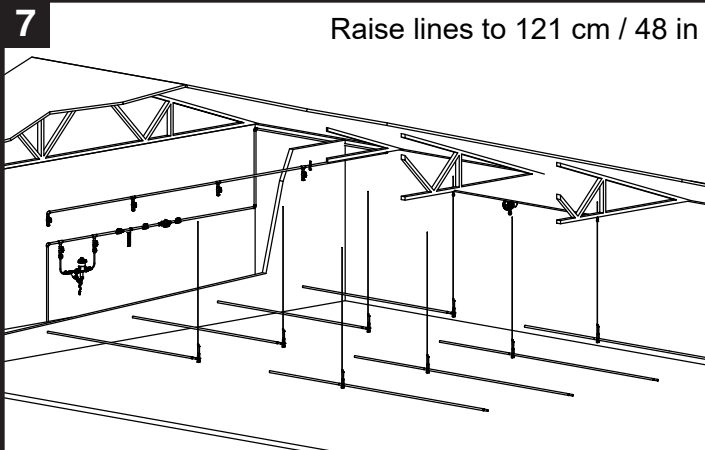

Note Very Important: When installing slope neutralizers, cable clamps must be installed at all systems hangers in place of sliding cord or cable adjusters.

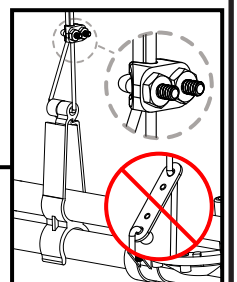

NUVO™ REGULATOR AND RISER ASSEMBLY

1

REGULATOR ASSEMBLY

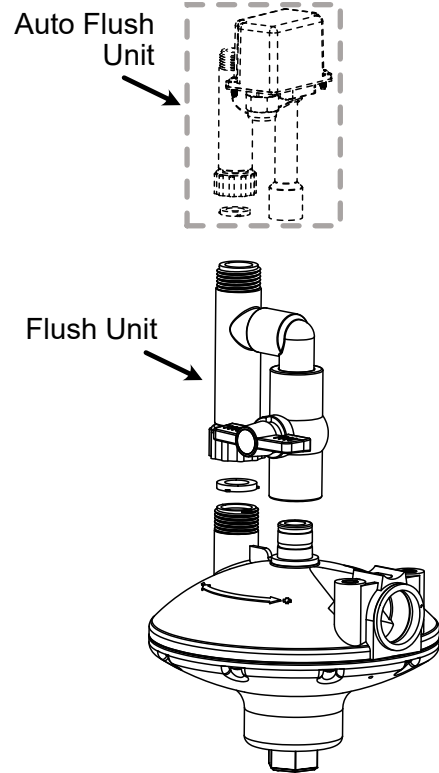

2

ENDLINE FLEX RISER ASSEMBLY

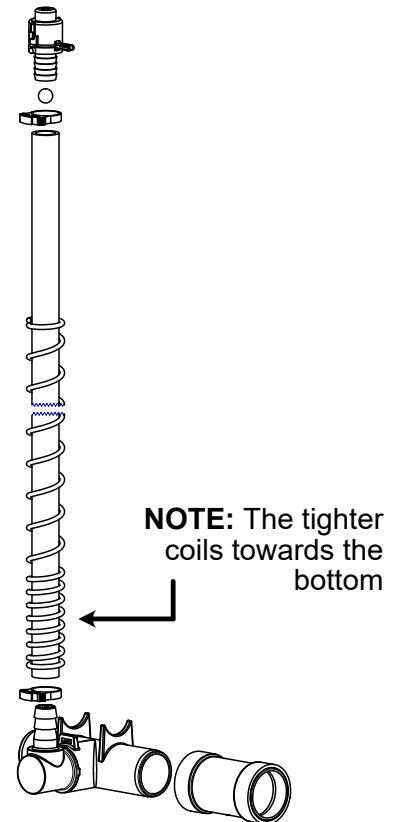

4

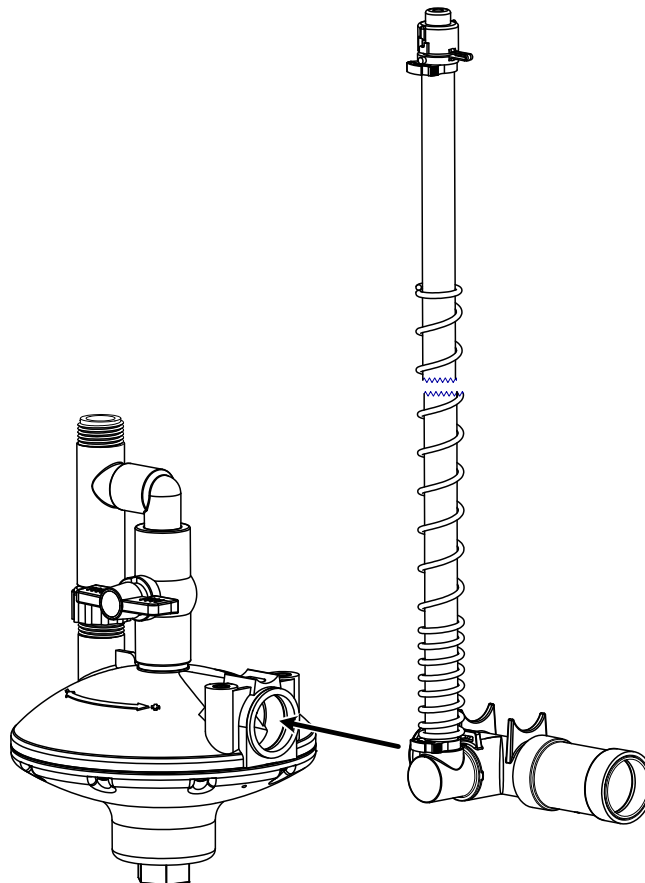

REGULATOR AND PVC SYSTEM

1

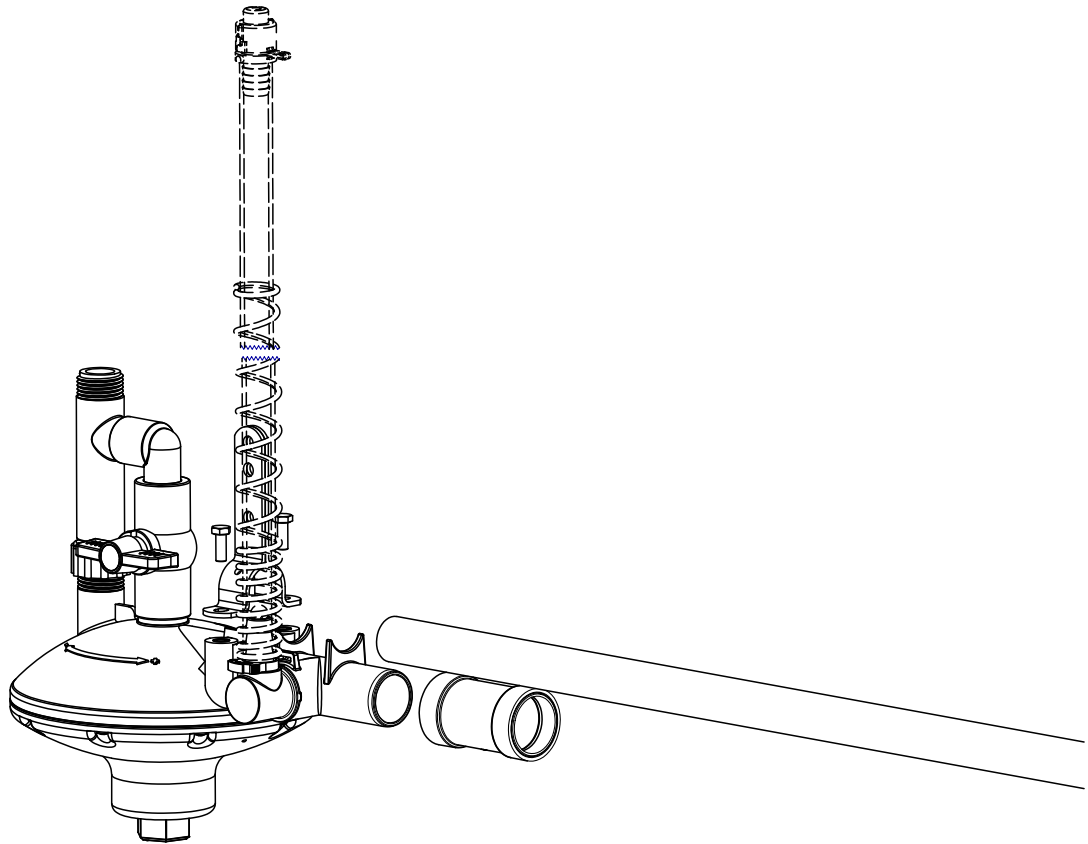

2

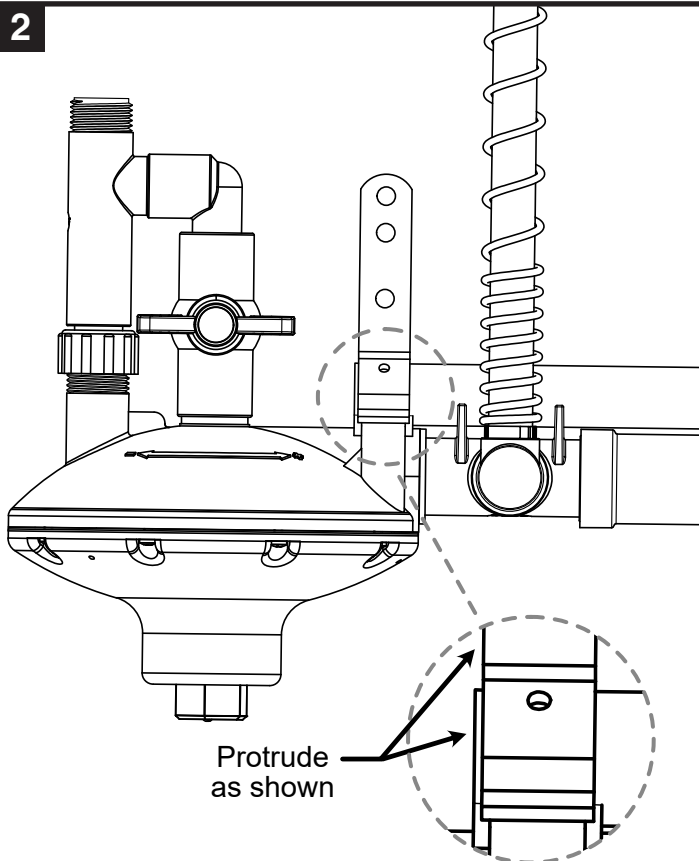

3

Install PN 3894 first (1).
Install PN 3895 over PN 3894 (2).
Install self-tapping screws.

*Riser tube not shown

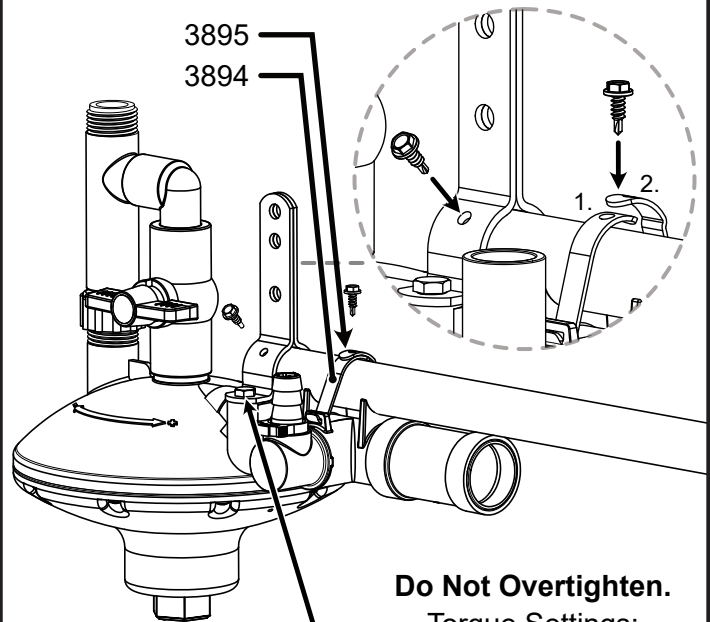

Do Not Overtighten.
Torque Settings:
1.7 Nm / 15 in lbs MAX.

Important: PN 3895 must go on top PN 3894.

CLIP-ON SADDLE ASSEMBLY

1

Saddle: Clip-On
Big Z Extended

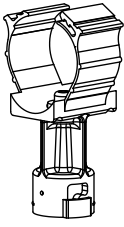

Saddle: Clip-On
Big Z Flex

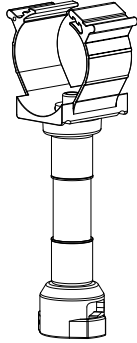

2

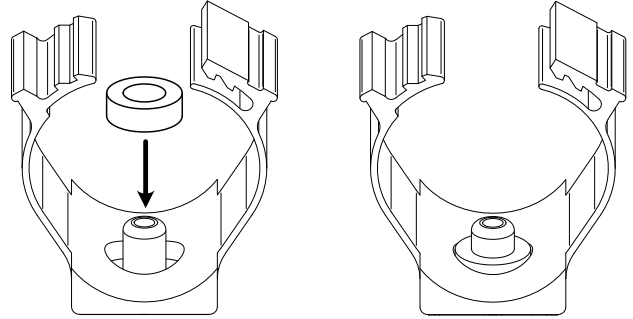

Install the grommet onto the saddle

3

Clip-On
Saddle

Water Pipe

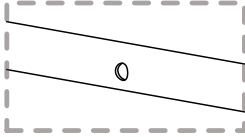

Position clip-on saddle onto water pipe

4

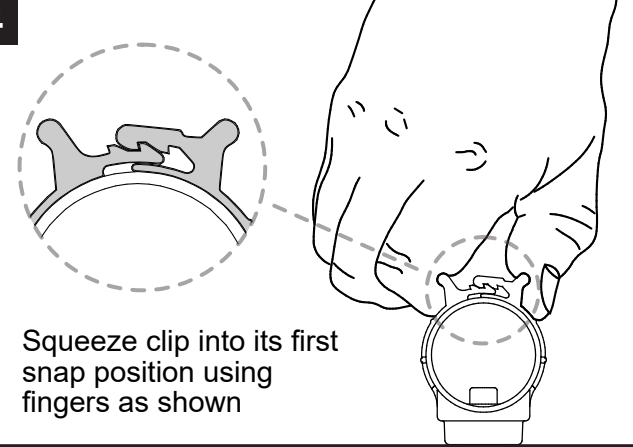

Squeeze clip into its first
snap position using
fingers as shown

5

Use PN 3817 or PN 3832 to complete this step of the installation.

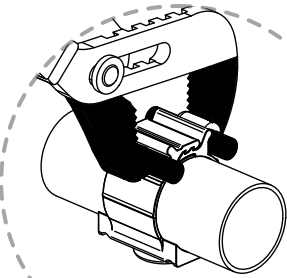

Center PN 3817 on the
clip-on saddle as shown.

PN 3817

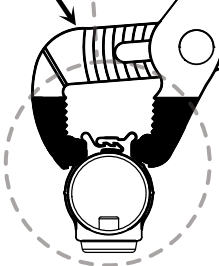

Use PN 3817 to squeeze the clip
until the second snap is engaged.

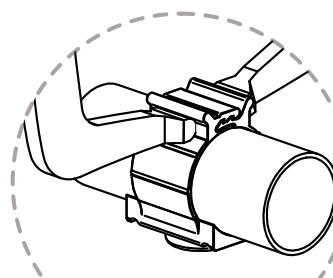

Center tool on the clip-on
saddle as shown.

PN 3832

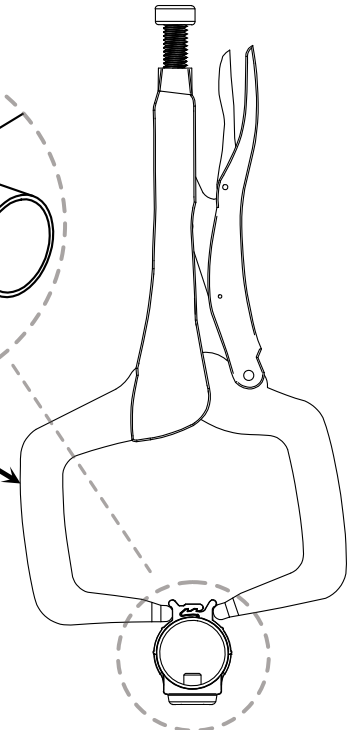

Use large vice-grip plier clamps
(PN 3832 shown) to squeeze the
clip until the second snap is
engaged.

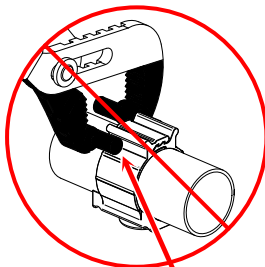

DO NOT offset the tool to
one side. This will cause
damage and product to fail.

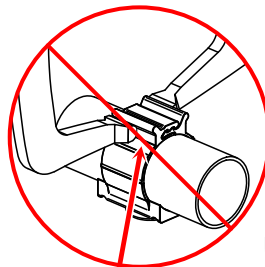

CLIP-ON BRACKET ORIENTATION

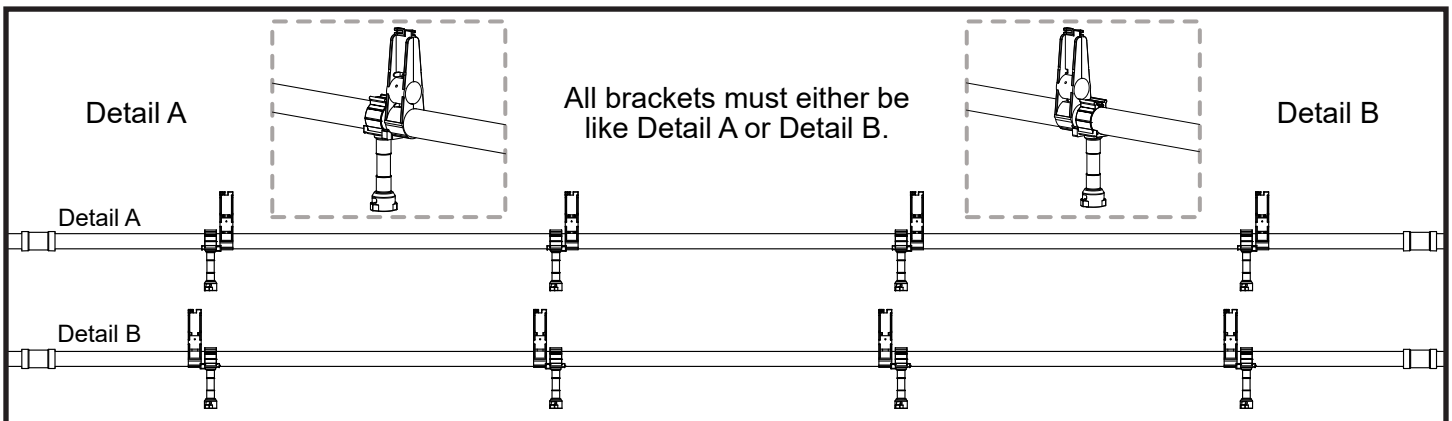
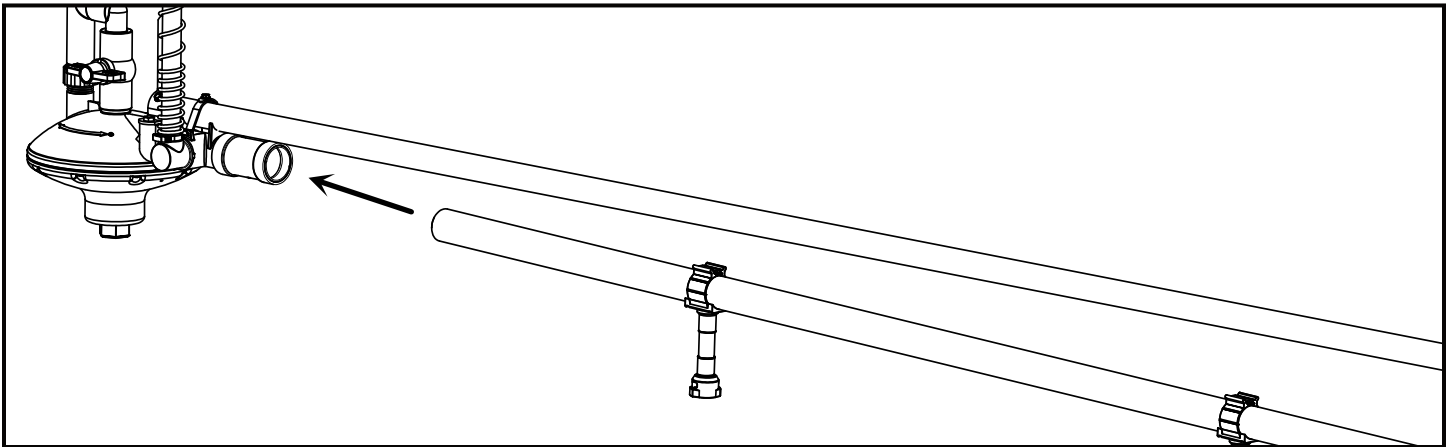
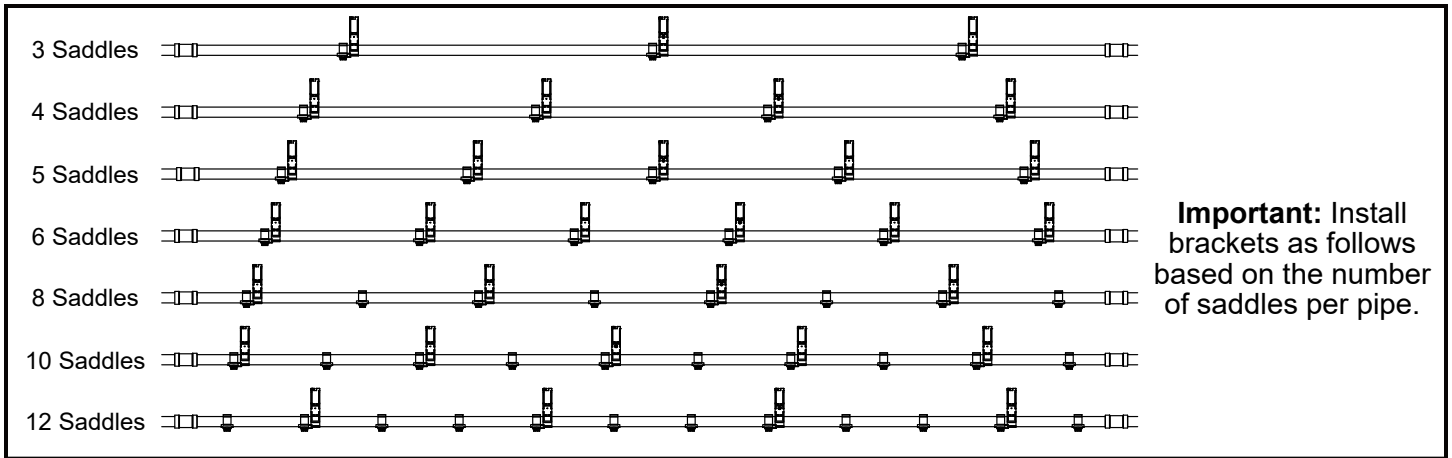

CLIP-ON BRACKET

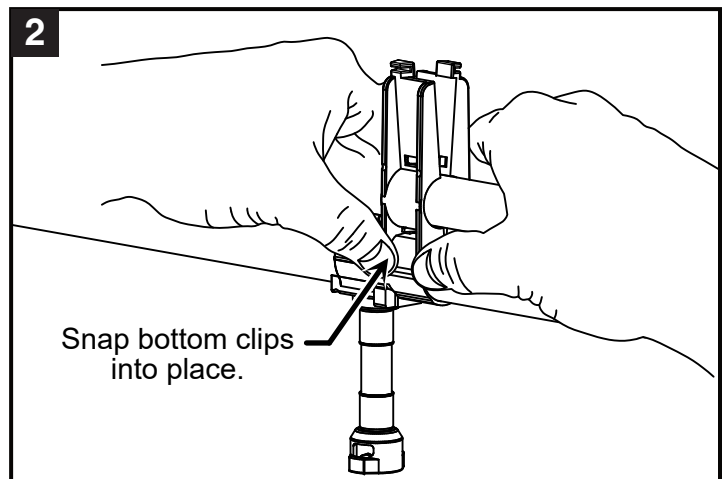
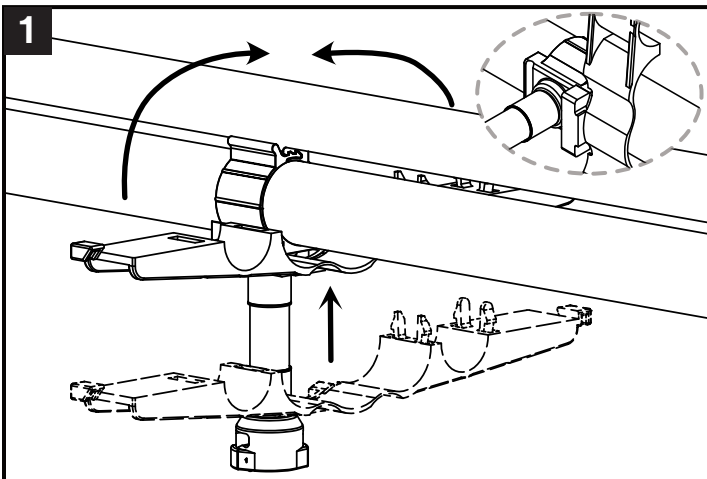

CLIP-ON BRACKET

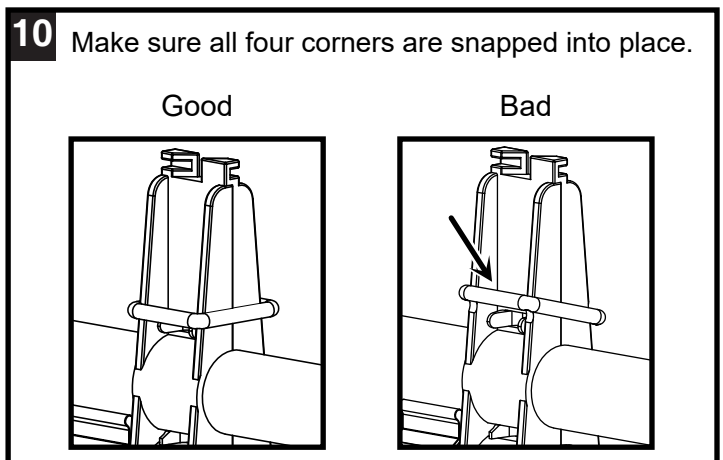
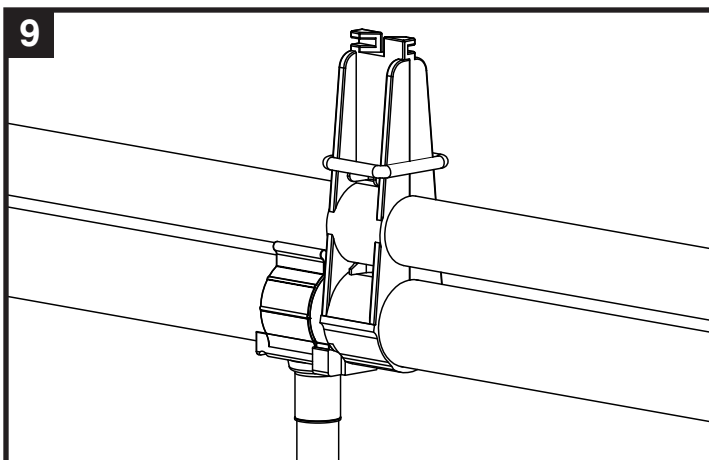
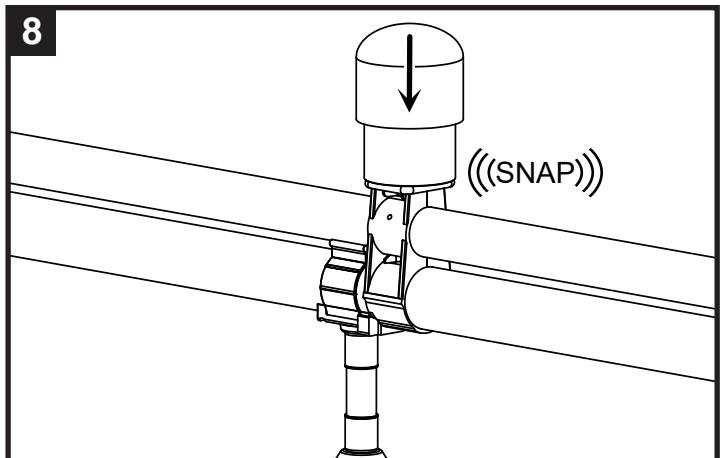
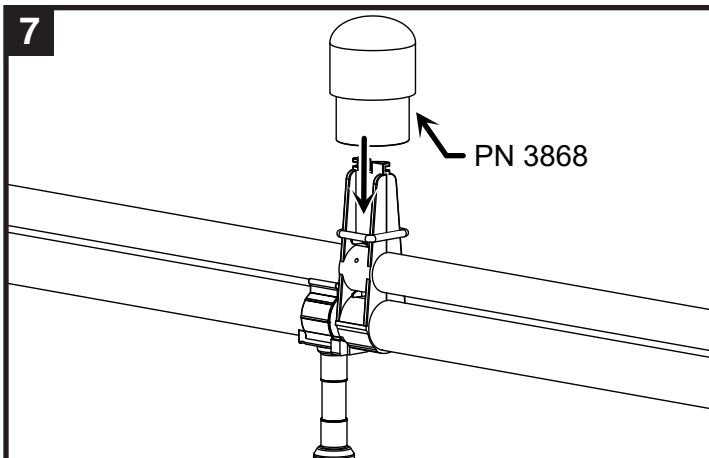
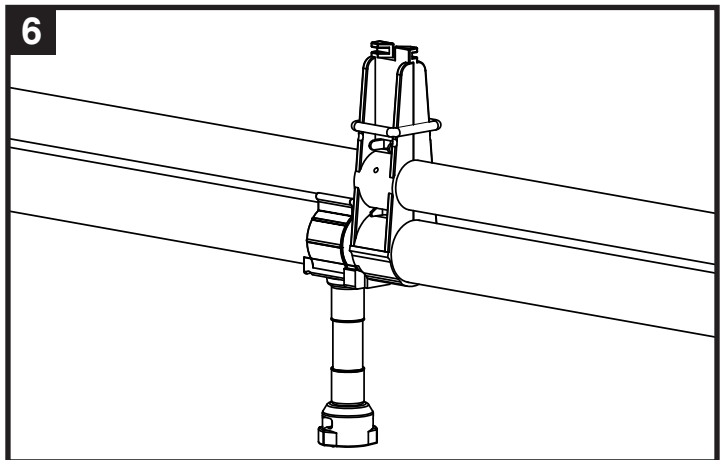
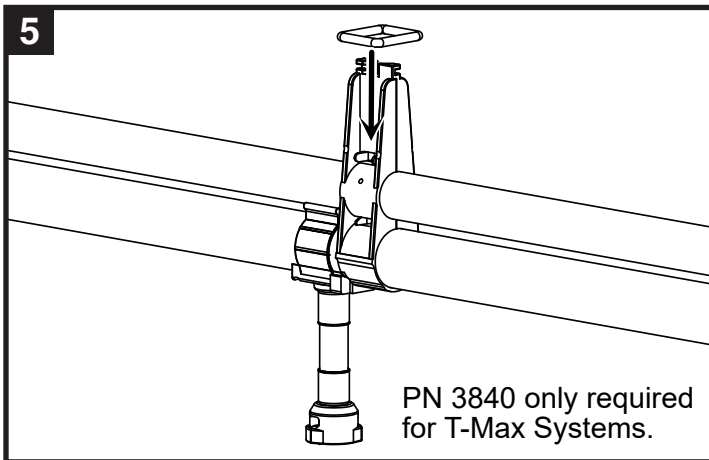
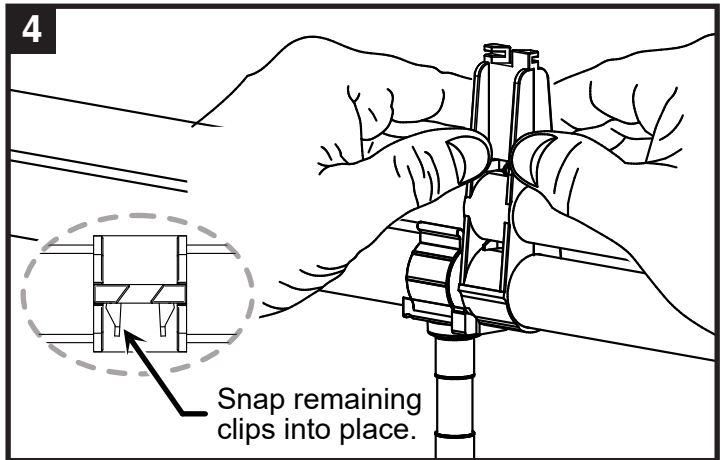
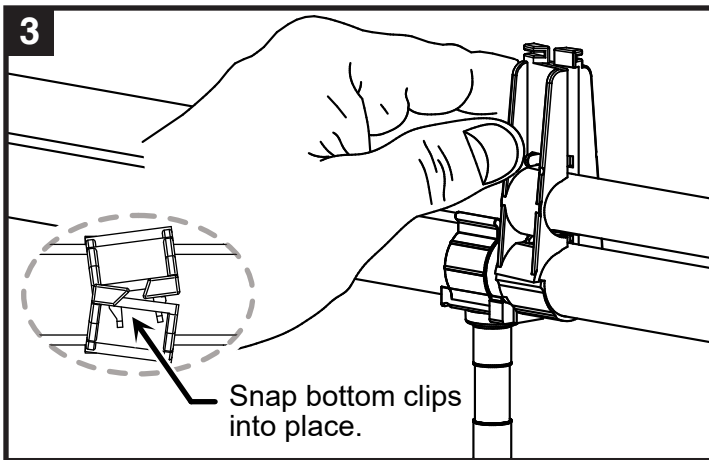

PIPE GAPPING WITH INK MARK ON END OF PIPE

WARNING: All Ziggity pipes must be installed in the manner shown in order to accommodate pipe expansion and contractions as a result of temperature changes. Failure to do so will cause pipe snaking or separation.

1

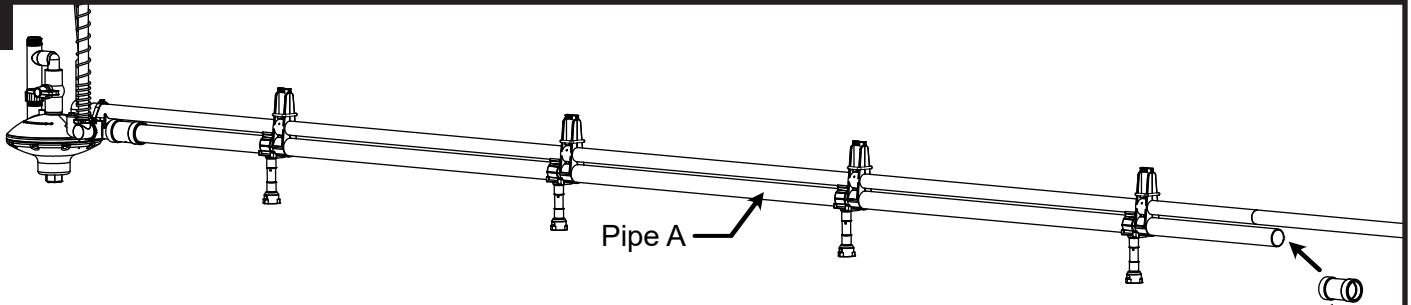

With Pipe A affixed to the support pipe, install the Pipe Connector all the way against Pipe A.

Pipe Connector

2

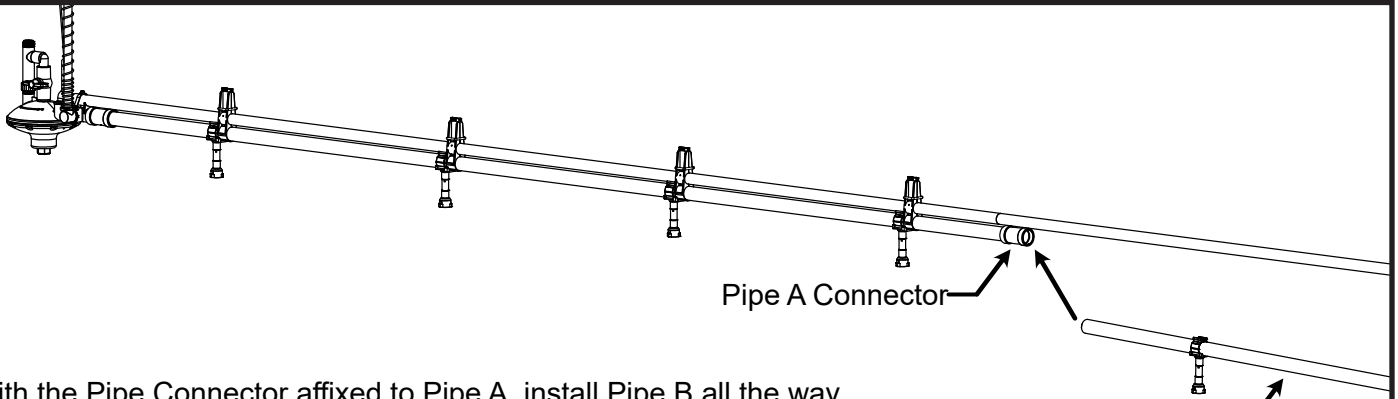

With the Pipe Connector affixed to Pipe A, install Pipe B all the way against the stop on the inside of the pipe connector.

Pipe B

3

Slide Pipe B into Pipe A Connector and align mark with the edge of Pipe A Connector accordingly.

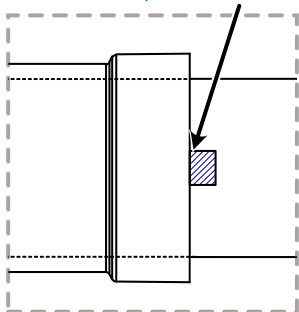
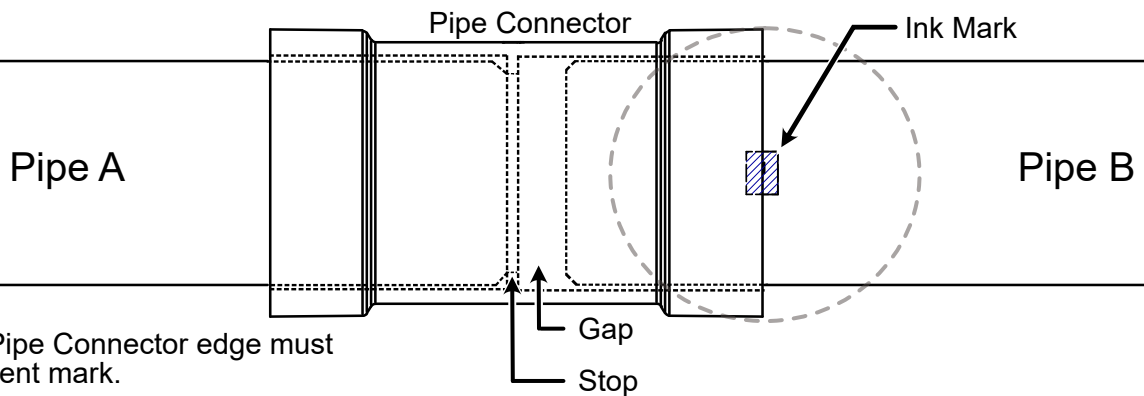

Good

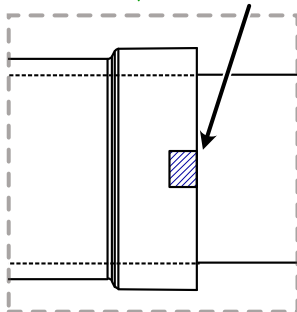

Good

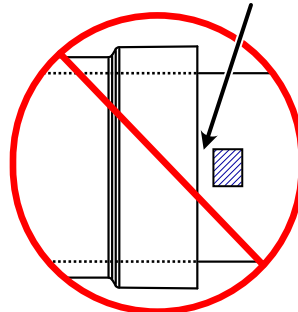

Bad

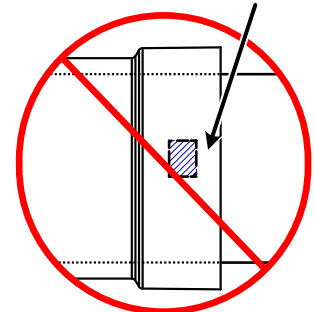

Bad

PIPE GAPPING WITHOUT INK MARK ON PIPE

WARNING: All Ziggity pipes must be installed in the manner shown in order to accommodate pipe expansion and contractions as a result of temperature changes. Failure to do so will cause pipe snaking or separation.

1

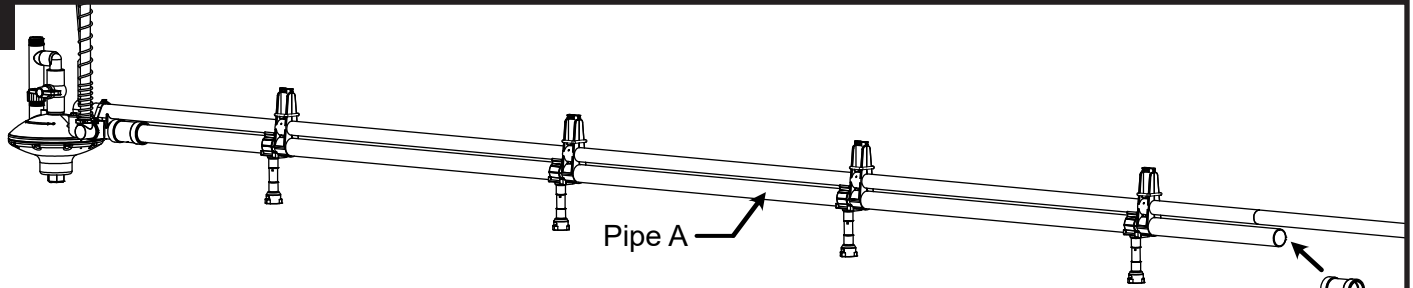

With Pipe A affixed to the support pipe, install the Pipe Connector all the way against Pipe A.

Pipe Connector

2

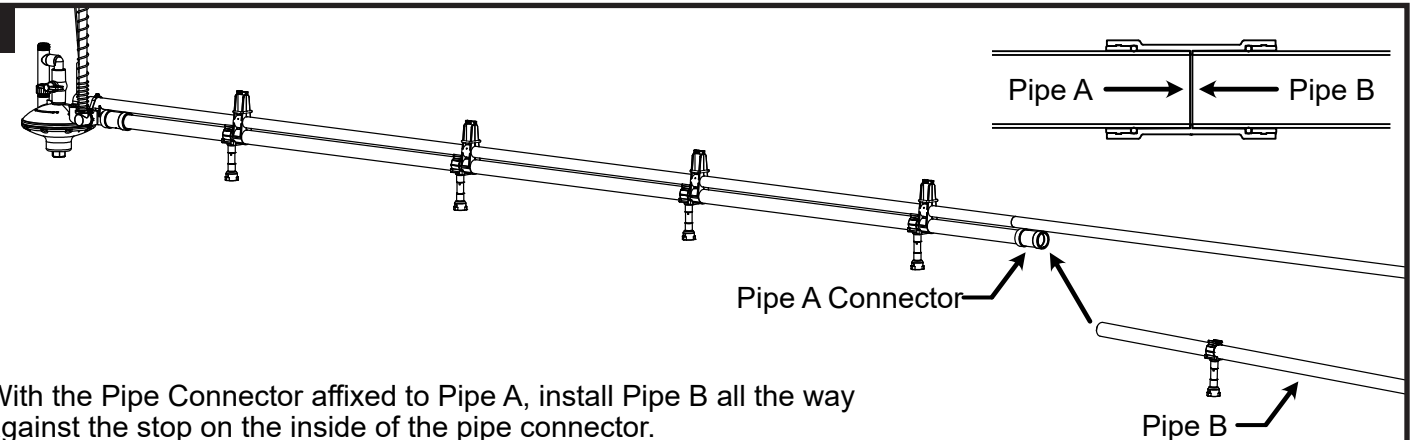

With the Pipe Connector affixed to Pipe A, install Pipe B all the way against the stop on the inside of the pipe connector.

3

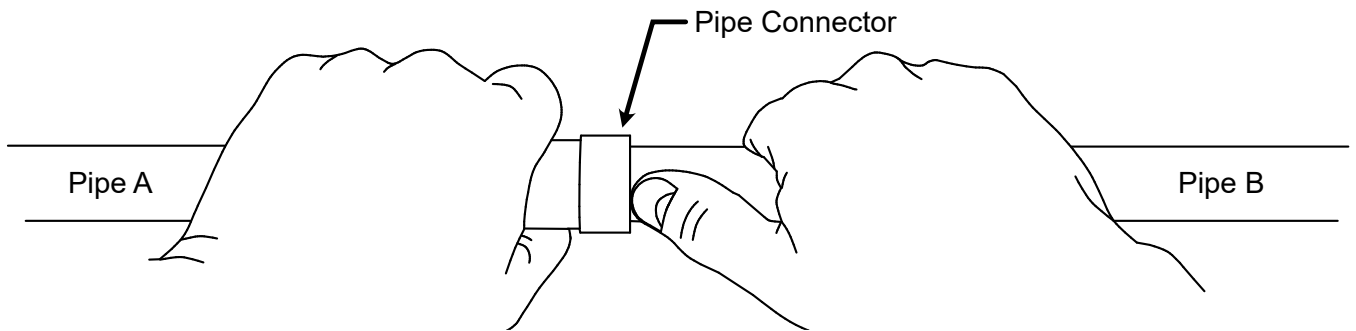

With both pipes inserted into the connector and up against the stop, place your thumb on the edge of the pipe connector as shown.

4

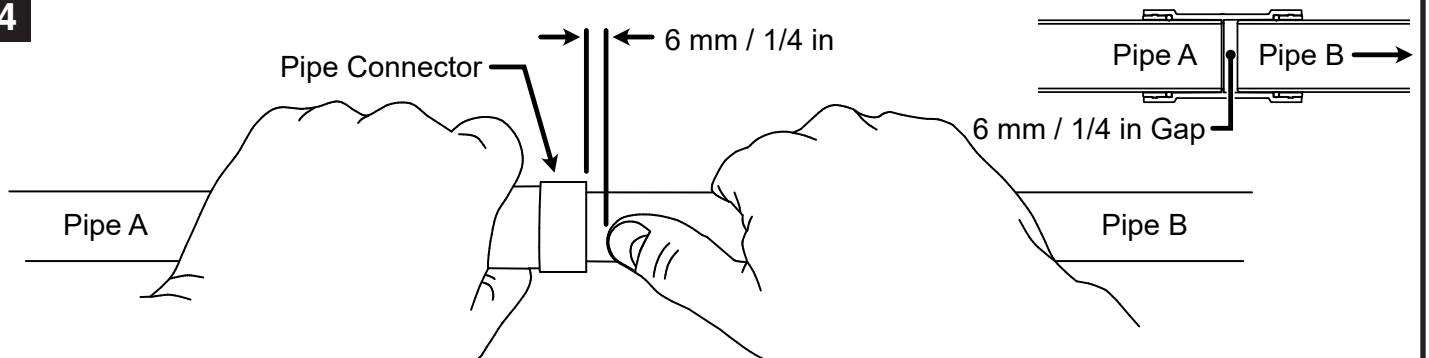

Hold Pipe A and the Pipe Connector securely. Pull Pipe B away from the connector approximately 6 mm / 1/4 in using your thumb as a guide. Repeat the process for each pipe connector.

PIPE CONNECTOR

5

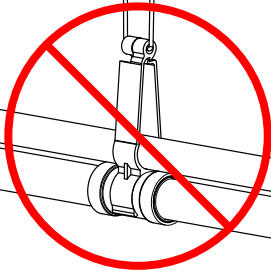

DO NOT install system hangers onto pipe connectors

6

Optional system hanger placement

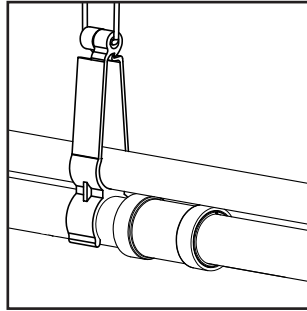

Option A

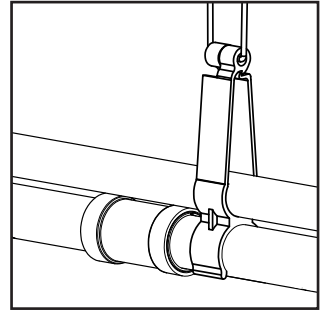

Option B

NUVO™ FLUSH END & RISER ASSEMBLY

1

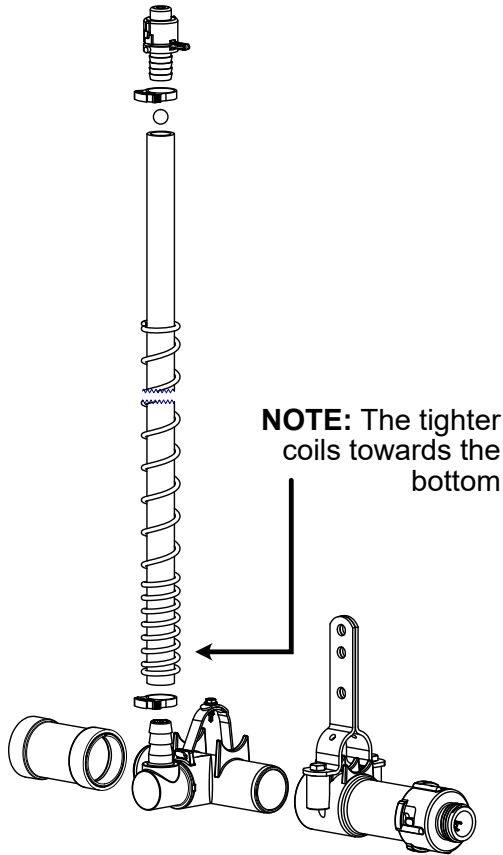

2

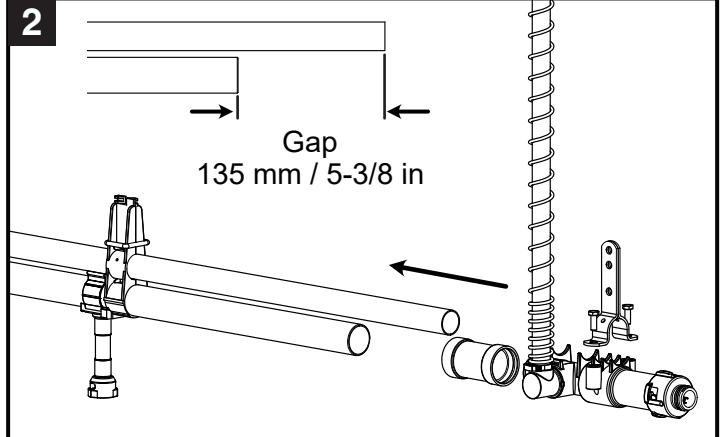

3

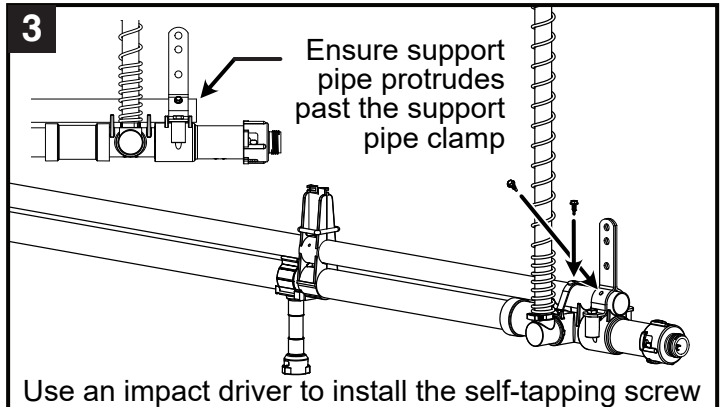

SCREW PLACEMENT FOR CLIP-ON BRACKETS

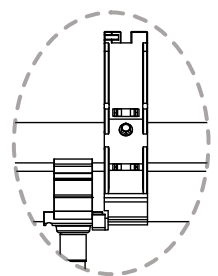
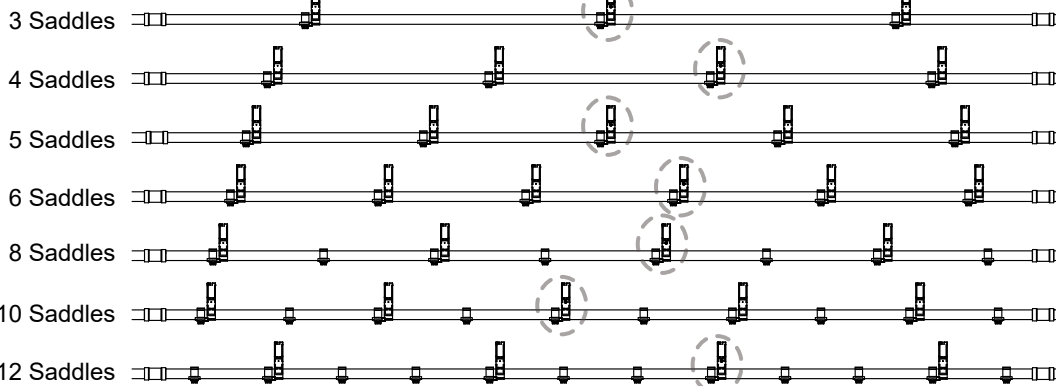

Denotes self tapping screw placement

Installation of screw at key locations prevents plastic pipe from migrating on support pipe.

CLIP-ON BRACKET SCREW

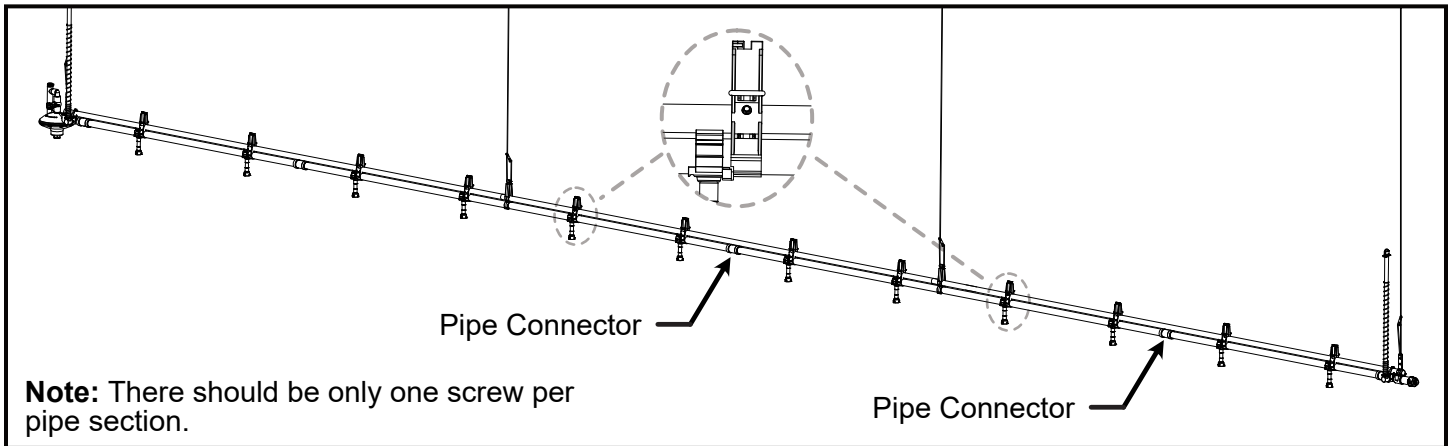
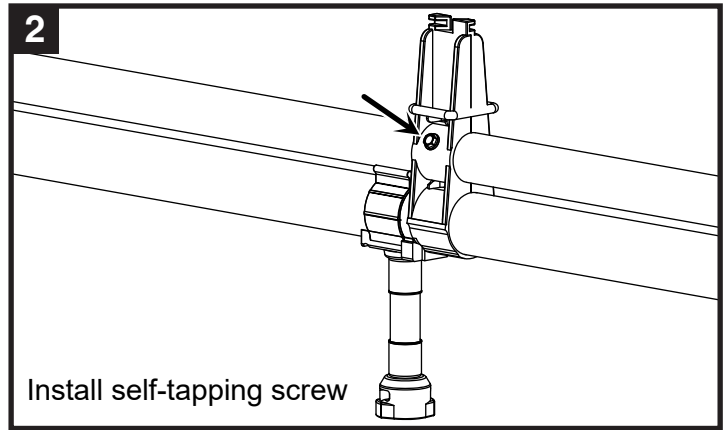
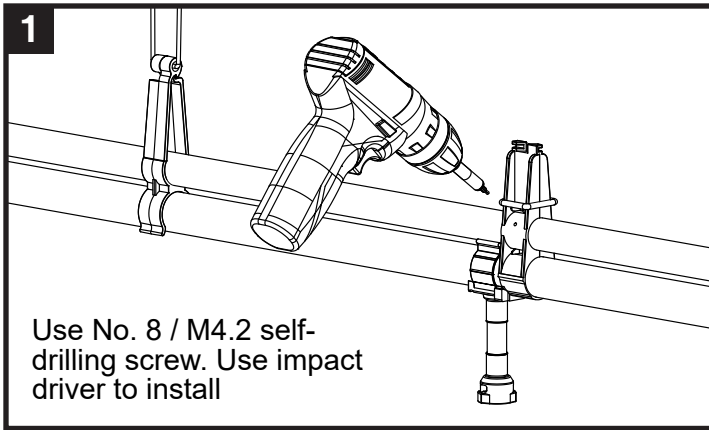

D-MAX DRINKER

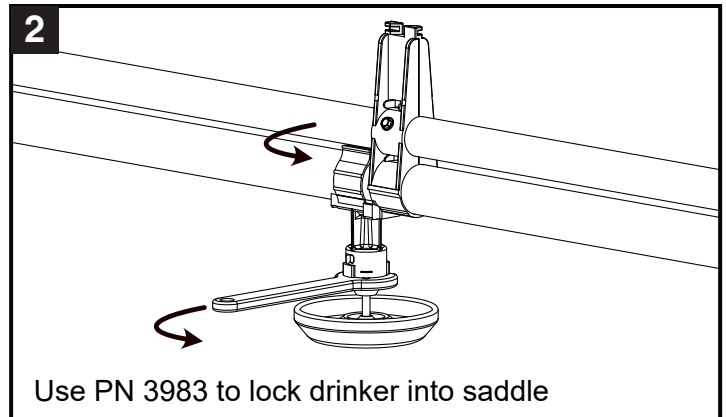
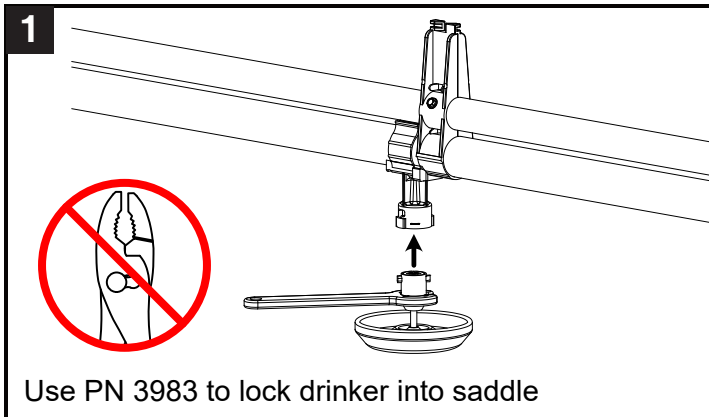

T-MAX DRINKER ASSEMBLY WITH CORDLESS DRILL AND NUTSETTER

1

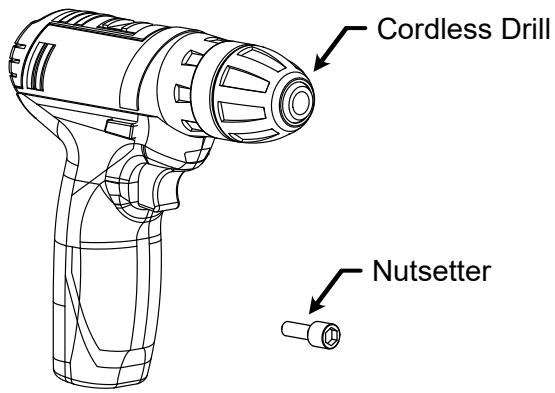

2

Use Nutsetter PN 2998 **ONLY!** Black in color.
DO NOT attempt to use any other nutsetter
other than the one noted above.

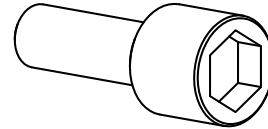

3

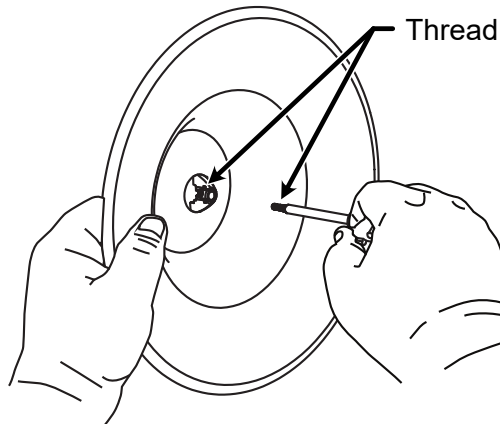

4

Thread on the Activator until it stops and cannot
be turned any farther.



5

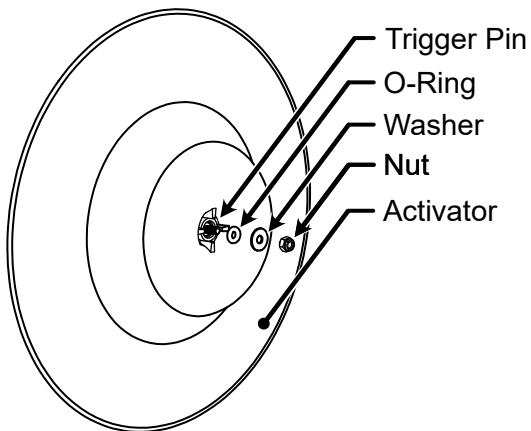

6

Use Nutsetter PN 2998 **ONLY!** Black in color.

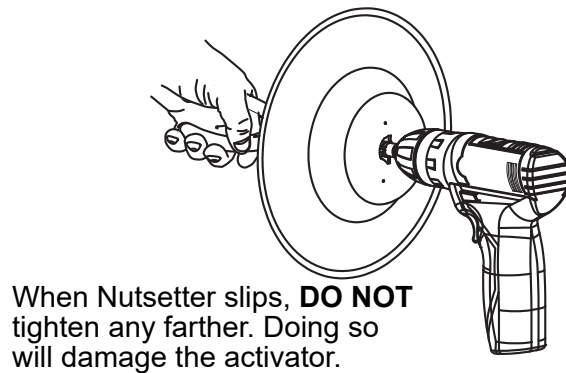

7

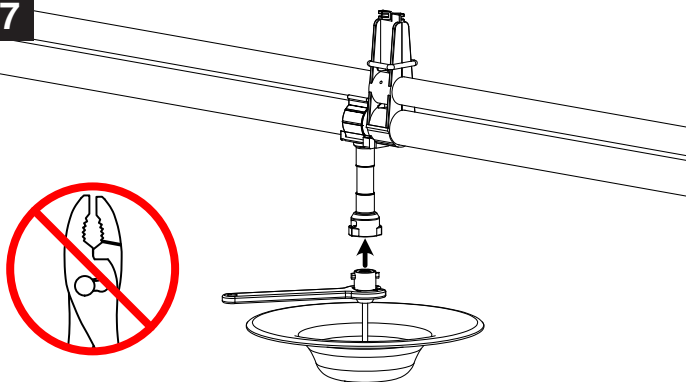

Use PN 3983 to lock drinker into saddle

8

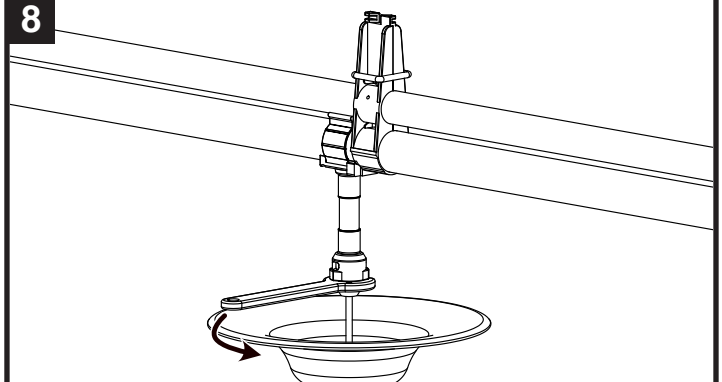

Use PN 3983 to lock drinker into saddle

T-MAX DRINKER ASSEMBLY AND INSTALLATION - HAND ASSEMBLY

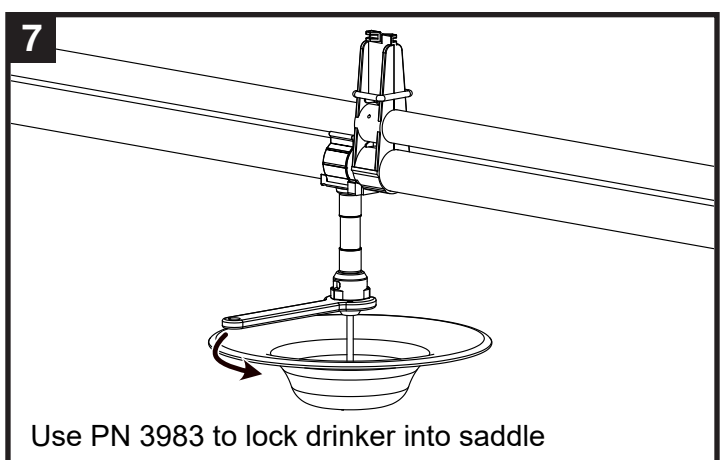
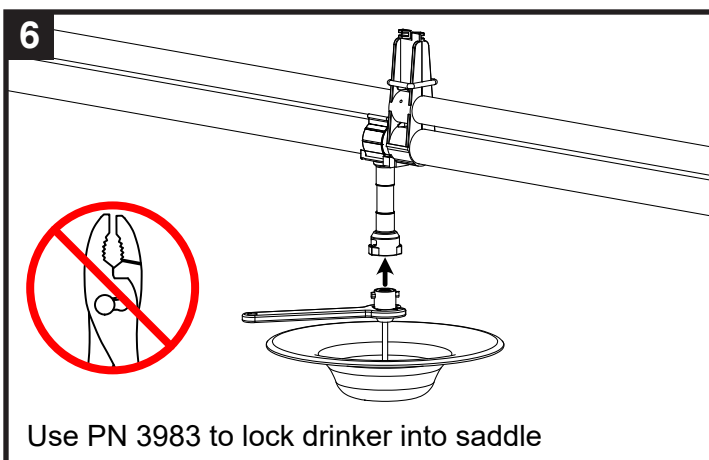
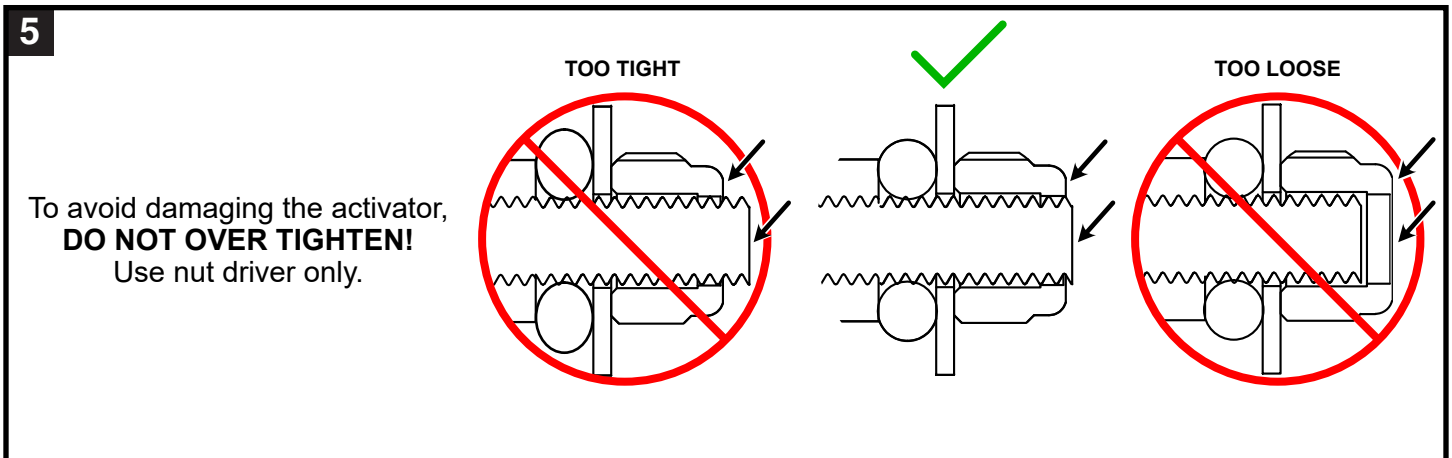
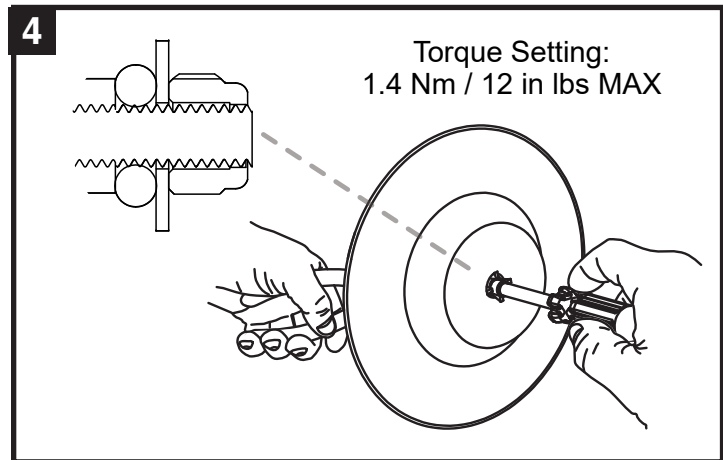
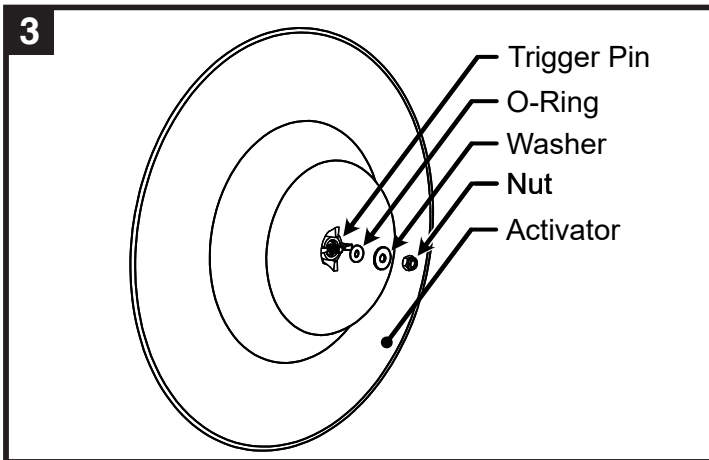
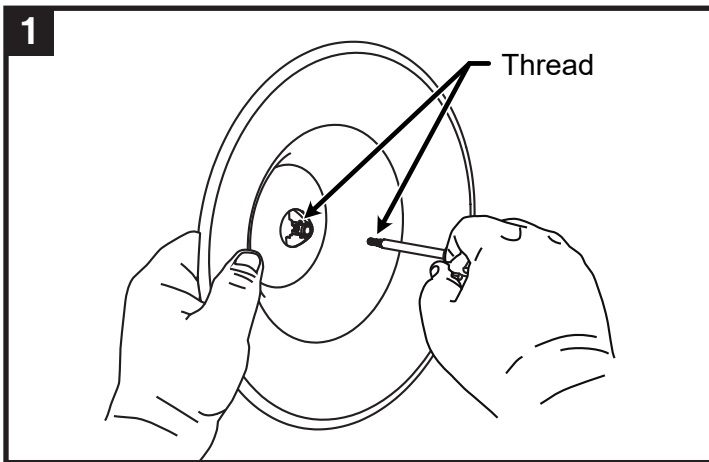

T-MAX TO FLEX SADDLE REINFORCEMENT ASSEMBLY

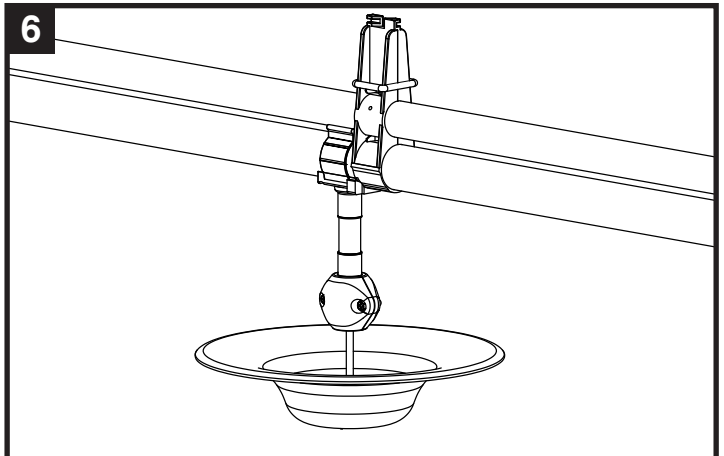
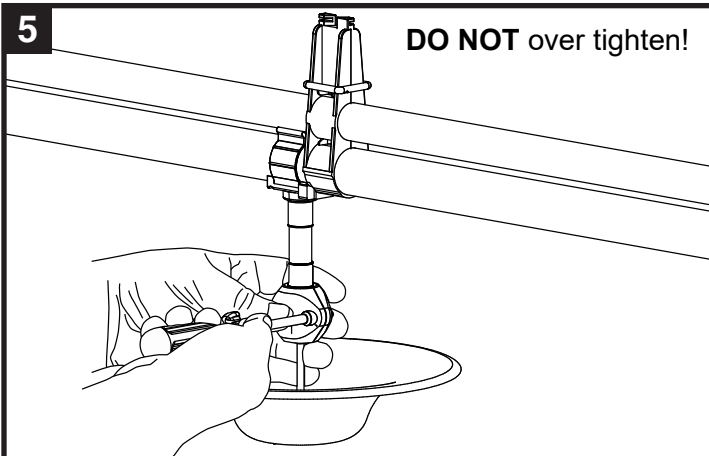
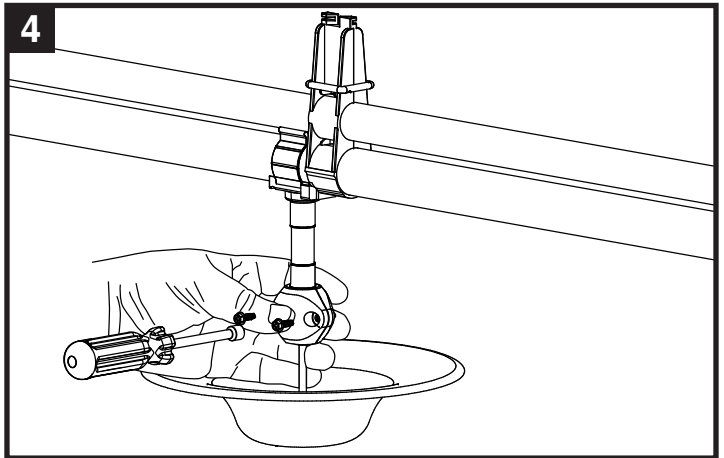
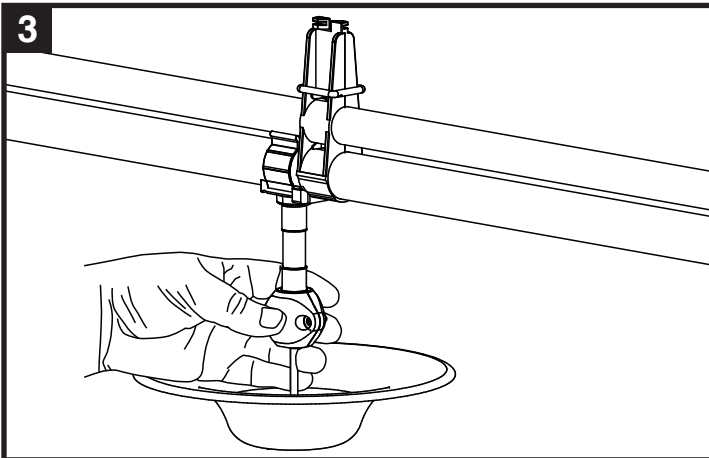
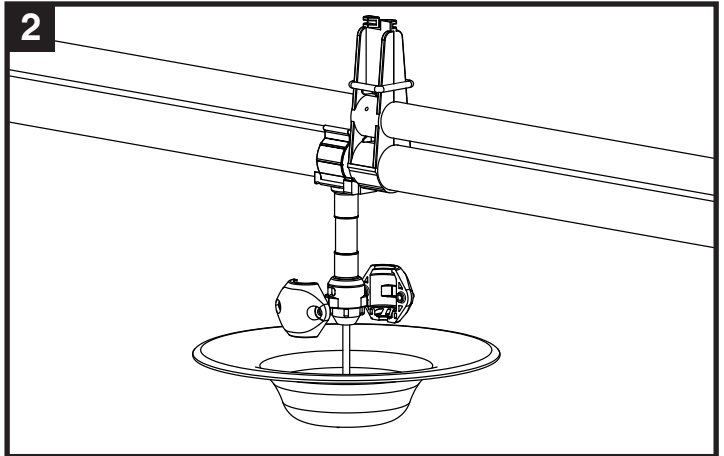
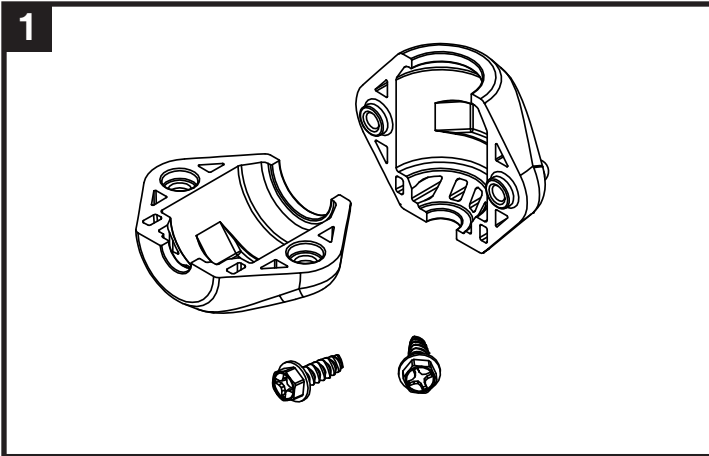

HEAVY DUTY ANTI-ROOST

1

PN 2970, Installation Assembly: Heavy Duty Anti-Roost - Base

NOTE: Please refer to part illustration for all items included in this assembly.

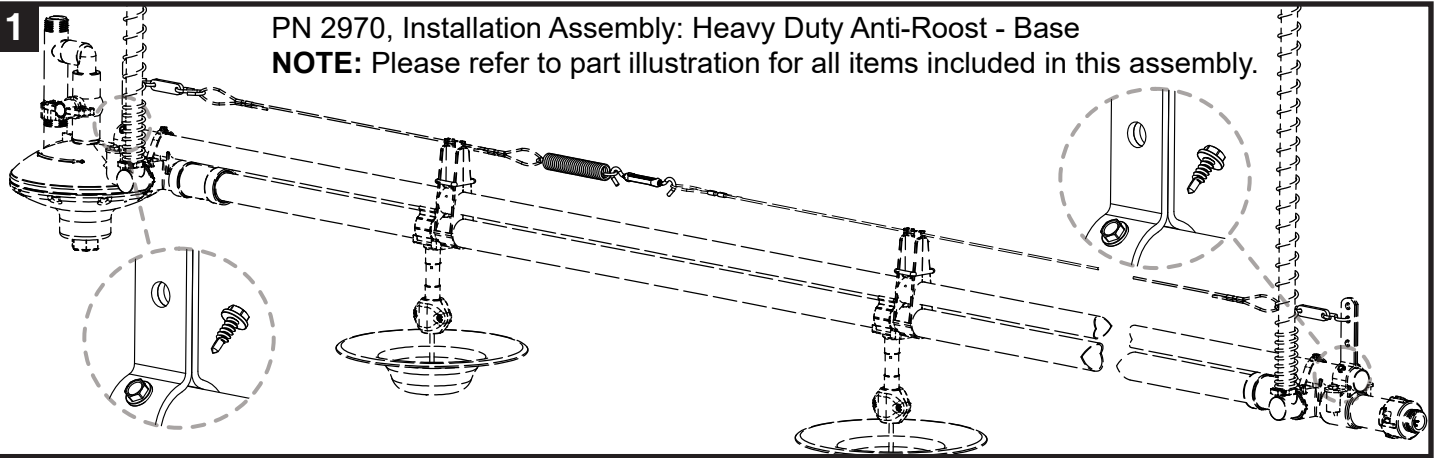

2

PN 2971, Installation Assembly: Heavy Duty Anti-Roost - Add-On

NOTE: Please refer to part illustration for all items included in this assembly.

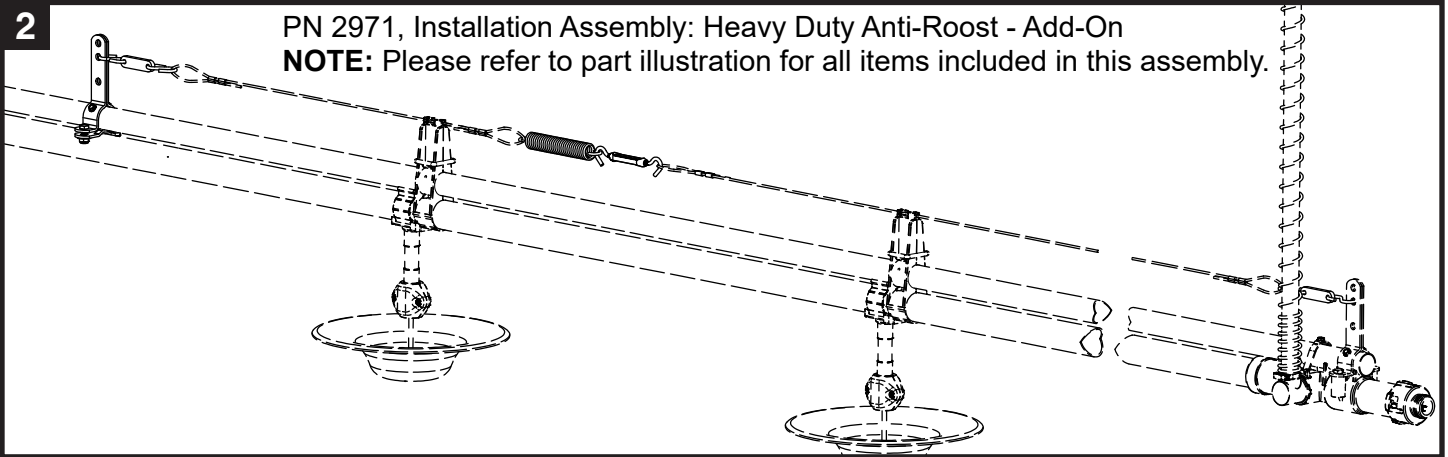

3

Drinker lines 76 m / 250 ft or shorter
use PN 2970

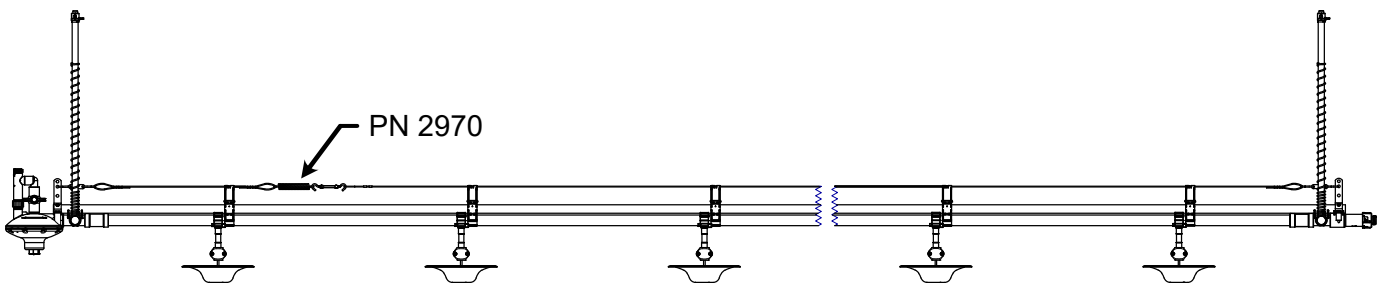

4

Drinker lines greater than 76 m / 250 ft but less than 152 m / 500 ft
use PN 2970 and PN 2971

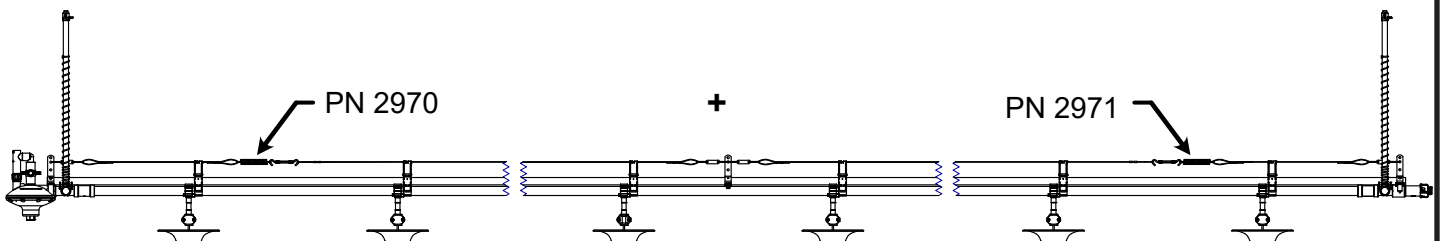

HEAVY DUTY ANTI-ROOST

5

Drinker lines greater than 152 m / 500 ft but less than 228 m / 750
use PN 2970 and 2 X PN 2971 (Continue adding 1 PN 2971 for every 75 m / 250 ft.)

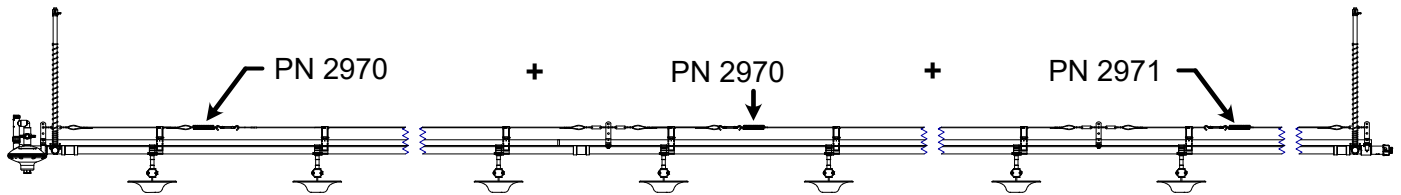

PN 2970

1 Heavy Duty Cable Loop - Created on site from PN 2524 / 2525 cable. You will need one for PN 2970 base kit. See below for the estimated length of the cable loop based on the saddle spacing of your system. Use 2.4 mm / 3/32 in 1 X 7 galvanized cable.

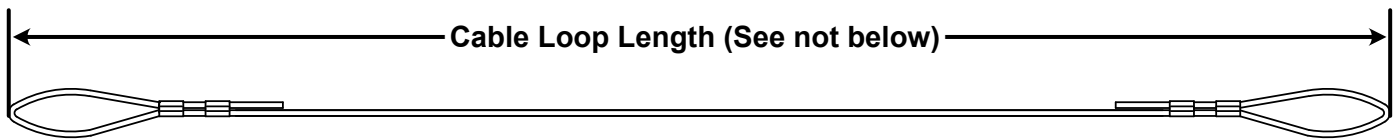

5 Saddles / Pipe - **38 cm / 15 in long** cable loop
4 and 3 Saddles / Pipe - **61 cm / 24 in long** cable loop

2

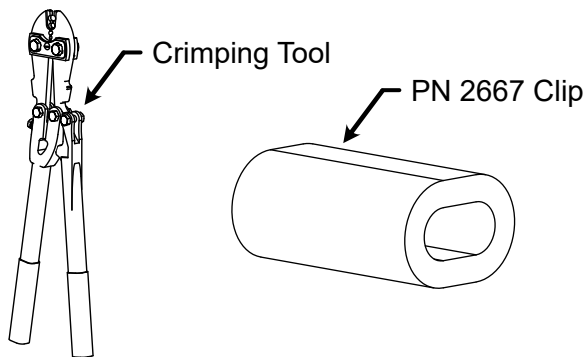

Always use the proper crimping tool to crimp the clip.
For example Ziggity's PN 2487.

3

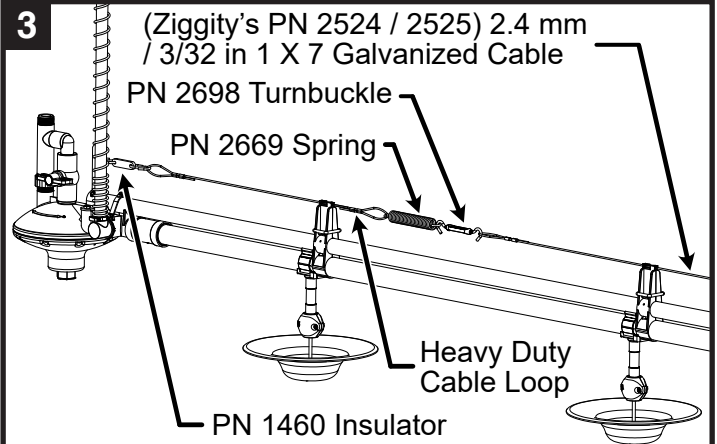

4

Pull the cable taut and attach it to the end assembly with the insulator.

*Riser Tube not shown in detail

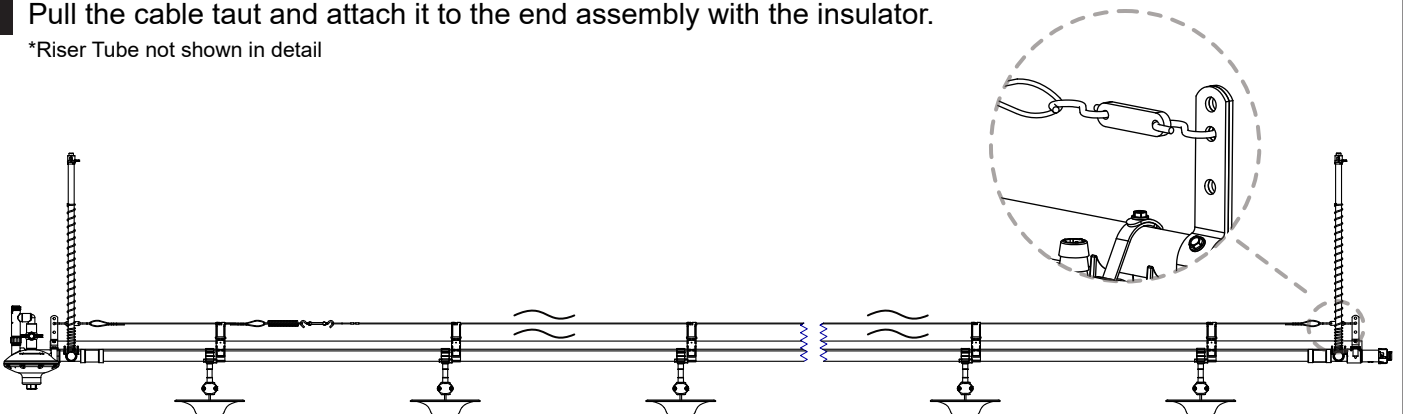

PN 2970

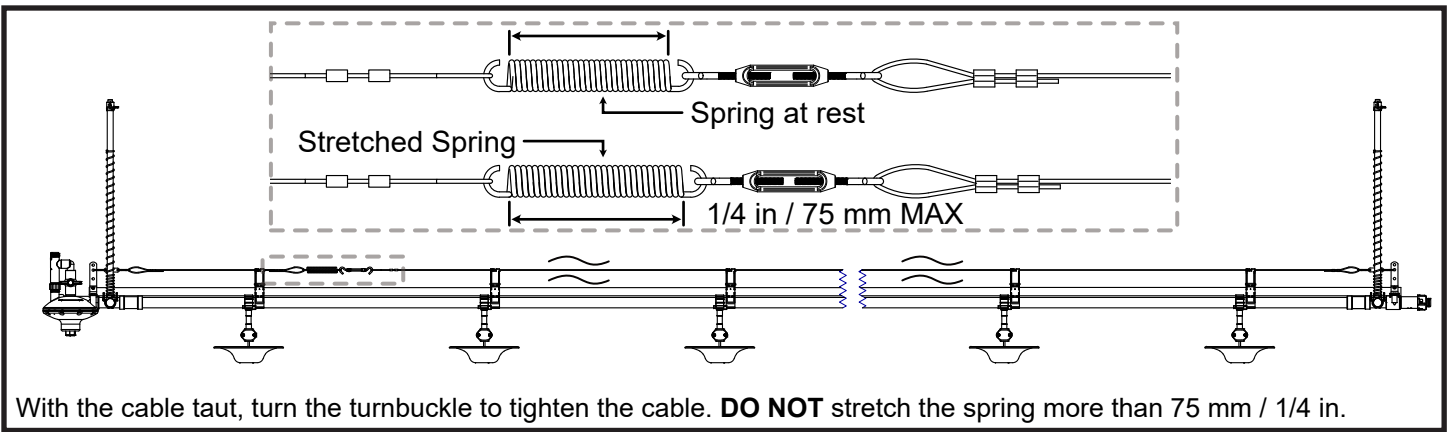

PN 2971

- 1** Heavy Duty Cable Loop - Created on site from PN 2524 / 2525 cable. You will need one for PN 2970 base and one for every PN 2971 add-on kit installed. See below for the estimated length of the cable loop based on the saddle spacing of your system. Use 2.4 mm / 3/32 in 1 X 7 galvanized cable.

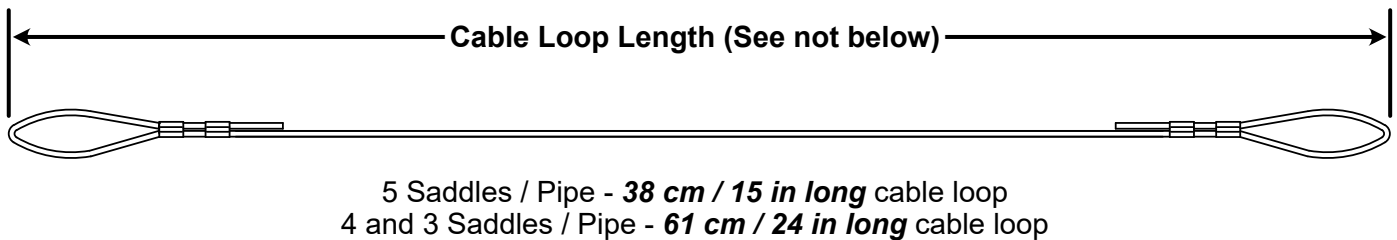

- 2**

Labels: "Crimping Tool", "PN 2667 Clip".

Always use the proper crimping tool to crimp the clip. For example Ziggity's PN 2487.

- 3**

Center bracket assembly between the two nearest drinkers where your measurement required an add-on kit installation. This will ensure that there is no interference with other components of the kit.

- 4**

Labels: "Cable Length: 106 m / 350 ft", "Cable Length: 53 m / 175 ft", "Cable Length: 53 m / 175 ft", "PN 2971 Inline Kit".

The diagram shows a cable line with a central add-on kit installation. The total length is 106 m / 350 ft, divided into two equal segments of 53 m / 175 ft on either side of the kit.

Example: If the system is 106m / 350 ft, one add-on kit is needed. Add-on kits should be installed in the center of the line.

PN 2971

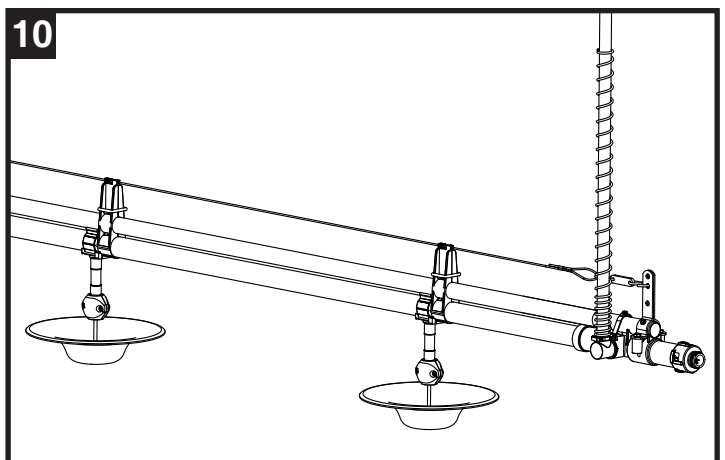
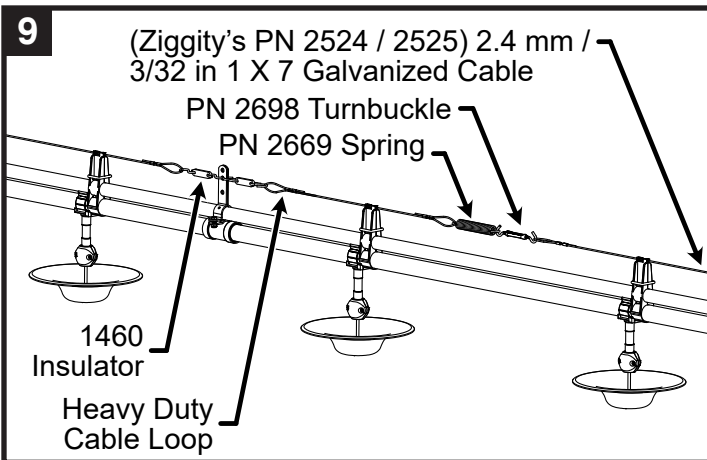
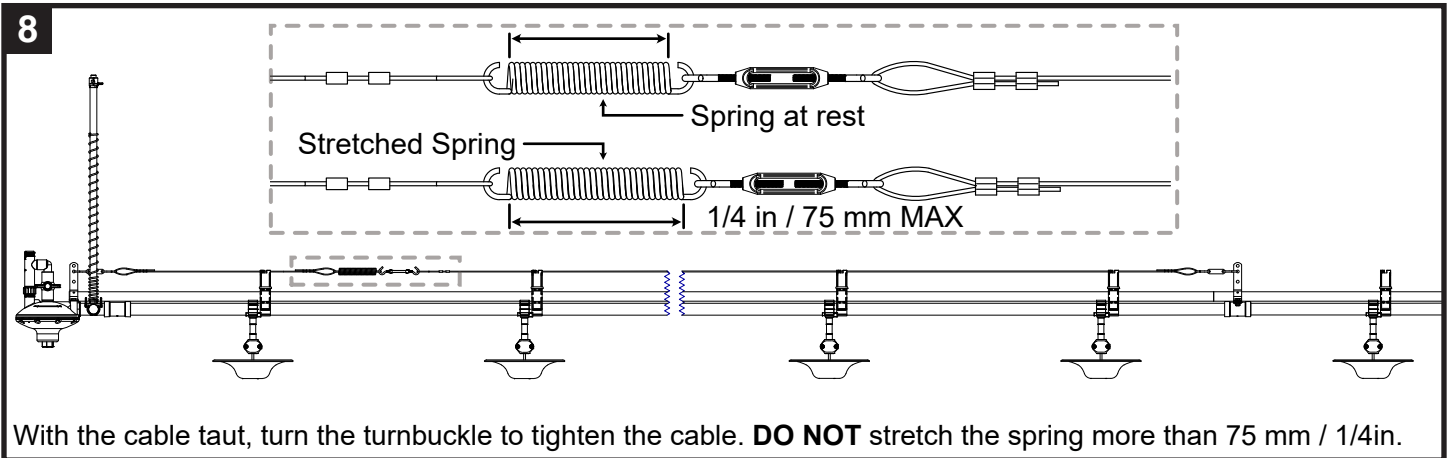
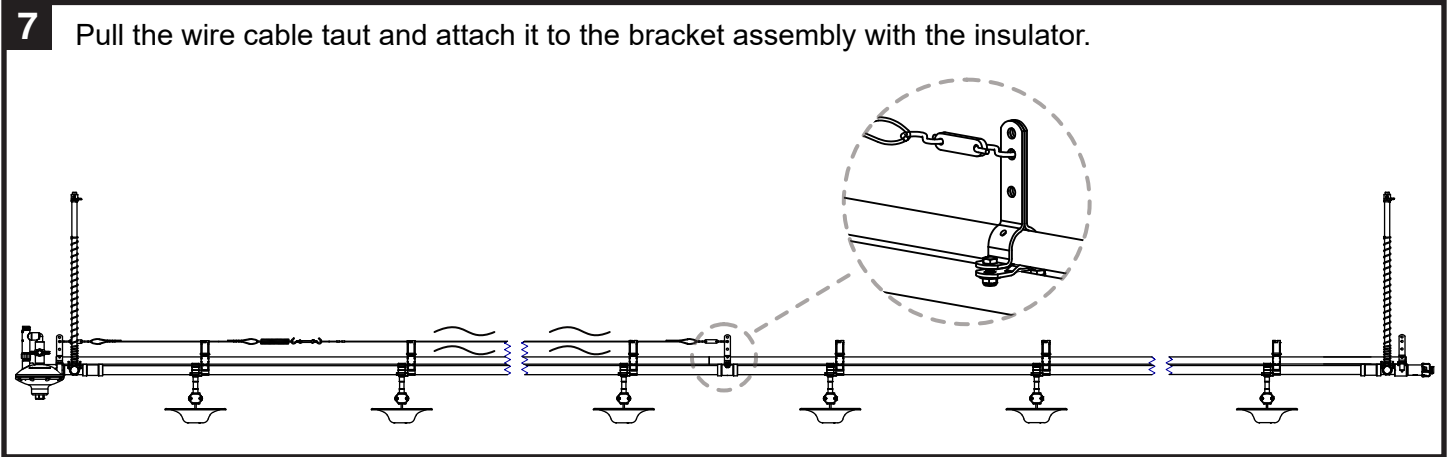
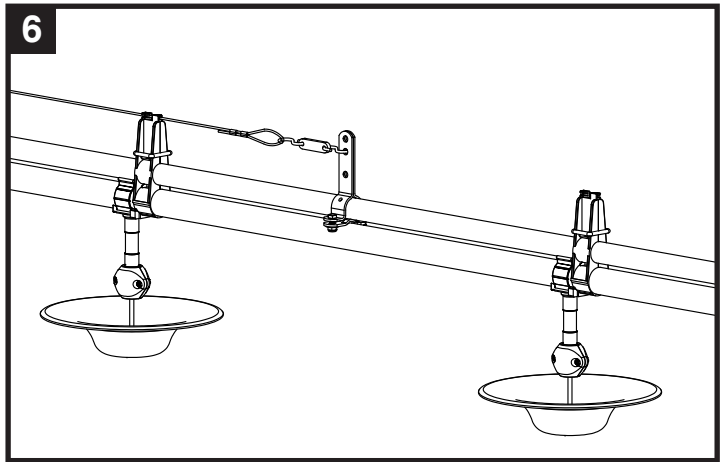
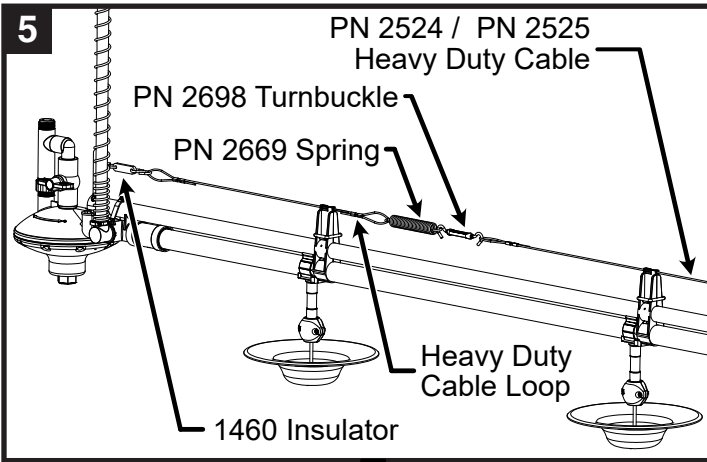

- 11** Pull the cable taut and attach it to the end assembly with the insulator.
 *Riser Tube not shown in detail

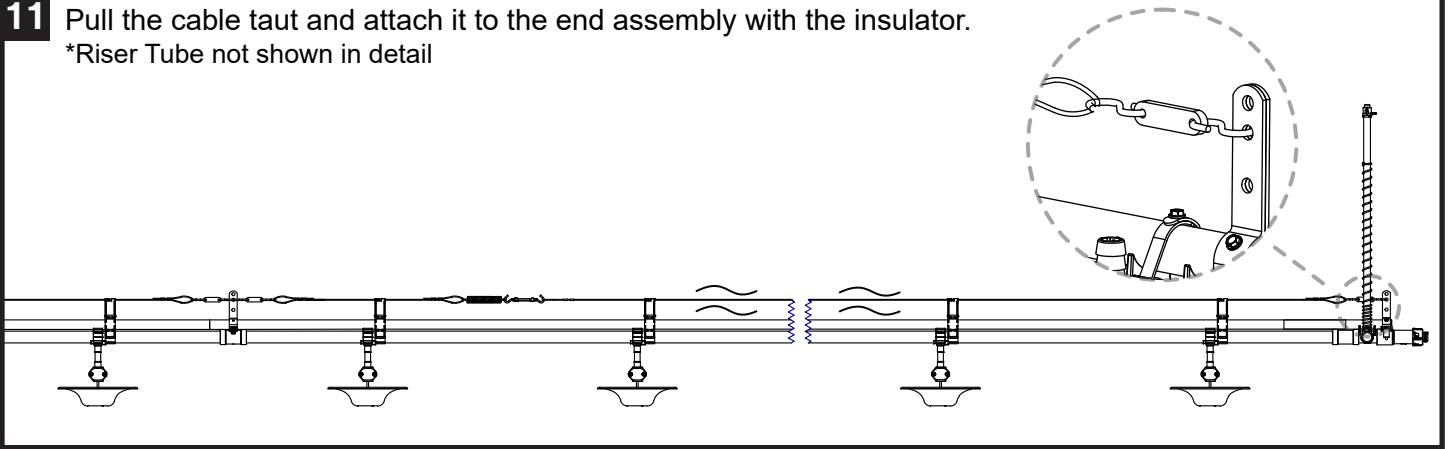

- 12**
-
- Stretched Spring
- Spring at rest
- 1/4 in / 75 mm MAX
- With the cable taut, turn the turnbuckle to tighten the cable. **DO NOT** stretch the spring more than 75 mm / 1/4in.

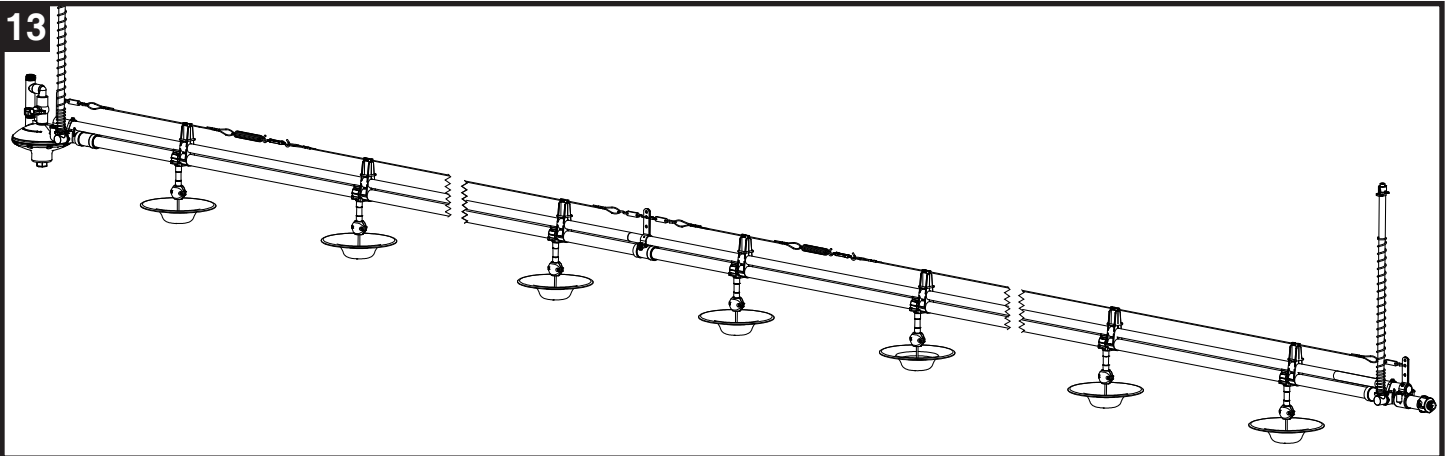

- 14**
-
- Anti-Roost Controller
- Ground
- Hot
- Insulated
- VERY IMPORTANT:** Line must be grounded.

- 15**
-
- Hot
- Ground
- VERY IMPORTANT:** Line must be grounded to Support Pipe.

PN 2971

16

Use an insulated wire to make a "jumper" wire to bypass the insulators. This is only needed when PN 2971 kit is installed. You will need to do this at every add-on kit.

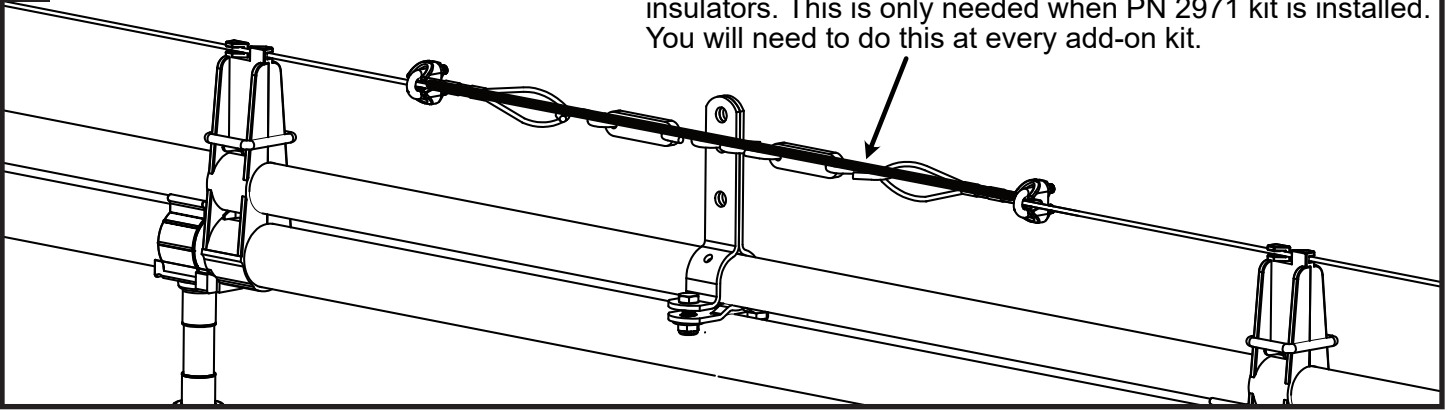

DRAIN HOSE

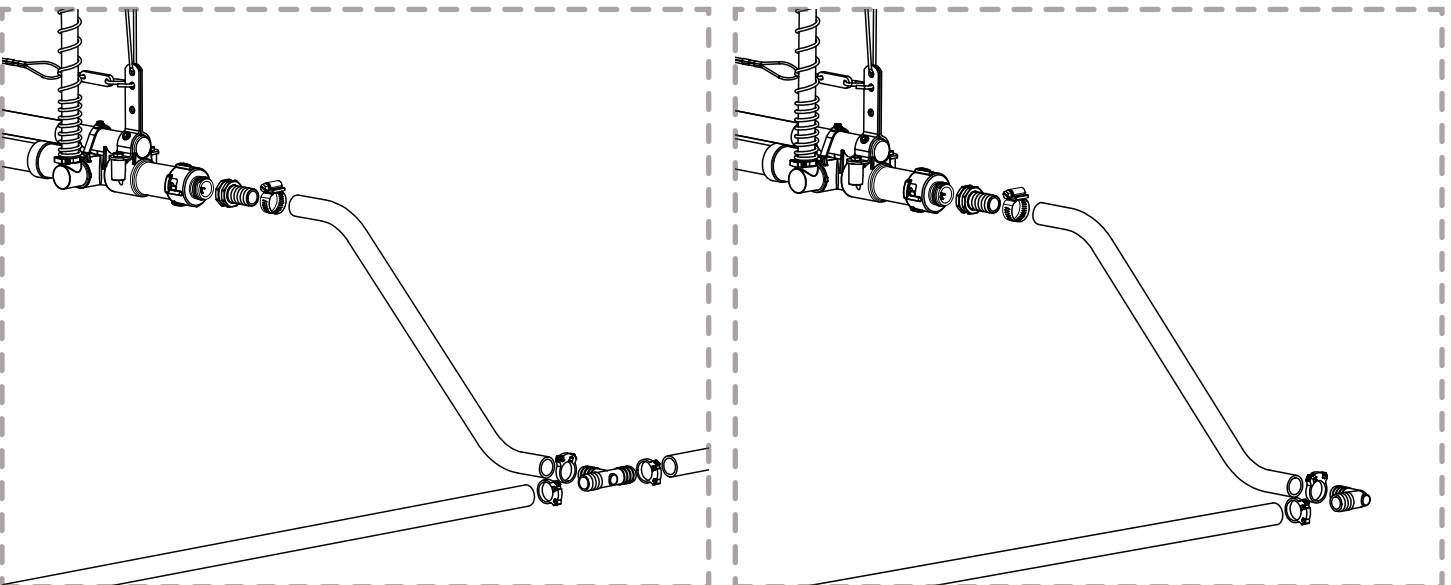
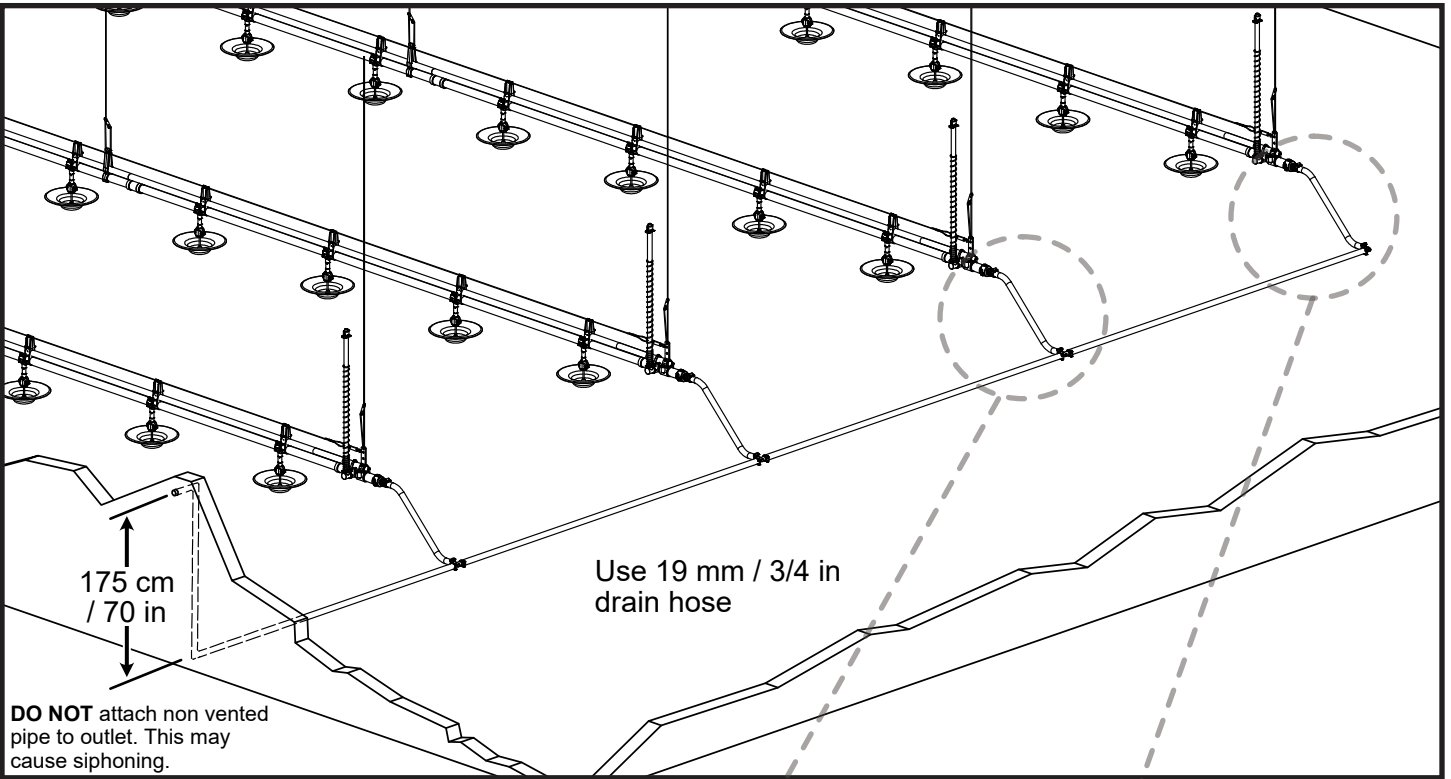

Optional Equipment

AIR RELEASE AND SHUT-OFF ASSEMBLY + INLINE RISER ASSEMBLY

1

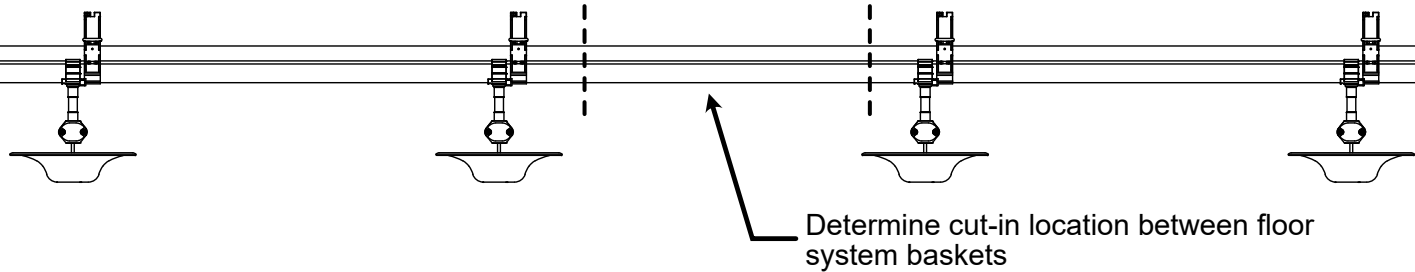

2

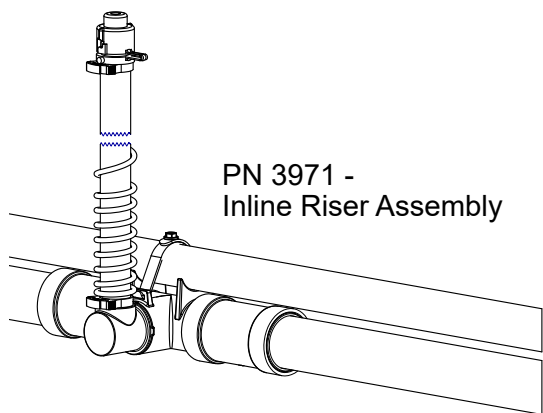

Install screws to opposing sides of
the shut off unit.

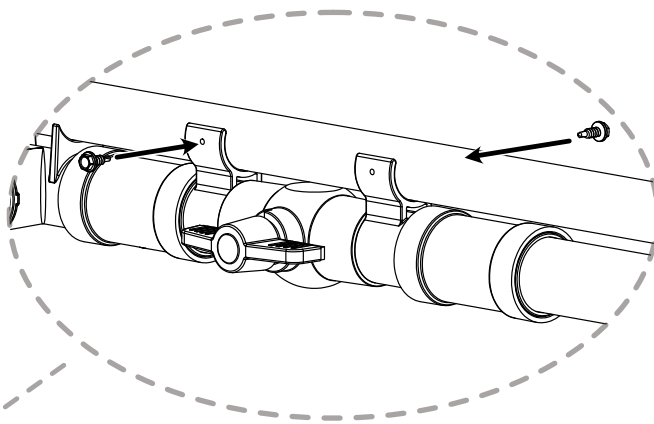
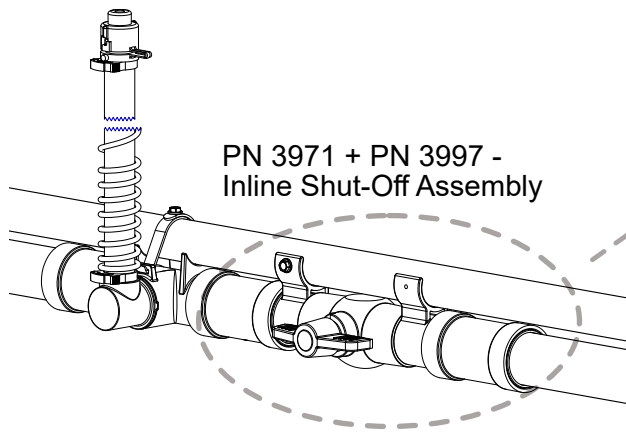

3

PN

Riser Assembly

(3971)

Riser Assembly + Shut-Off Assembly (3971 + 3997)

Cut-Away

- 130 mm / 5 in

- 340 mm / 13-3/8 in

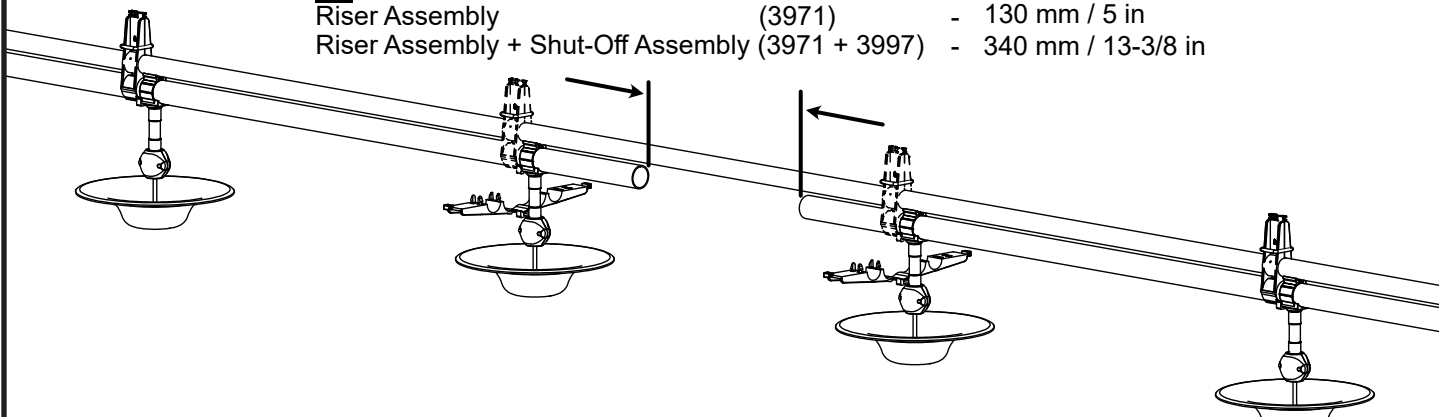

CONTROL CLOCK / CONTROLLER / SOLENOID FLUSH

Important: No more than 1 Auto-flush Regulator per station

Note: Timer / control clock must have a 24VAC output.

21.6VAC min. - 26.4VAC max.

No more than 1 Auto-flush Regulator per relay when connected to a whole house controller.

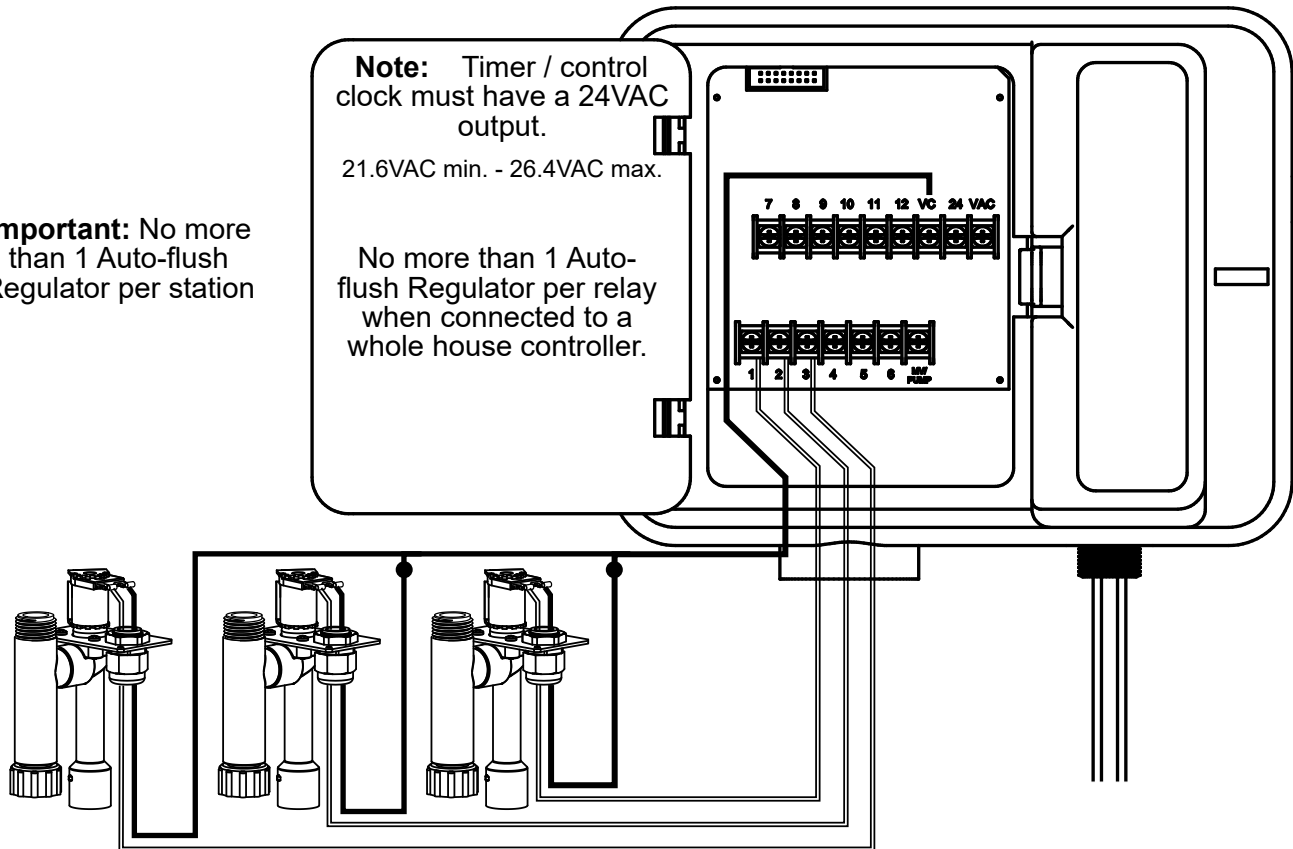

1

Insert wire up into the solenoid coupler. Use minimum 0.824mm² / 18 AWG 2 conductor jacketed wire.

16 AWG 2 conductor jacketed recommended.

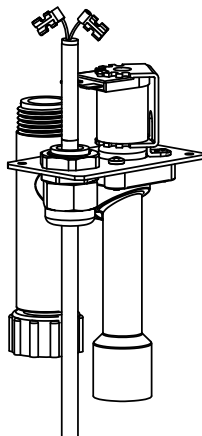

2

Must tie a knot as shown before making wire connections.

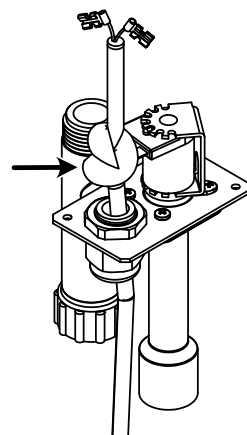

3

Solenoid must have one hot and one neutral wire connected to it. Connection of these wires do not matter, even in a series application.

Pull down on the wire until it is against the coupler and then tighten the nut on the bottom of the coupler.

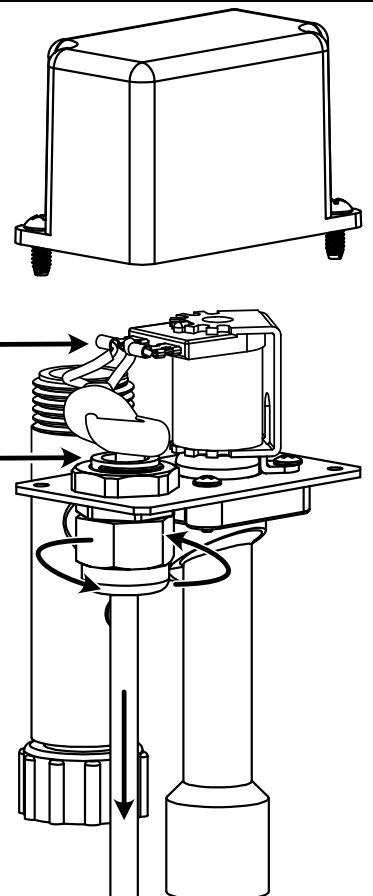

REGULATOR BALL VALVE LOCK

1

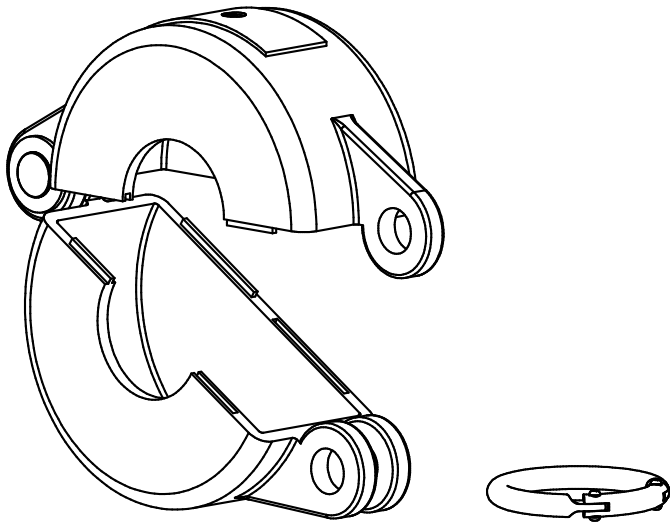

PN 2954

2

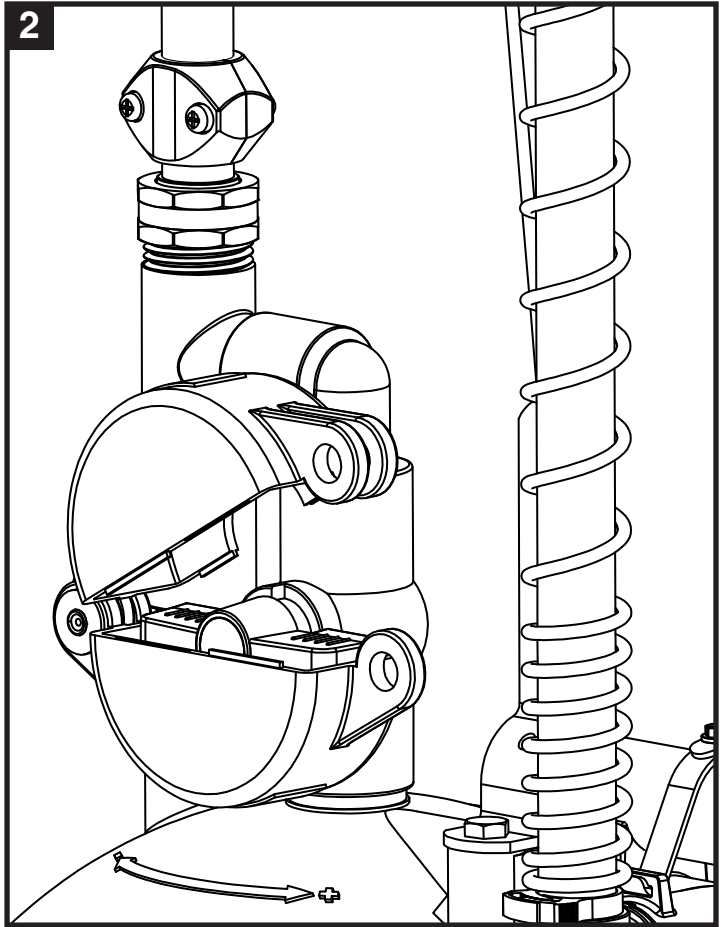

3

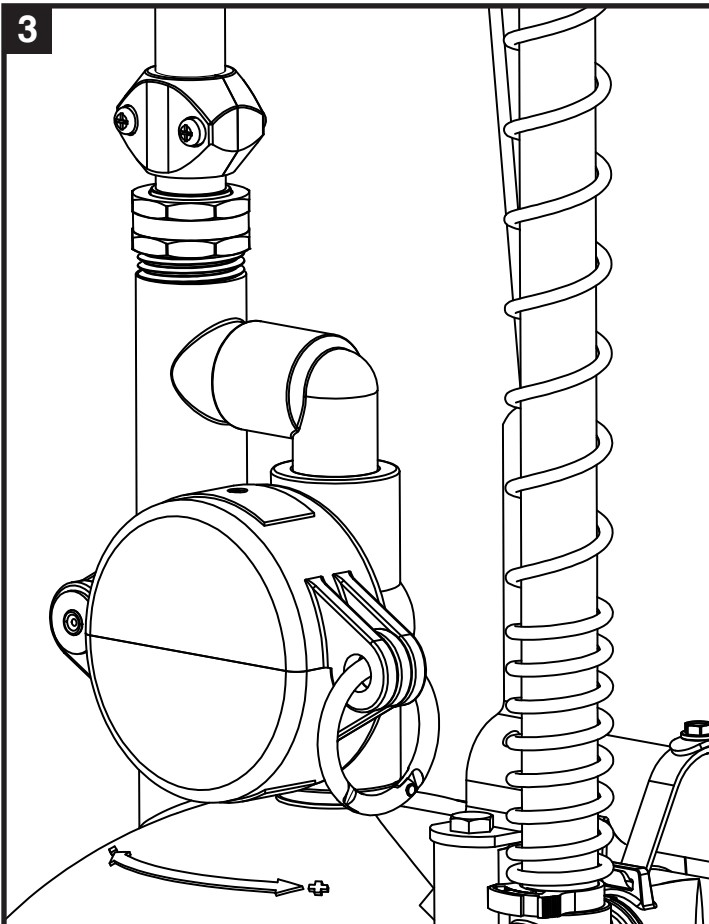

Best Practices

DISASSEMBLY: D-MAX DRINKER

1

Press the drinker downward onto a hard surface to push the capsule out of the drinker body.

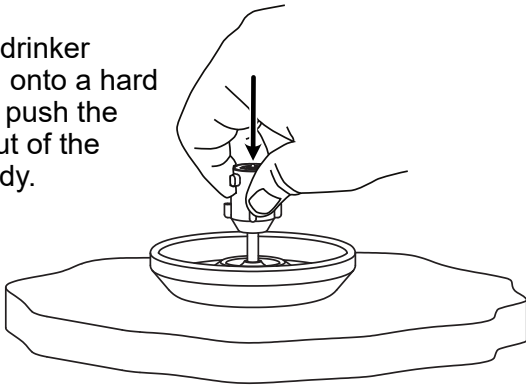

2

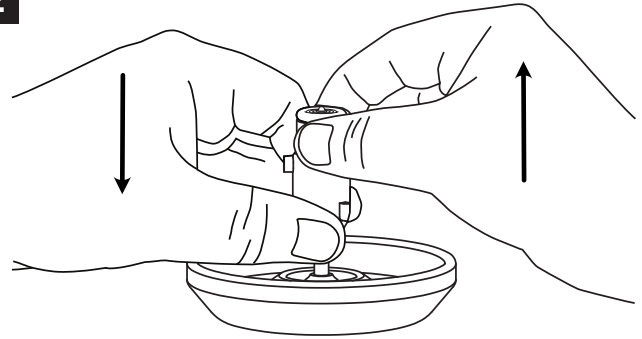

Finish pulling the drinker capsule out of the drinker body with your fingers. Place the O-Ring to the side.

3

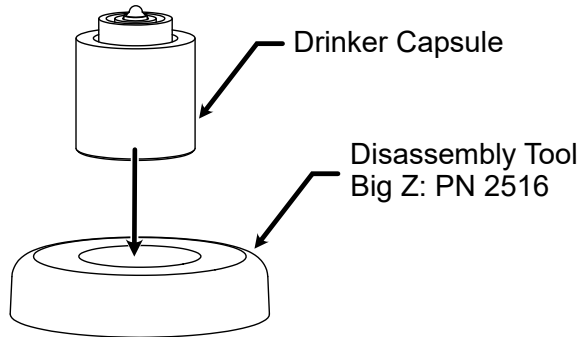

Insert the drinker capsule into the disassembly tool as shown.

4

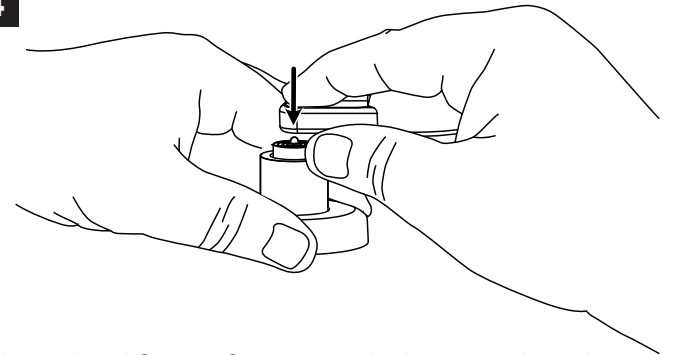

Use a hard flat surface to push downward on the metering pin.

5

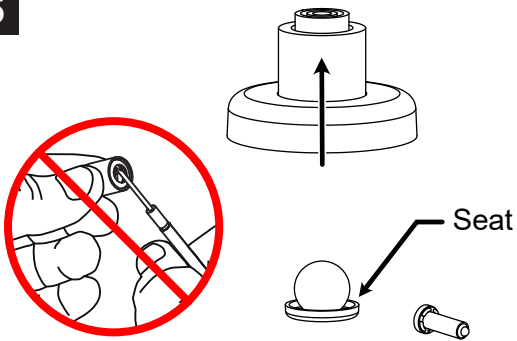

Remove disassembly tool. The ball, seat, and metering pin will come out as shown.

6

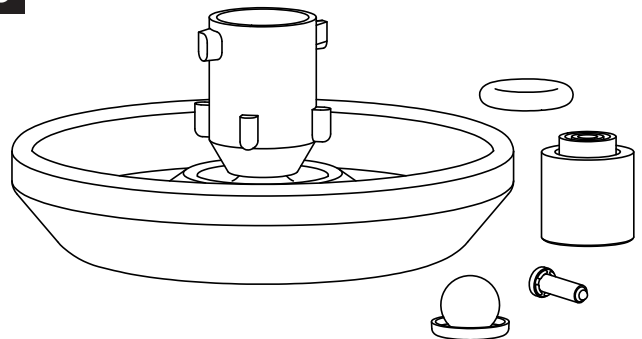

Components after disassembly.

ASSEMBLY: D-MAX DRINKER

1

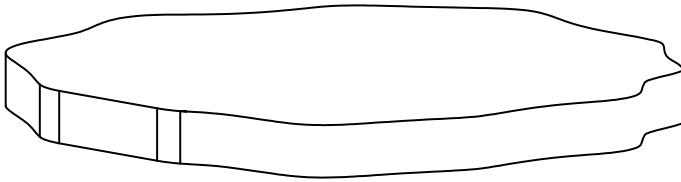

It is very important to ensure that you have a clean, flat surface to assemble the capsule. Make sure that the surface is clear of ALL debris during the entire process.

2

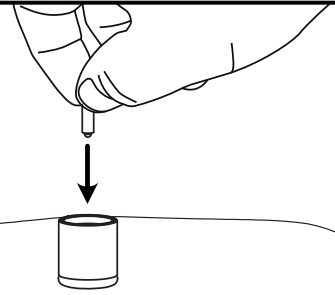

Place O-Ring onto the flat surface. Push the cap gently into the O-Ring. Drop the metering pin into the cap.

3



Place the seat with a ball in the middle onto the flat surface.

4

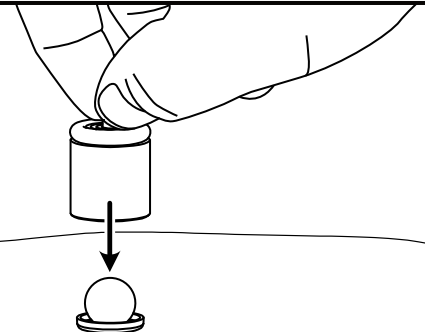

Hold the metering pin and cap as shown. Push the assembly onto the ball and seat.

5

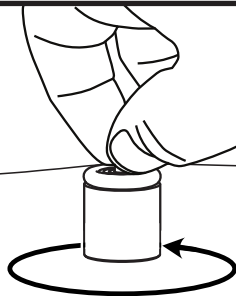

Use a circular motion while pressing the cap assembly flat against the surface.

6



NEVER use your thumb or anything to push the seat into the cap once you have completed Step 5.

7

While holding the drinker body, press capsule into the body until it is fully seated.

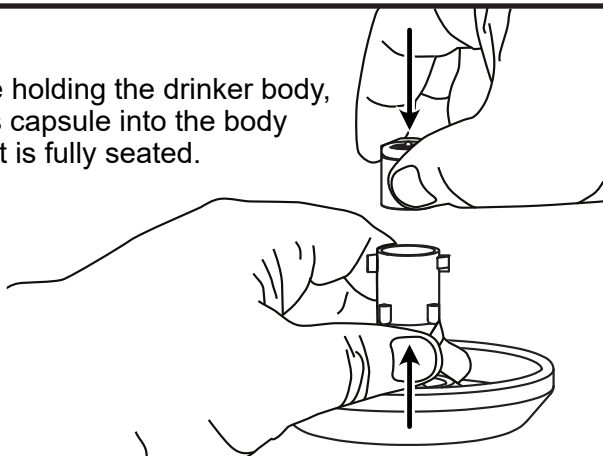

8

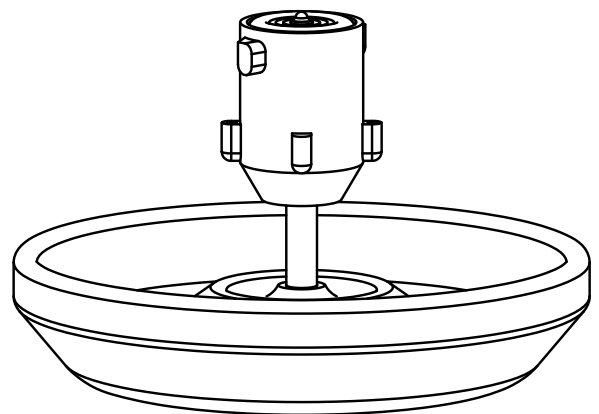

DISASSEMBLY: T-MAX DRINKER

1

Press the drinker downward onto a hard surface to push the capsule out of the drinker body.

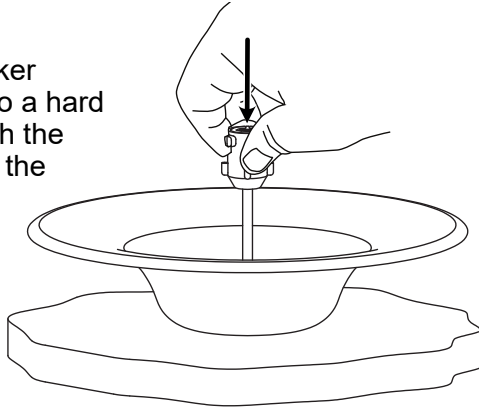

3

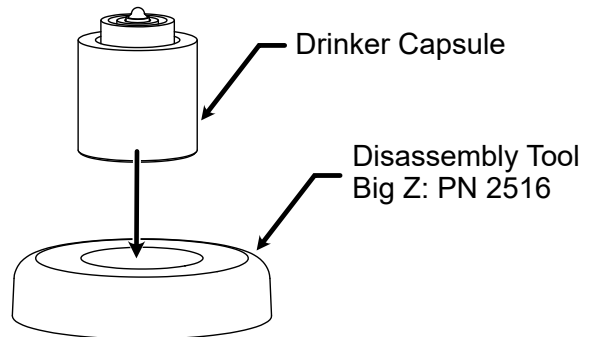

Insert the drinker capsule into the disassembly tool as shown.

3

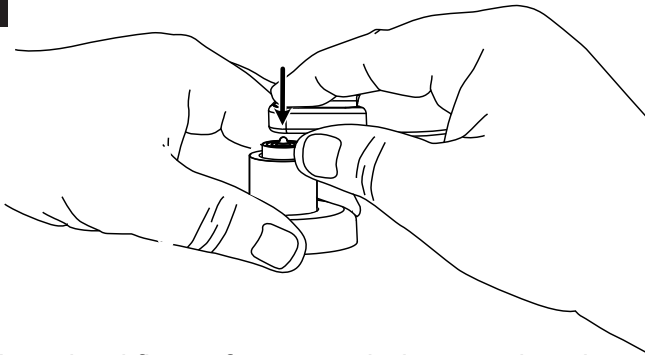

Use a hard flat surface to push downward on the metering pin.

4



Never use a tool or any object to pry the seat from the cap.

5

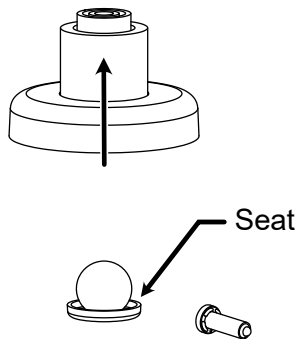

Remove disassembly tool. The ball, seat, and metering pin will come out as shown.

6

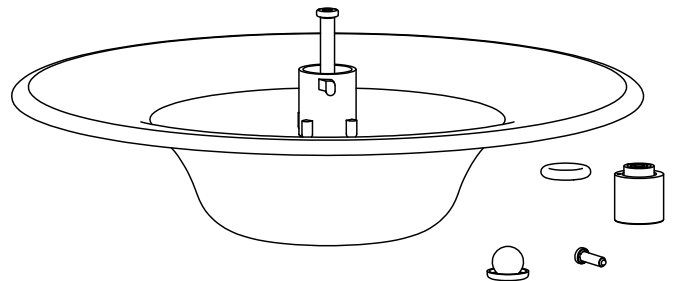

Components after disassembly.

ASSEMBLY: T-MAX DRINKER

1

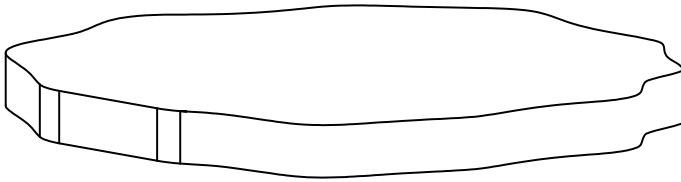

It is very important to ensure that you have a clean, flat surface to assemble the capsule. Make sure that the surface is clear of ALL debris during the entire process.

2

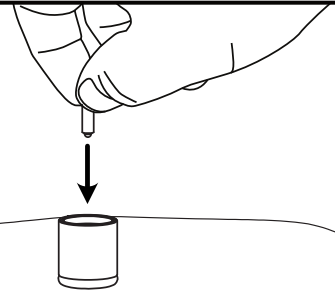

Place O-Ring onto the flat surface. Push the cap gently into the O-Ring. Drop the metering pin into the cap.

3

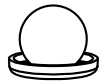

Place the seat with a ball in the middle onto the flat surface.

4

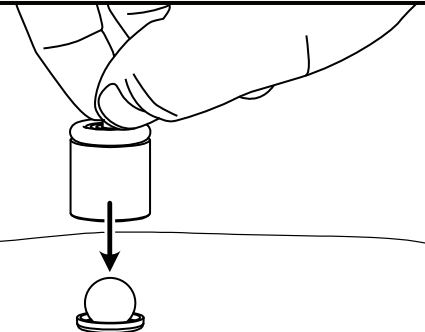

Hold the metering pin and cap as shown. Push the assembly onto the ball and seat.

5

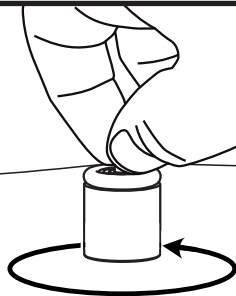

Use a circular motion while pressing the cap assembly flat against the surface.

6

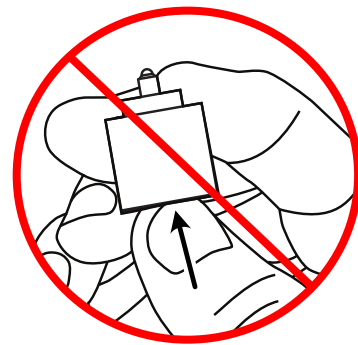

NEVER use your thumb or anything to push the seat into the cap once you have completed Step 5.

7

While holding the drinker body, press capsule into the body until it is fully seated.

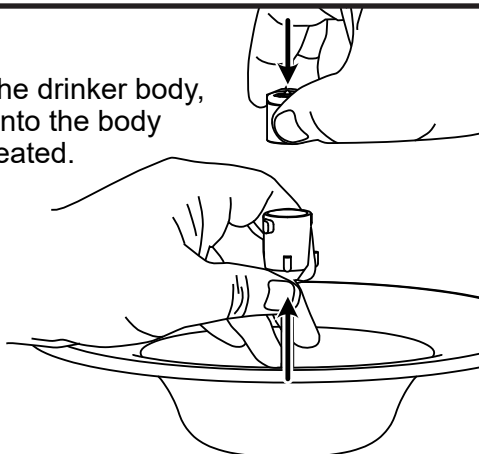

8

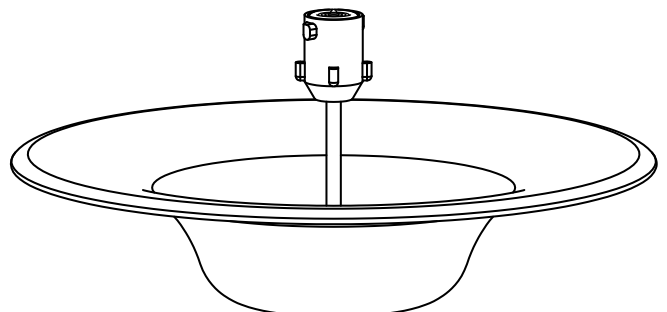

SOLENOID VALVE MAINTENANCE

1

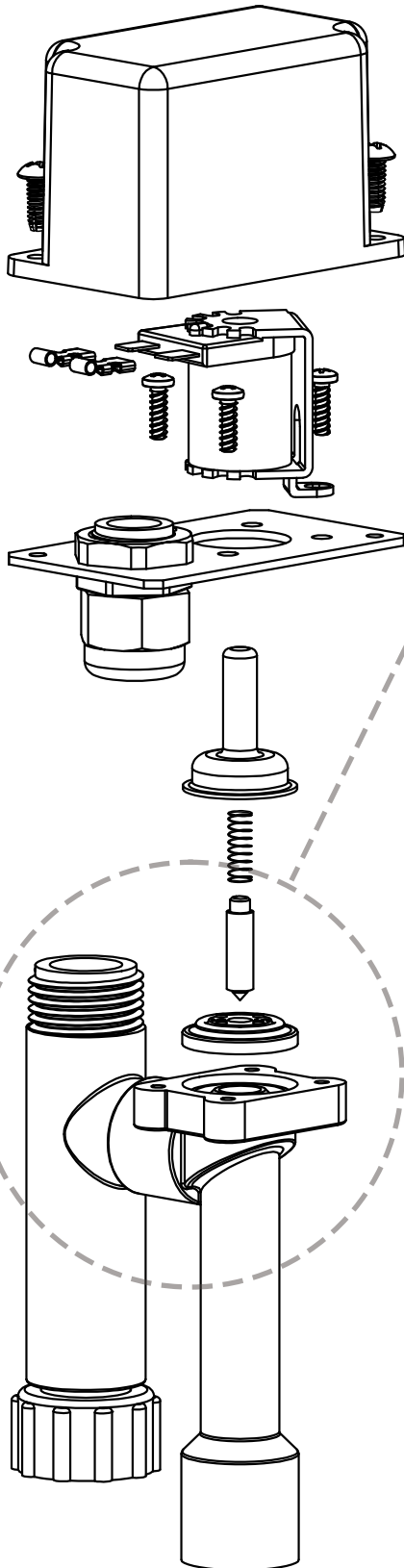

Components after disassembly.

3

Armature: Make sure point is facing downward, as shown, when reassembling.

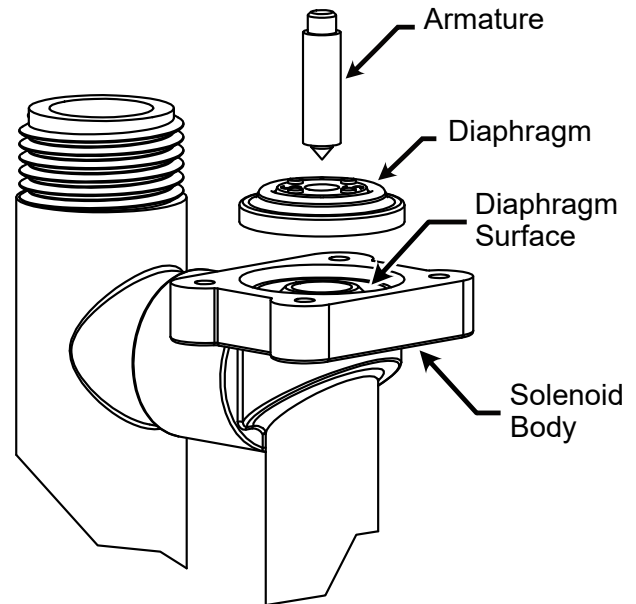

Clean solenoid body (Diaphragm surface), diaphragm and any other parts that appear dirty. Use warm soapy water and a toothbrush. Be careful not to tear the diaphragm.

3

If the diaphragm holes are plugged, use a needle to push debris out. Be careful not to tear the diaphragm.

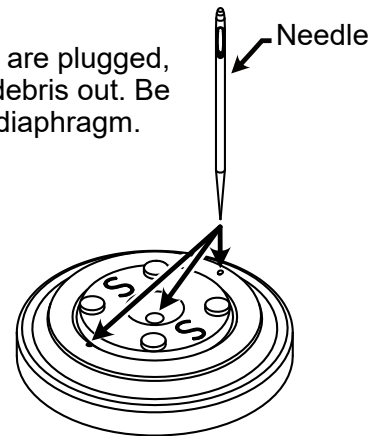

4

Gently move the needle in a circular motion to further remove debris. Be careful not to tear the diaphragm. Reassemble solenoid valve in the reverse order as shown in the first step.

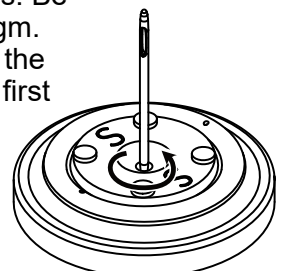

APPENDIX

NORMAL OPERATION MODE

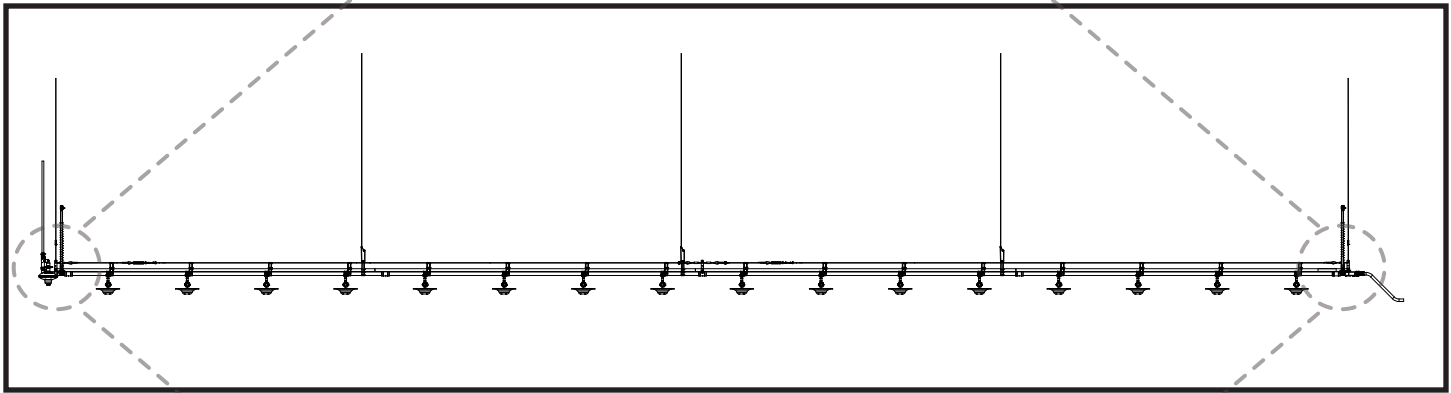
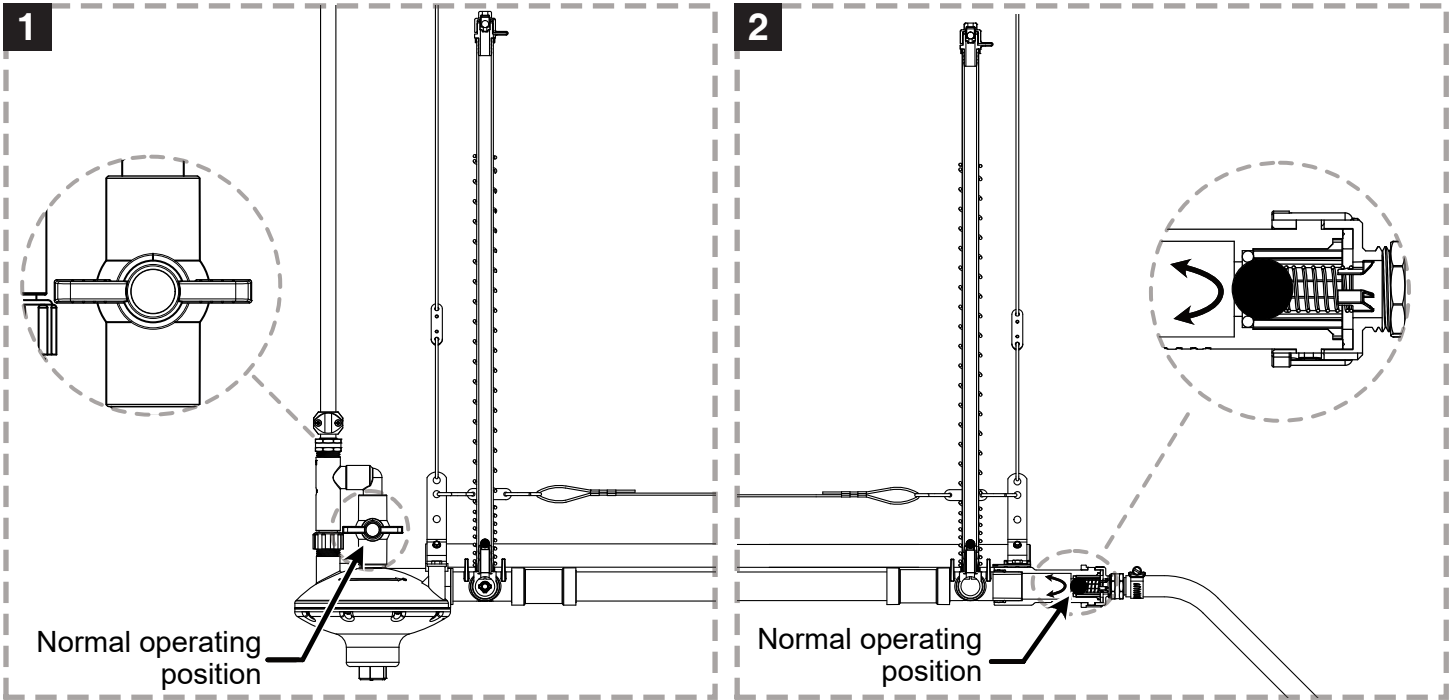

FLUSH MODE

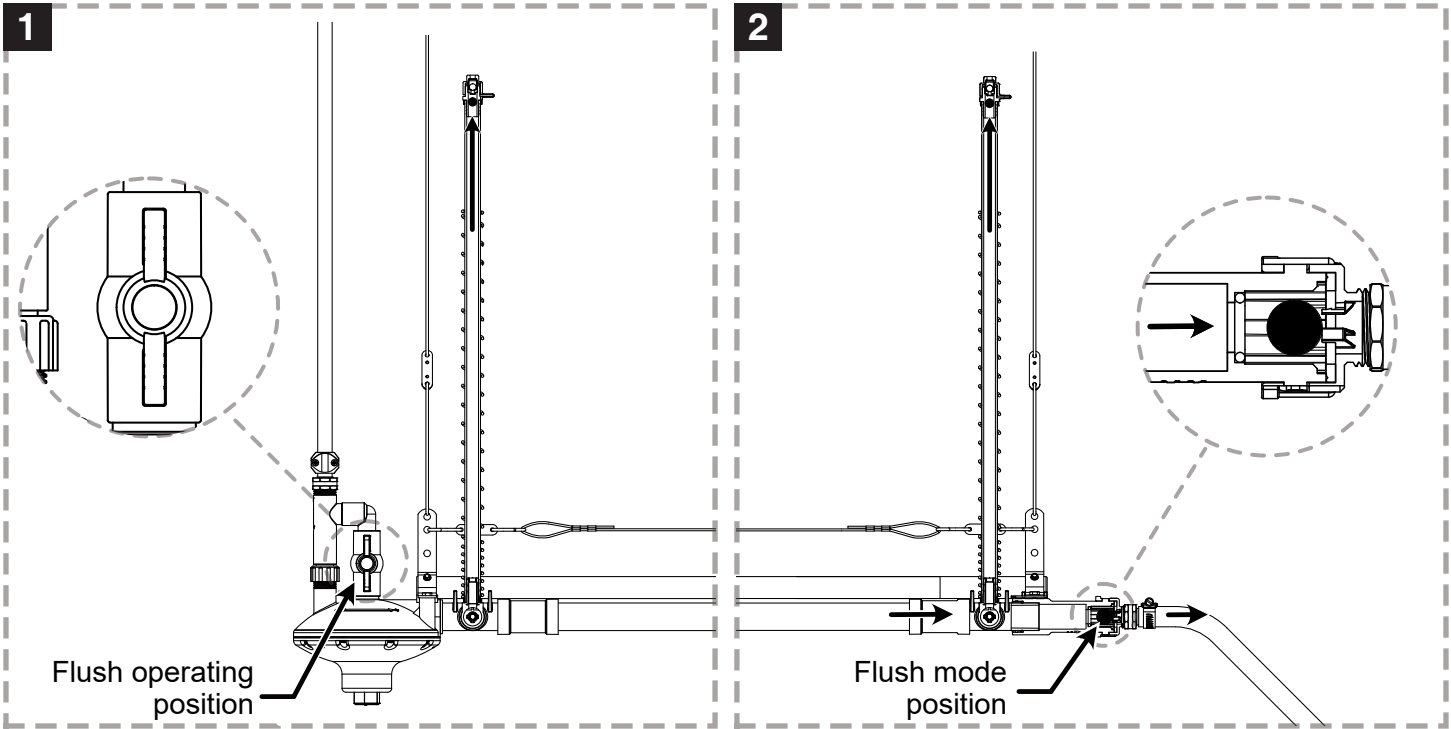

KEY FOR TERMS & NOMENCLATURE

REGULATOR ASSEMBLY

CLASSIC = REGULATOR ASSEMBLY TOP WITH RISER
NUVO = REGULATOR ASSEMBLY TOP WITHOUT RISER
FLUSH = MANUAL FLUSH FEATURE
AUTO FLUSH = SOLENOID FLUSH FEATURE
NAV = NORTH AMERICAN VERSION "GHT"
IV = INTERNATIONAL VERSION "3/4" NPSM"
APA = ACE PIPE ADAPTER
ARF = ADJUSTMENT RESISTANCE FEATURE
LPR = LOW PRESSURE RANGE
PN = PART NUMBER

TURKEY & TURKEY POULT APPLICATION

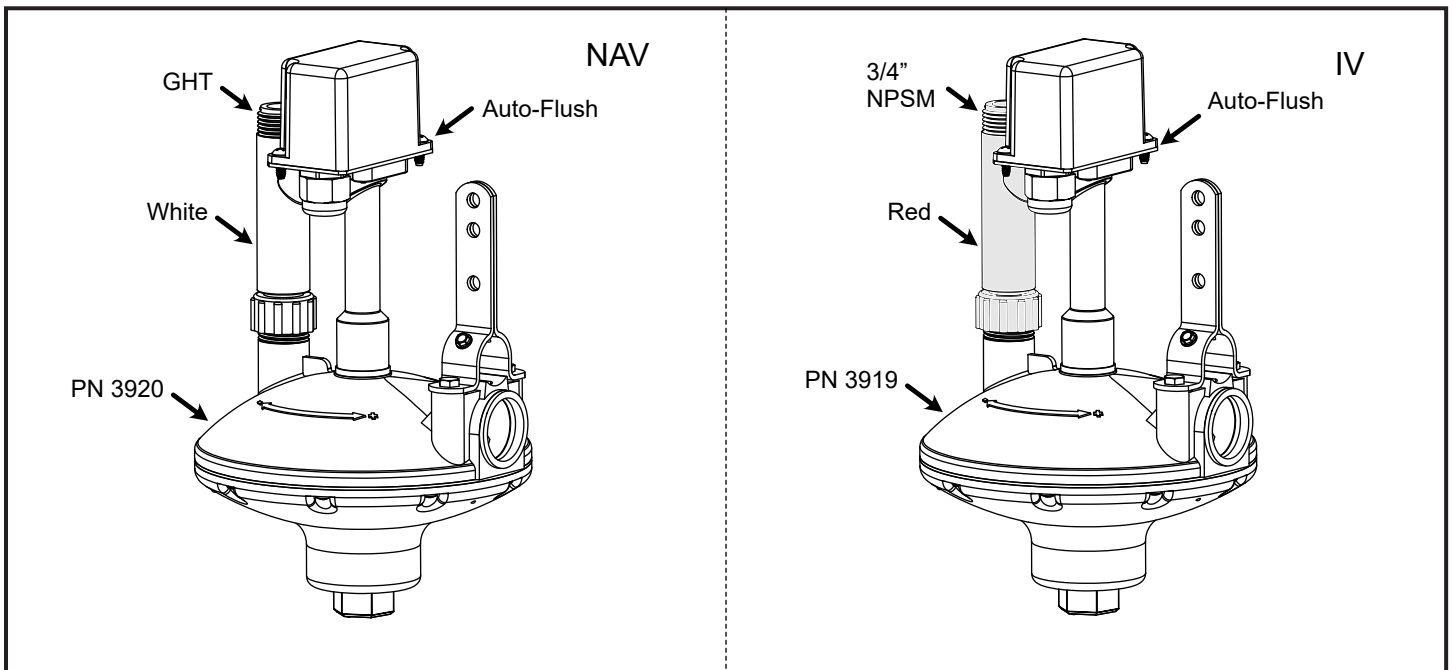
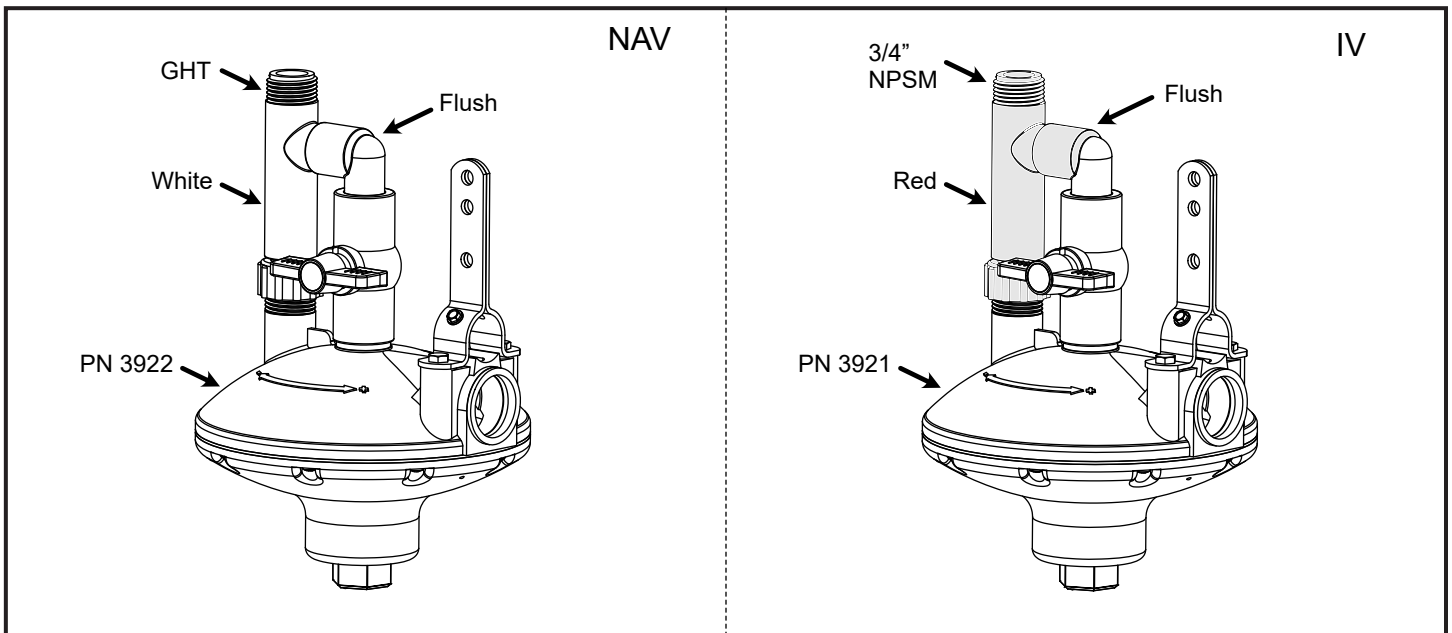

KEY FOR TERMS & NOMENCLATURE

FLUSH END ASSEMBLY

CLASSIC = END ASSEMBLY TOP WITH RISER
NUVO = END ASSEMBLY TOP WITHOUT RISER
FLUSH = MANUAL FLUSH FEATURE
AUTO FLUSH = SOLENOID FLUSH FEATURE
NAV = NORTH AMERICAN VERSION "GHT"
IV = INTERNATIONAL VERSION "3/4" NPSM"
APA = ACE PIPE ADAPTER
PN = PART NUMBER

TURKEY & TURKEY POULT APPLICATION

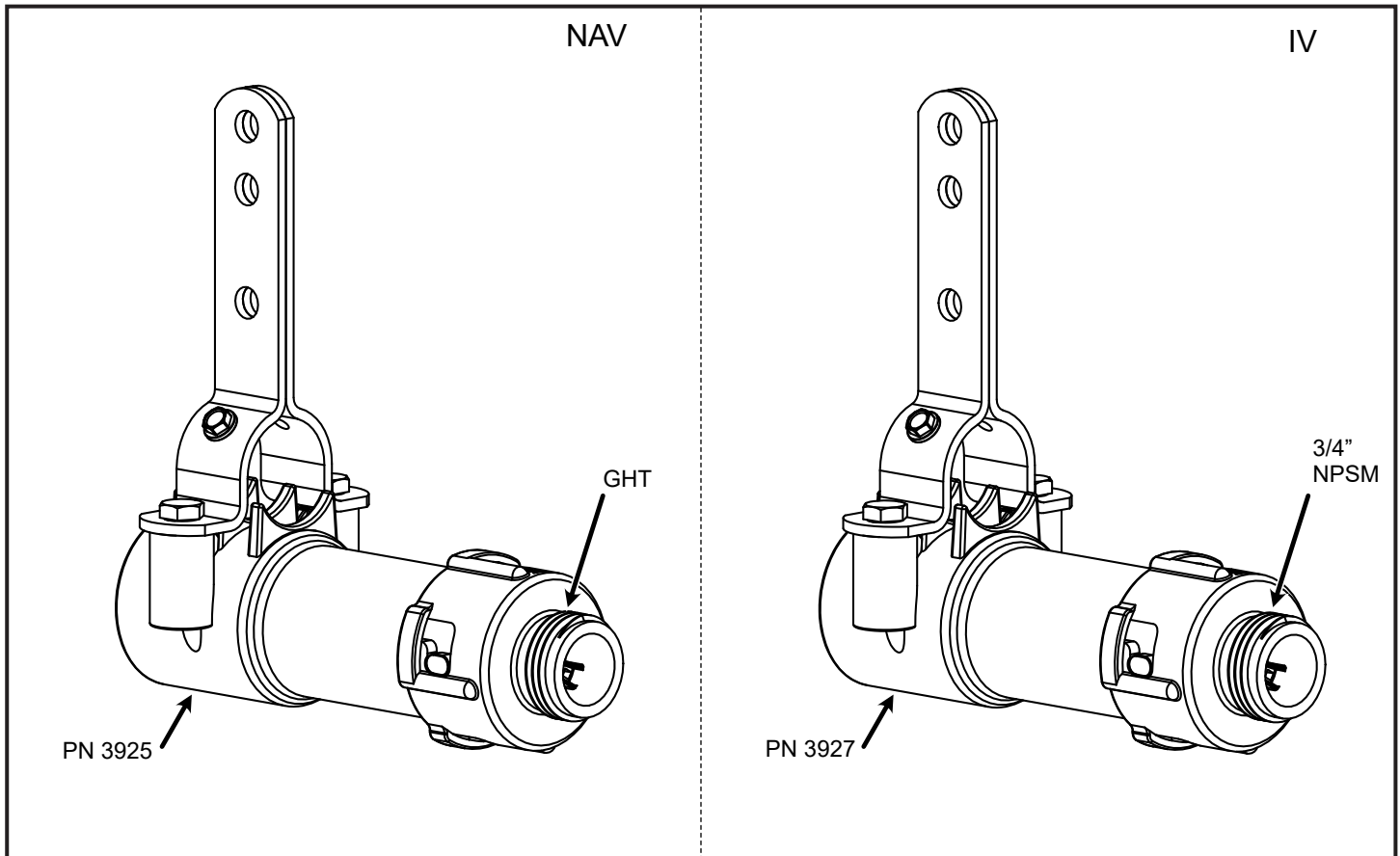

KEY FOR TERMS & NOMENCLATURE

RISER ASSEMBLY

NUVO = RISER ASSEMBLY INLINE & ENDLINE

RIGID = RIGID RISER TUBE

FLEX = FLEXIBLE RISER TUBE

APA = ACE PIPE ADAPTER

PN = PART NUMBER

TURKEY & TURKEY POULT APPLICATION

PN 3970
Flex Endline

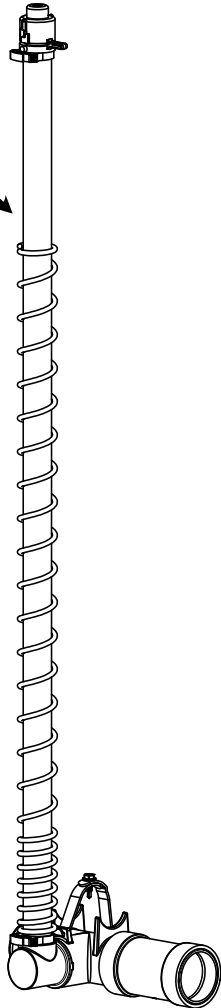

PN 3971
Flex Inline

