

The Poultry Watering Specialists



Product Line Conversion: Classic to Nuvo™

Superior performance, exceptional durability and easy management.



ZIGGITY SYSTEMS, INC.
STANDARD LIMITED WARRANTY

Ziggity Systems, Inc. ("Ziggity") warrants to the original retail purchaser ("Purchaser") of any Ziggity product ("Product"), sold by an authorized Ziggity distributor, that for one (1) year from the date of original retail purchase, the Product will be free from defects in materials and workmanship that are material in nature. The sole remedy available to Purchaser in the event of such a defect will be the repair or replacement (at Ziggity's sole option) of the materially defective Product, excluding labor. Purchaser will be responsible for the expense of shipping the defective Product to Ziggity and, upon Ziggity's approval of the warranty claim, Ziggity will be responsible for the expense of shipping the repaired or replaced Product to Purchaser. Any Product or Product replacement parts provided by Ziggity under this warranty are only warranted for the remainder of the warranty period for the original Product. Any Product or Product replacement part replaced by Ziggity under this warranty becomes the property of Ziggity. For warranty service, please contact an authorized Ziggity distributor. Alternatively, warranty requests may be sent directly to Ziggity at 101 Industrial Parkway East, Middlebury IN, 46540, USA.

This limited warranty excludes liability for defects in or damage to the Product (both internal and external) caused, directly or indirectly, by misuse, neglect, negligence, alteration, accident, excessive mineral or chemical contact, corrosive chemical use, minerals or sediment in the water, poor quality water, acts of nature or failure to: (A) follow Ziggity's guidelines and recommendations for the Product, (B) follow installation and operating instructions for the Product, (C) use potable and filtered water in and with the Product, or (D) properly maintain the Product. It also excludes used Products or Products acquired from sellers who are not authorized Ziggity distributors. Furthermore, this warranty does not extend to any item that is manufactured by others, including without limitation, items such as: galvanized support pipe, water filters, water meters, sight gauges and proportioners. These items are warranted separately by the original manufacturer, if at all.

Ziggity makes no other representations or warranties of any kind except as expressly stated in this warranty. Implied warranties, if any, arising by state law, including any implied warranties of merchantability or of fitness for a particular purpose, are limited in duration and scope to the terms of this limited warranty. Ziggity disclaims any and all implied warranties, including the warranty of merchantability and the warranty of fitness for a particular purpose, on components and items not covered by this limited warranty. To the fullest extent permitted by applicable law, Ziggity shall not be liable to Purchaser for any consequential, incidental, exemplary, punitive, special, or indirect damages, and Ziggity shall not be liable for any damages that are based on negligence, breach of warranty, or strict liability. Ziggity's liability under this warranty shall in no event exceed the purchase price paid by Purchaser for the defective Product. Some states do not allow limitations on how long an implied warranty lasts or the exclusion or limitation of incidental or consequential damages, so the above exclusions and limitations may not apply fully to you.

Ziggity may from time to time, through its issuance of formal Information Update documents, provide for supplemental warranty coverage in addition to this standard limited warranty for certain products, or may provide for deviations or exclusions from this standard warranty for certain products. If any such supplemental, deviation, or exclusion Information Updates apply to your Product, you will be provided with a copy of such Information Updates at the time of your original retail purchase and the standard limited warranty provided for above will be deemed modified accordingly.

No person, including any dealer, distributor, agent, or other representative of Ziggity, is authorized to make any representation or warranty concerning the Product other than as specifically contained in this standard limited warranty and any Information Update from Ziggity providing for any supplemental warranty coverage or deviation or exclusion from warranty coverage. Ziggity reserves the right to change Product models, make changes to the Product and Product specifications, at any time and without notice or obligation to Purchaser.

[CONTINUES ON NEXT PAGE]

ZIGGITY SYSTEMS, INC.
EXTENDED DRINKER WARRANTY

In addition to its standard limited warranty, Ziggity provides an extended warranty for certain Drinkers manufactured by Ziggity. All other provisions of the standard limited warranty apply to the Extended Drinker Warranty. If any covered Drinker is determined by Ziggity to be defective in materials or workmanship after the expiration of the one (1) year standard warranty period and prior to ten (10) years after the date of the original retail purchase, Ziggity will provide a replacement Drinker or Drinker components, as applicable, to the original retail purchaser at the following discount off of published list/brutto prices:

End User Purchase Date	End User Discount
0 - 36 months	100% (No charge)
37 - 60 months	65%
61 - 120 months	40%

WARNING – AVOID USE WITH OR EXPOSURE TO CORROSIVE PRODUCTS

Do not allow Ziggity products to come into contact with petroleum, phenol or aldehyde based products or any other corrosive product in general. Contact with such corrosive products is likely to result in damage to or failure of the Ziggity product. Additionally, aggressive chlorination and/or acidification programs (greater than 1 ppm and/or pH less than 6) will shorten the life of Ziggity products. Failure to follow this warning will void any otherwise applicable warranty coverage for the Ziggity product when the product is chemically damaged.

WARNING – GALVANIZED SUPPORT PIPE SPECIFICATIONS

Please note that using a support pipe that does not conform to the specifications noted in Ziggity's official written publications, including but not limited to, Information Update 2065 and our Installation Manuals, will compromise system performance and make null and void Ziggity's warranty provisions.

PLEASE NOTE

Extended Drinker Warranty does not apply to Ziggity drinkers with the following metering pin colors:
Blue, Gray, Gold, Red, and Black.

Extended Drinker Warranty does not apply to T-Max Drinkers.

The Poultry Watering Specialists



CONTENTS

PRODUCT LINE CONVERSION: CLASSIC TO NUVO™

CLASSIC REGULATOR TO NUVO™ ENDLINE RISER

Disassembly: Riser Tube from Classic Regulator	6
Sealing Plug (PN 4142)	6
Preparation for Pipe Cut-In Location: Regulator	7
Cut-In Locations for Big Ace, Big Z, & 1 IN PVC Systems	8
Cut-In Location for Ace Systems	8
Nuvo™ Endline Riser Assembly	9
Endline Riser Assembly onto Pipes - Big Ace, Big Z, & 1 IN PVC Systems	9
Endline Riser Assembly onto Pipes - Ace Systems	9
Regulator onto Endline Riser Assembly - Big Ace, Big Z, 1 IN PVC Systems	10
Endline Riser Assembly onto Pipes - Ace Systems	10
Support Clamp Fasteners	10
Nuvo™ Endline Riser Assembly Conversion - Big Ace, Big Z, 1 IN PVC Systems	11
Nuvo™ Endline Riser Assembly Conversion - Ace Systems	11
PN 3894 & PN 3895	12

CLASSIC END ASSEMBLY TO NUVO™ ENDLINE RISER

Disassembly: Classic End Assembly	14
Sealing Plug (PN 4142)	14
Preparation for Pipe Cut-In Location: End Assembly	15
Cut-In Locations for Big Ace, Big Z, & 1 IN PVC Systems	16
Cut-In Location for Ace Systems	16
Nuvo™ Endline Riser Assembly	17
Endline Riser Assembly onto Pipes - Big Ace, Big Z, & 1 IN PVC Systems	17
Endline Riser Assembly onto Pipes - Ace Systems	17
End Assembly onto Endline Riser - Big Ace, Big Z, 1 IN PVC Systems	18
End Assembly onto Endline Riser - Ace Systems	18
Support Clamp Fasteners	18
Nuvo™ Endline Riser Assembly Conversion - Big Ace, Big Z, 1 IN PVC Systems	19
Nuvo™ Endline Riser Assembly Conversion - Ace Systems	19
PN 3894 & PN 3895	20

Classic Regulator to Nuvo™ Endline Riser

DISASSEMBLY: RISER TUBE FROM CLASSIC REGULATOR

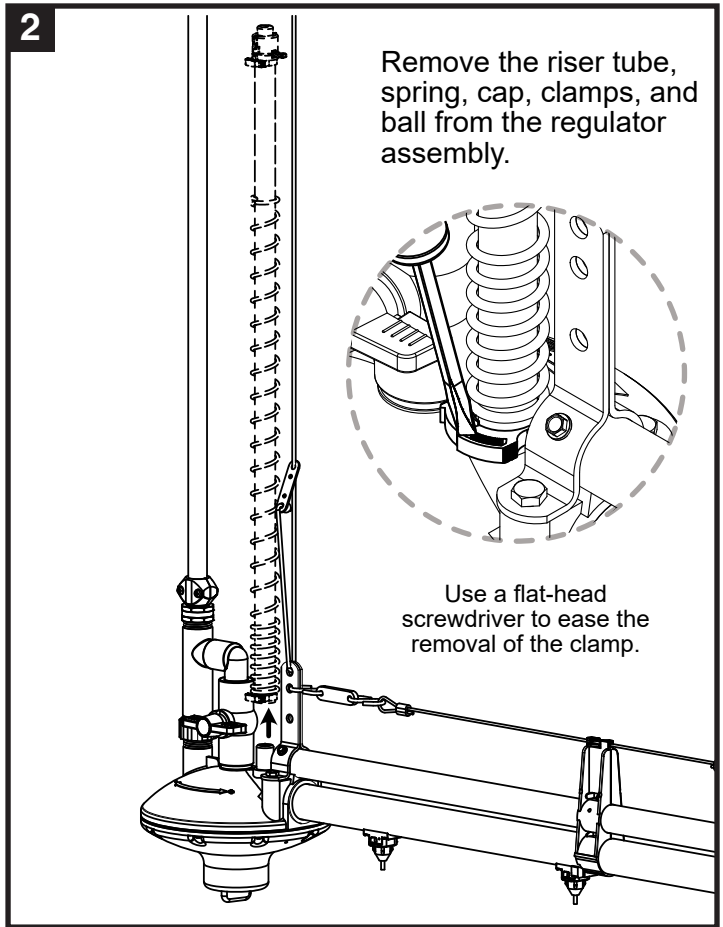
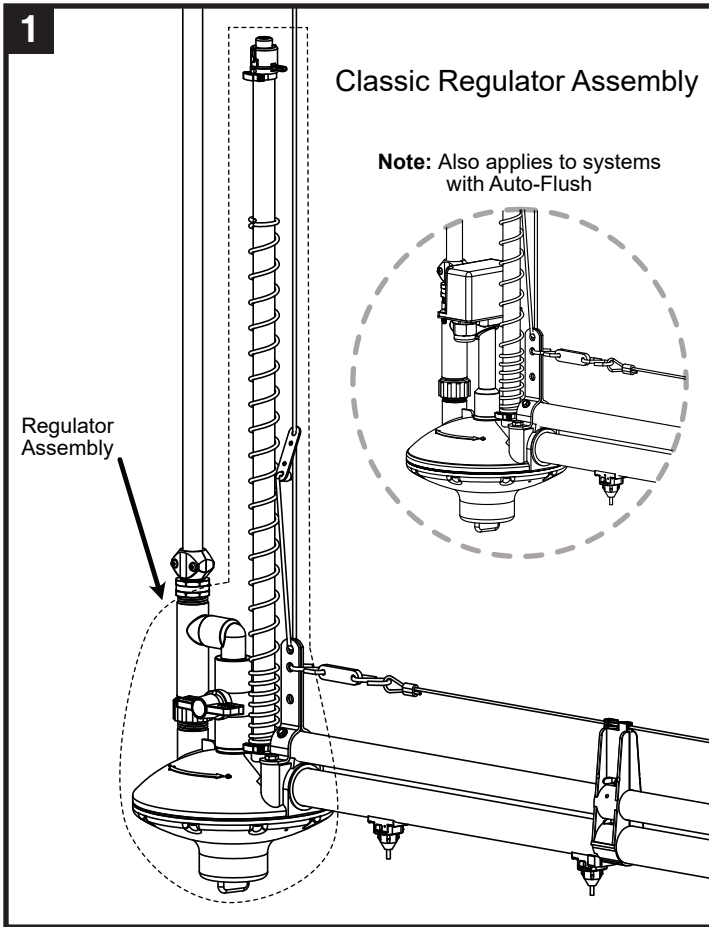

SEALING PLUG (PN 4142)

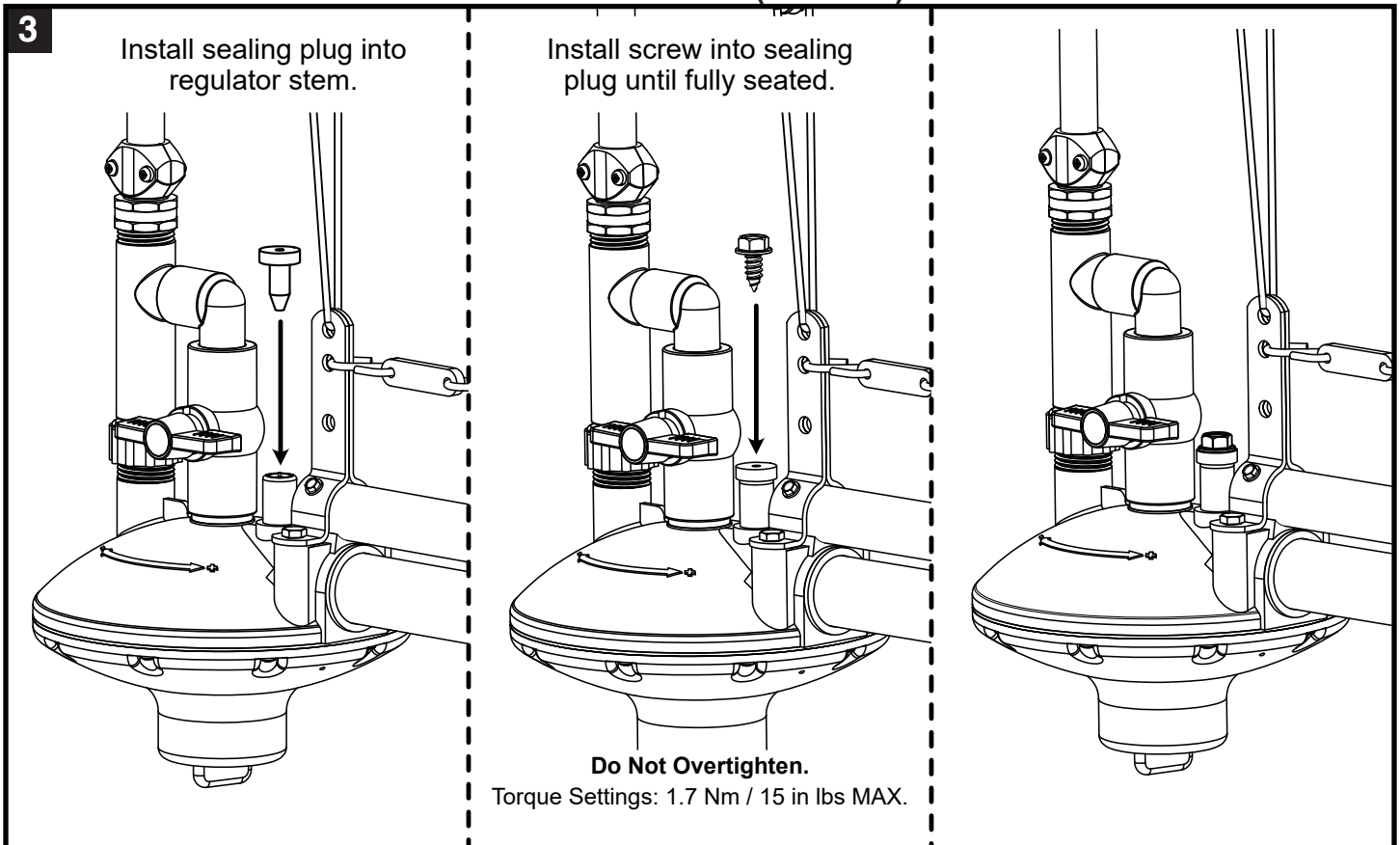

PREPARATION FOR PIPE CUT-IN LOCATION: REGULATOR

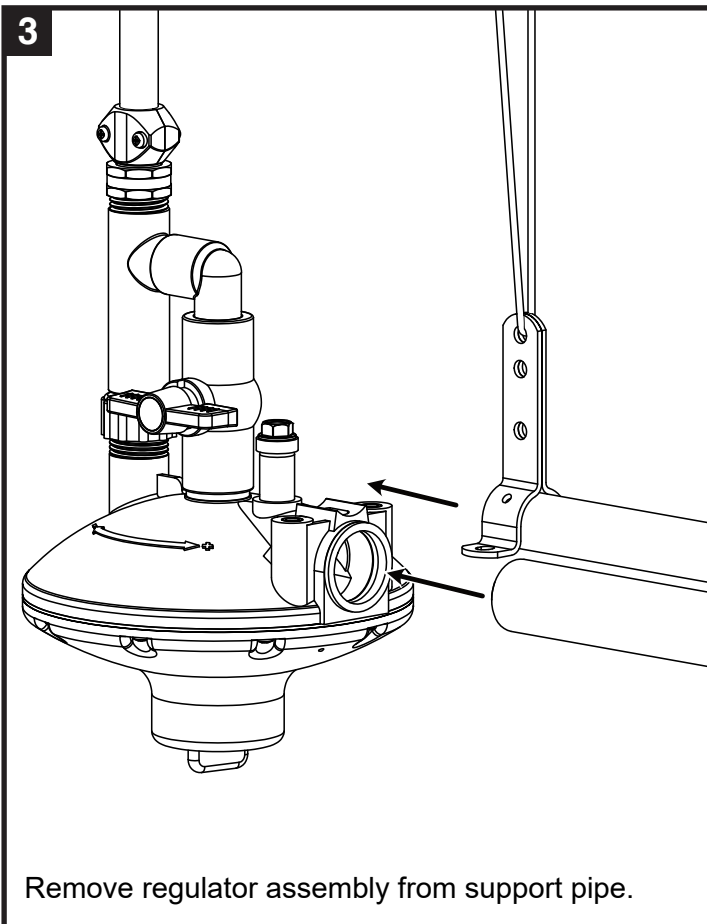
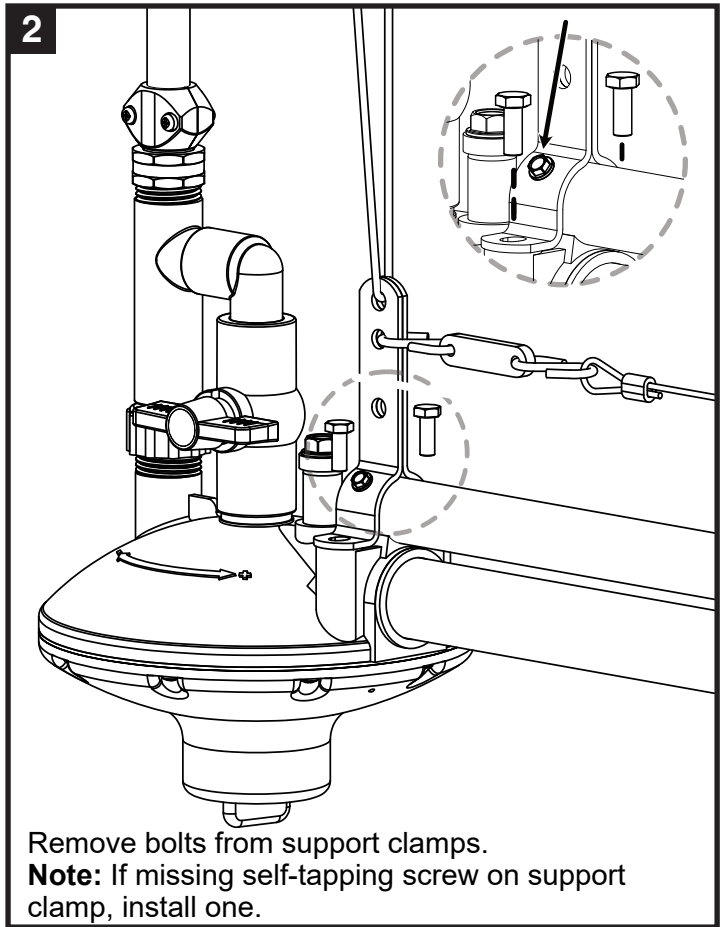
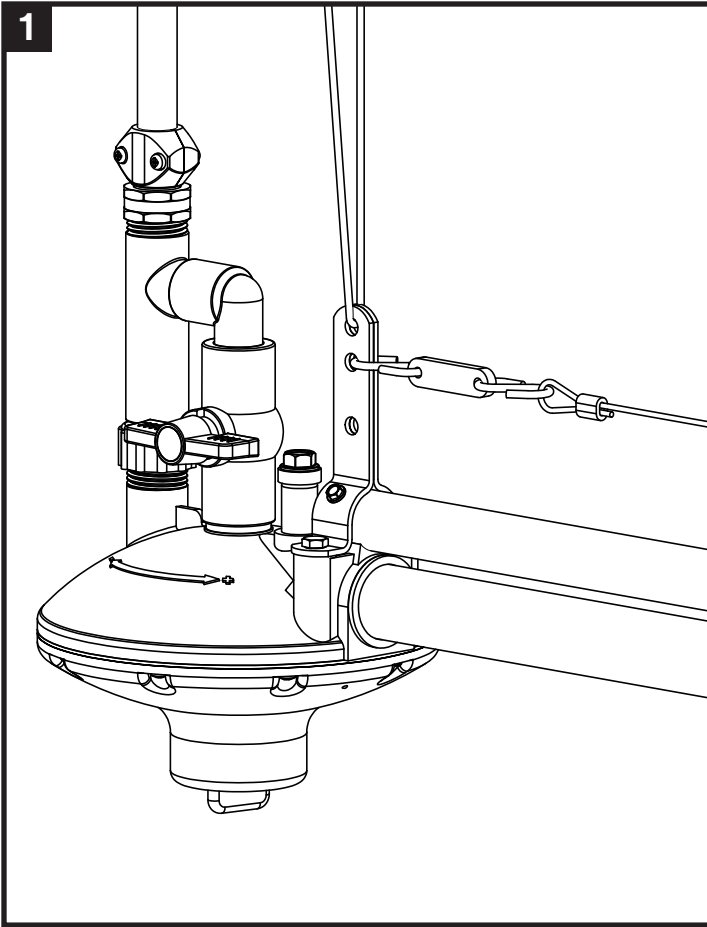

CUT-IN LOCATIONS FOR BIG ACE, BIG Z, & 1 IN PVC SYSTEMS

1

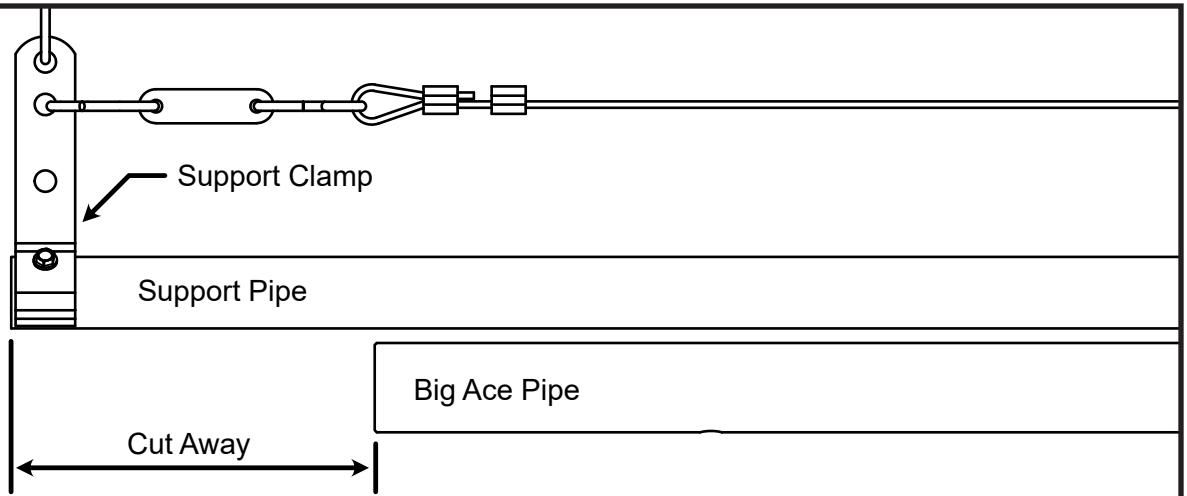

To fit the Endline Riser Assembly onto pipes, make sure the cut away is 14 mm / 5-1/2 in.

CUT-IN LOCATION FOR ACE SYSTEMS

2

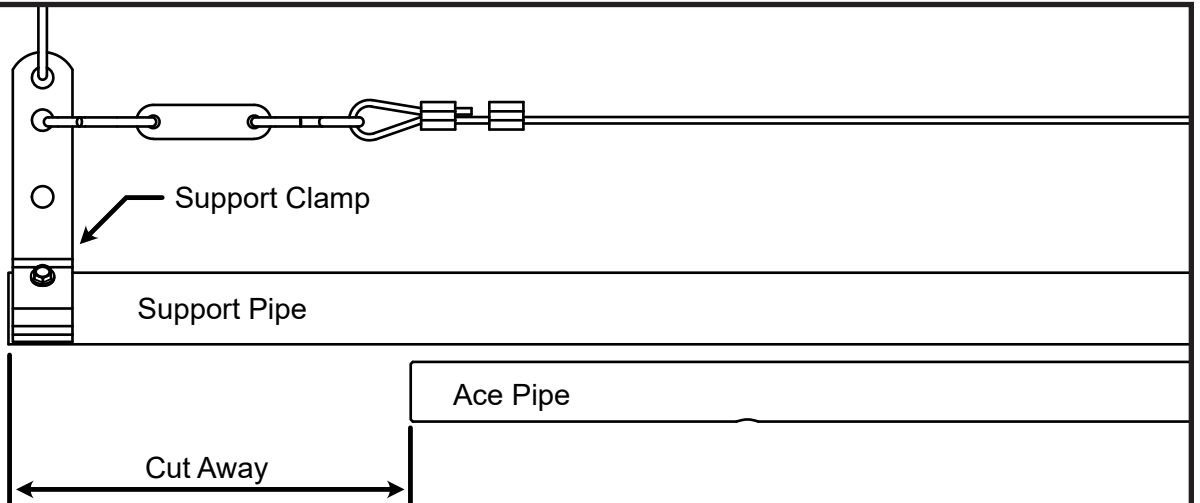

To fit the Endline Riser Assembly onto pipes, make sure the cut away is 16 mm / 6-1/2 in.

NUVO™ ENDLINE RISER ASSEMBLY

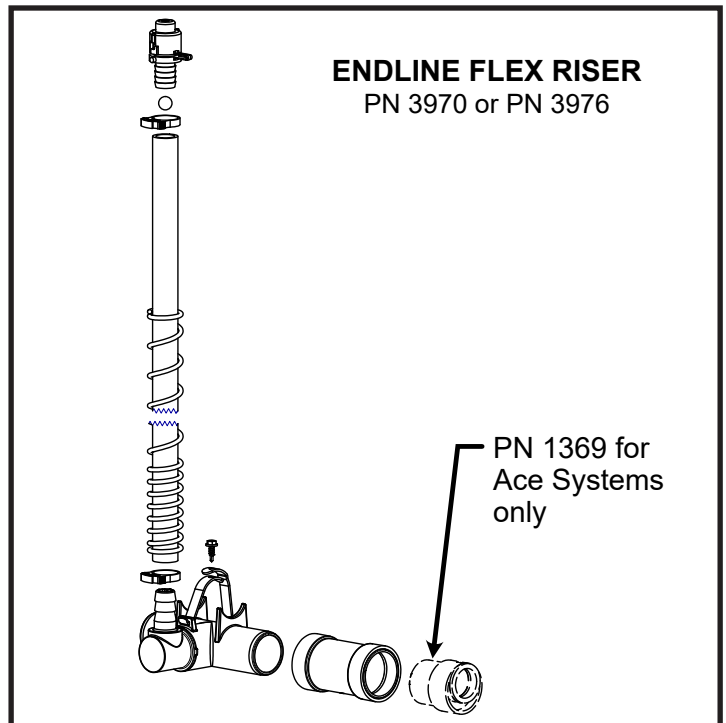
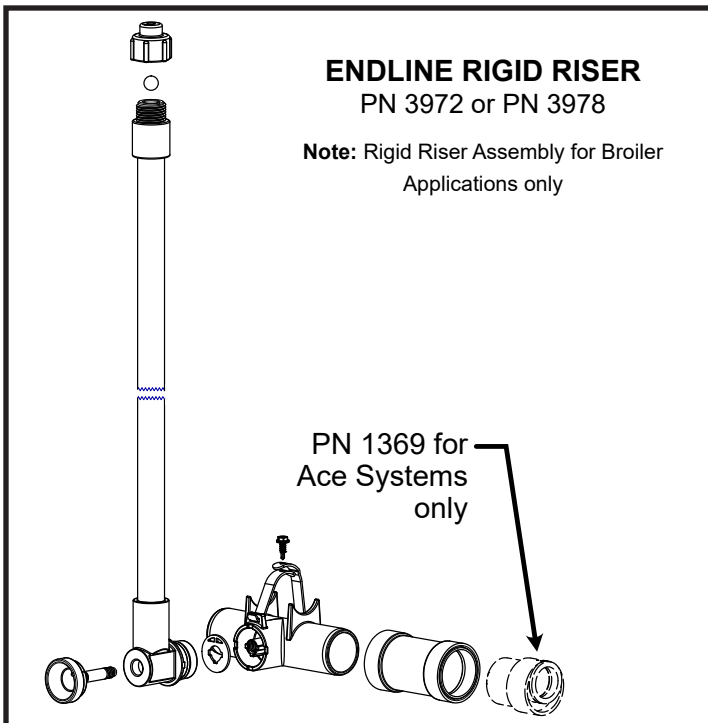

ENDLINE RISER ASSEMBLY ONTO PIPES - BIG ACE, BIG Z, & 1 IN PVC SYSTEMS

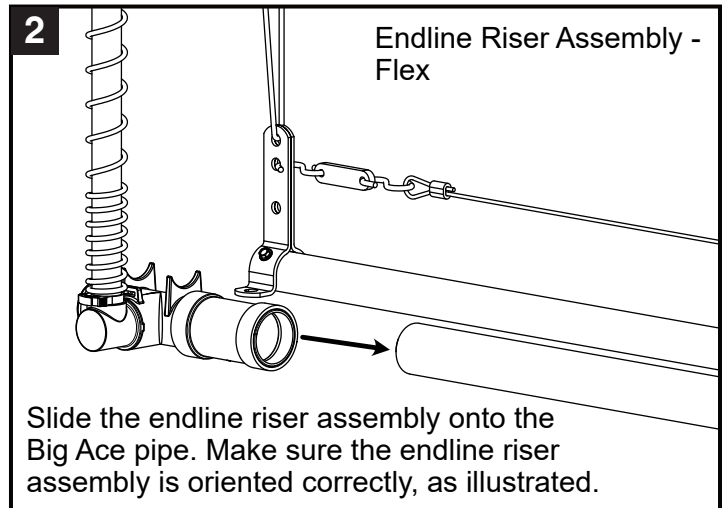
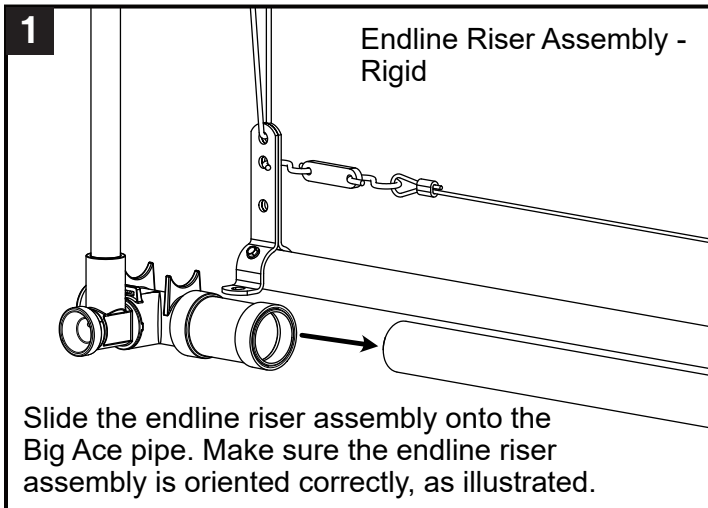

ENDLINE RISER ASSEMBLY ONTO PIPES - ACE SYSTEMS

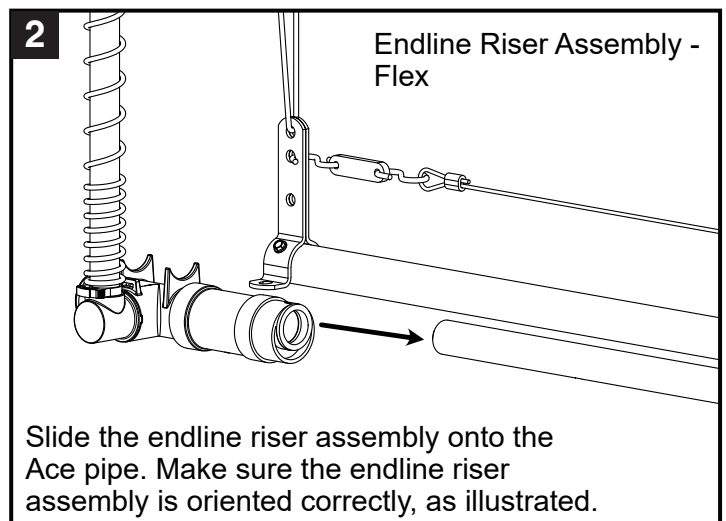
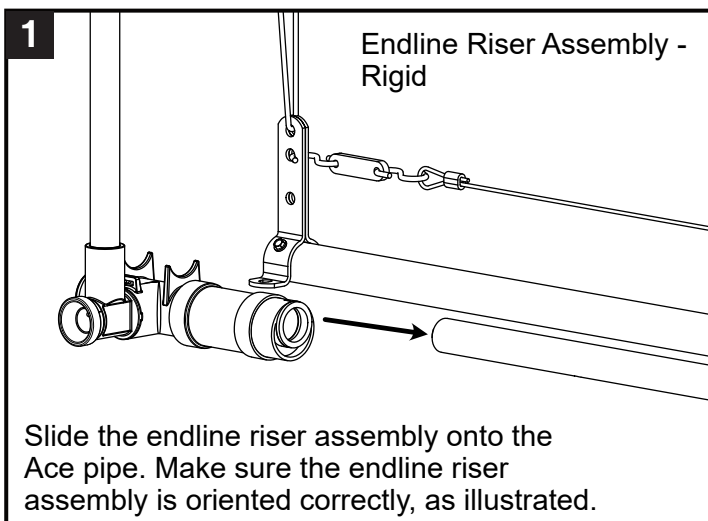

REGULATOR ONTO ENDLINE RISER ASSEMBLY - BIG ACE, BIG Z, & 1 IN PVC SYSTEMS

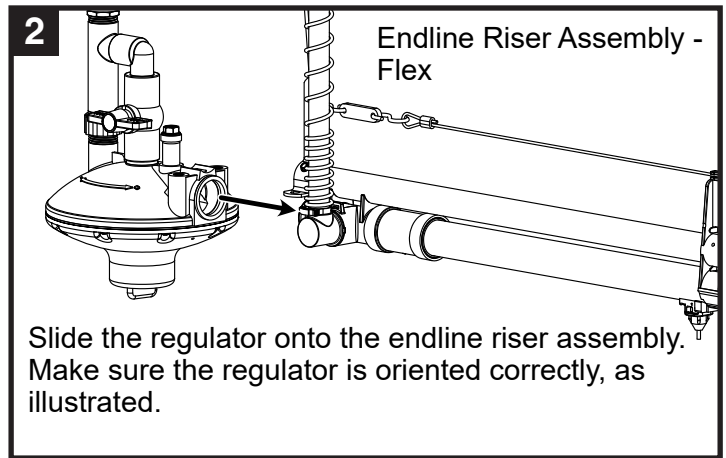
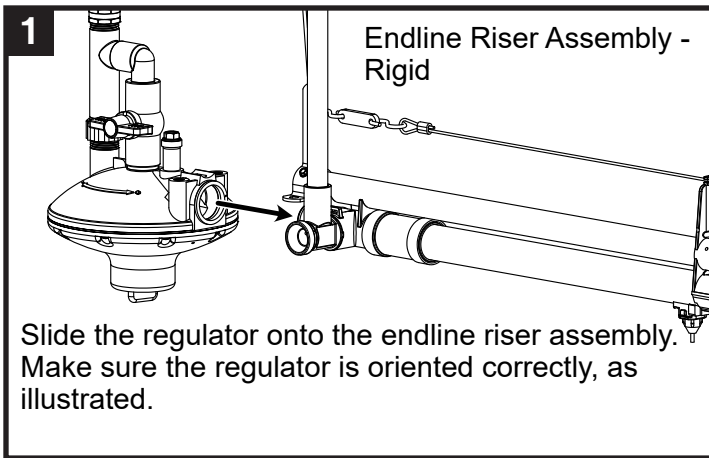

REGULATOR ONTO ENDLINE RISER ASSEMBLY - ACE SYSTEMS

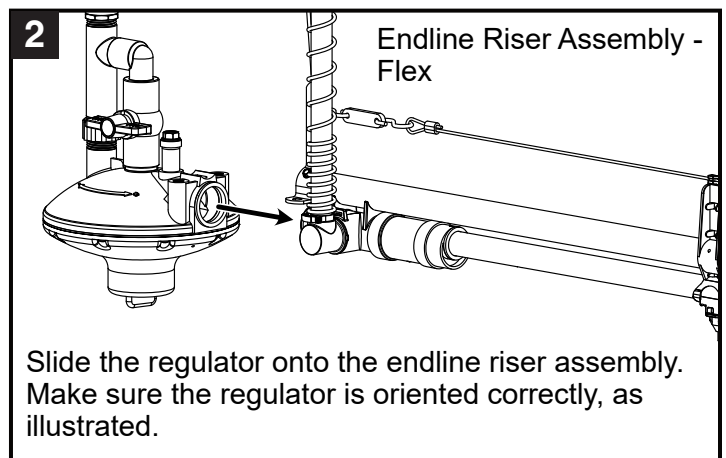
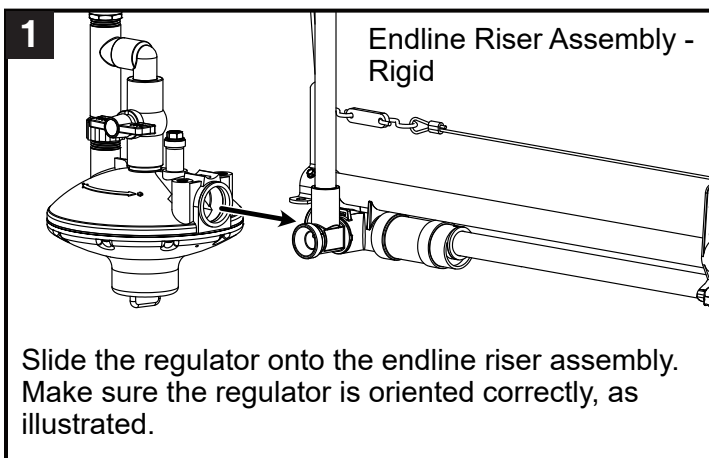

SUPPORT CLAMP FASTENERS

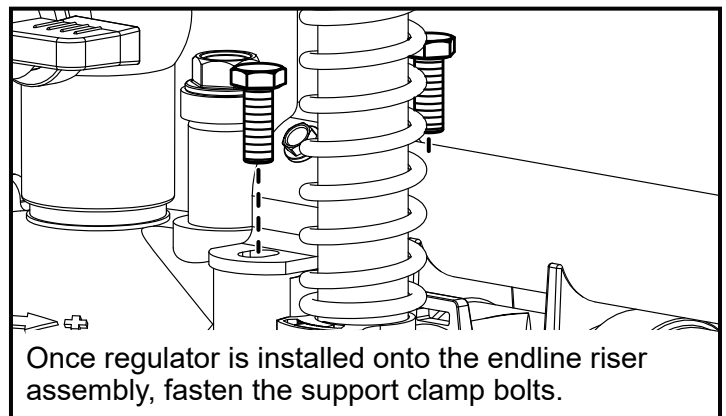
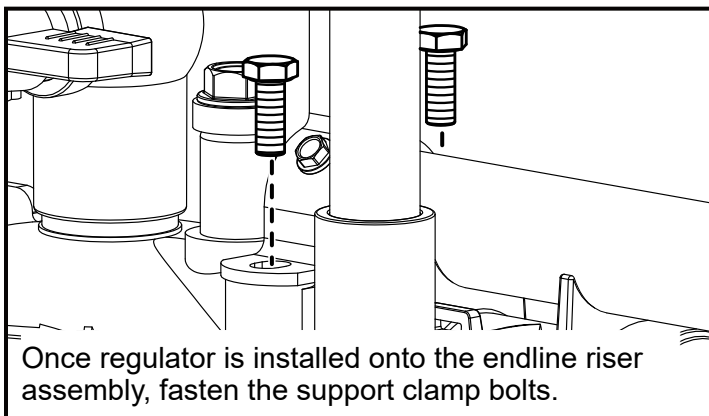

Important: Before fastening the support clamp fasteners, push or pull the endline riser assembly for correct gapping.

NUVO™ ENDLINE RISER ASSEMBLY CONVERSION - BIG ACE, BIG Z, 1 IN PVC SYSTEMS

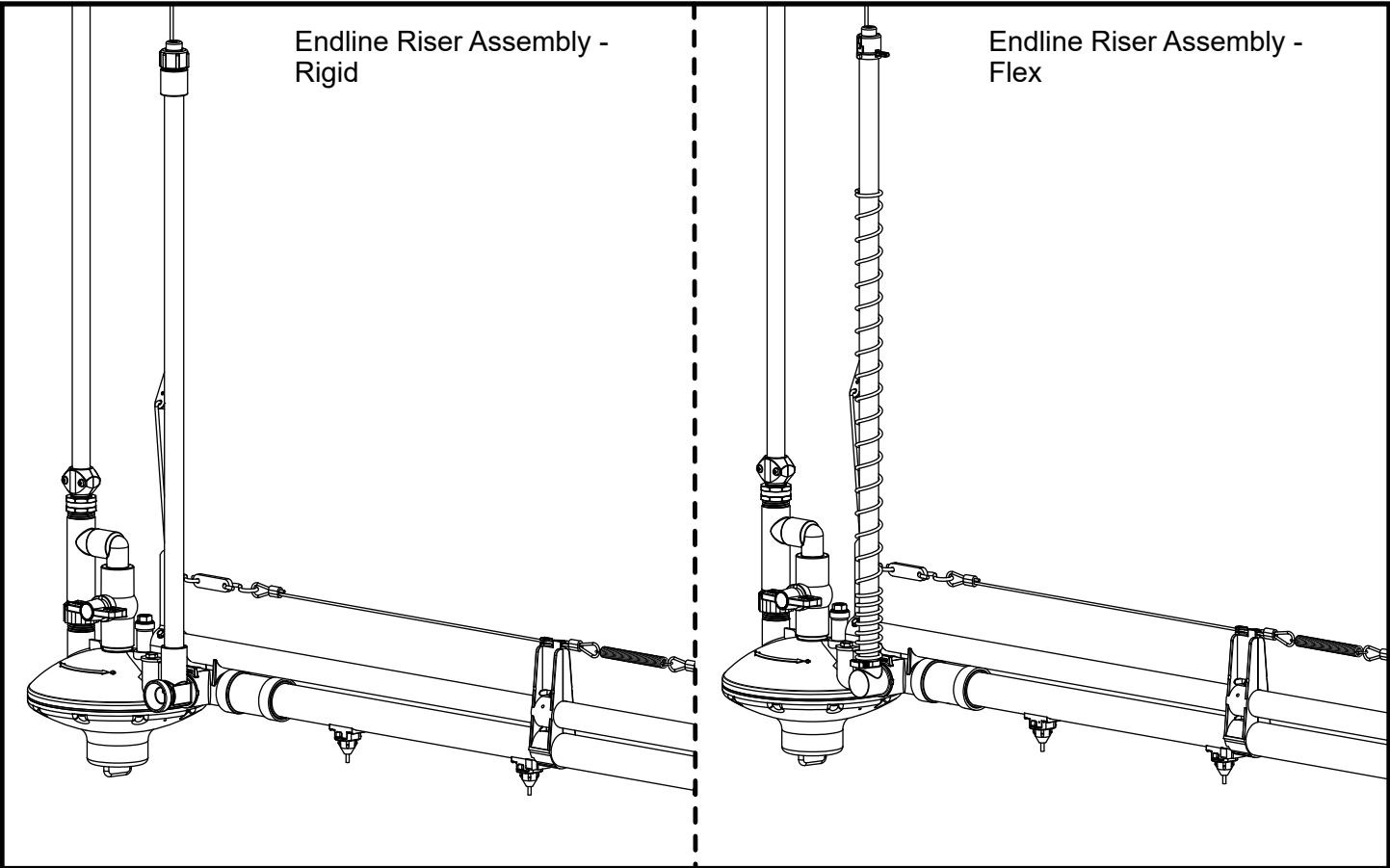

NUVO™ ENDLINE RISER ASSEMBLY CONVERSION - ACE SYSTEMS

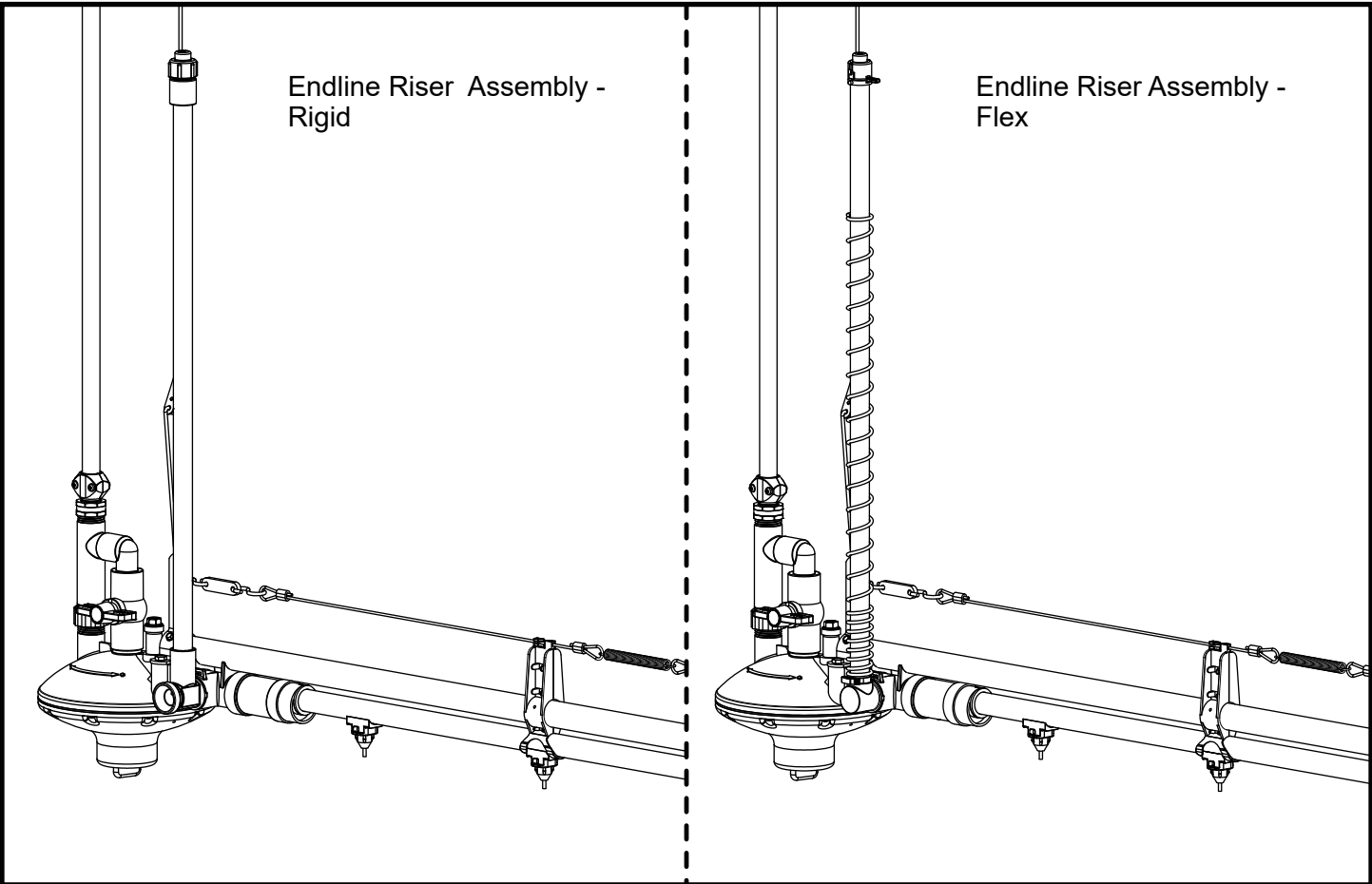

PN 3894 & PN 3895

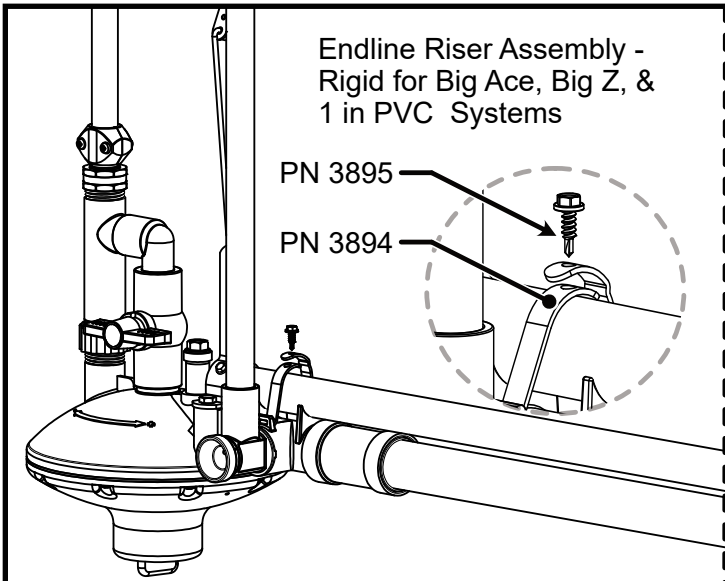

Use impact driver to install screw.
Note: PN 3895 goes over PN 3894.

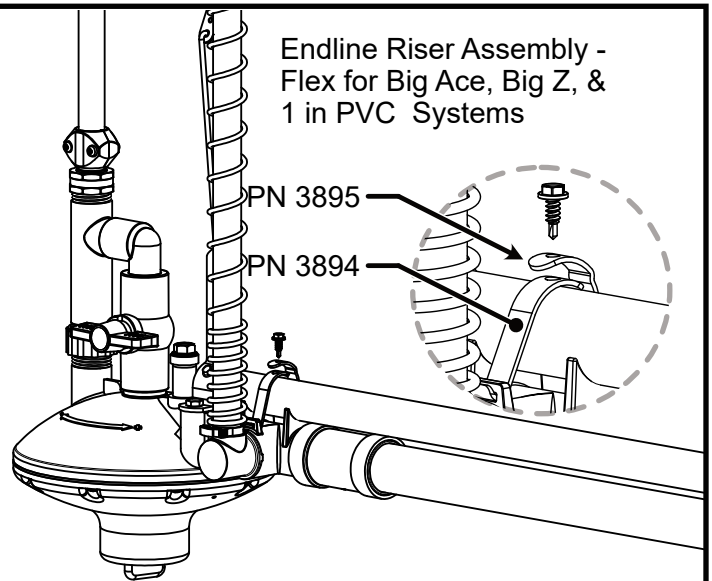

Use impact driver to install screw.
Note: PN 3895 goes over PN 3894.

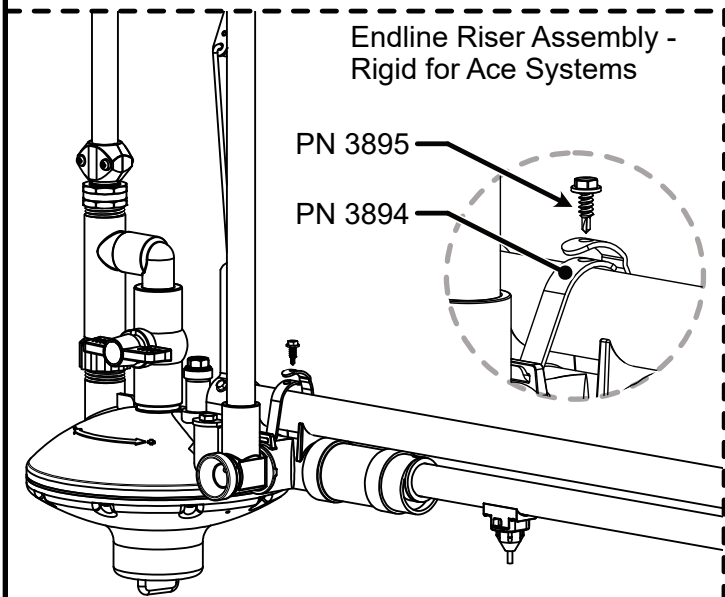

Use impact driver to install screw.
Note: PN 3895 goes over PN 3894.

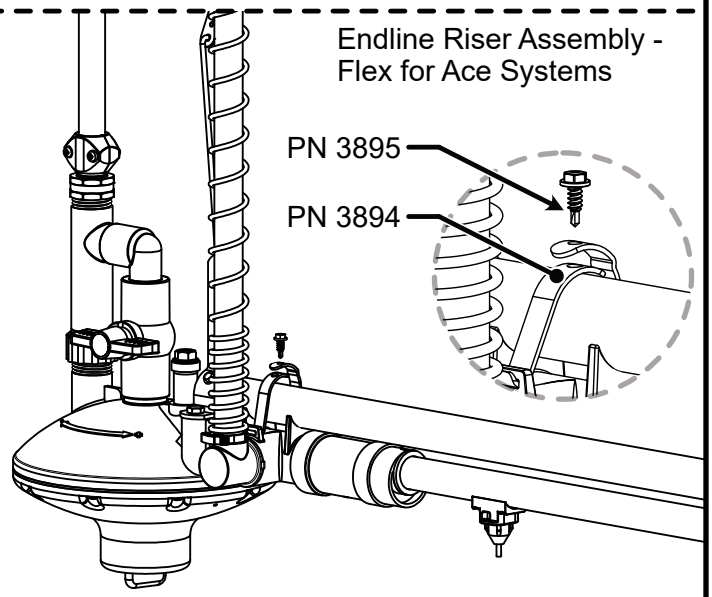

Use impact driver to install screw.
Note: PN 3895 goes over PN 3894.

Classic End Assembly to Nuvo™ Endline Riser

DISASSEMBLY: CLASSIC END ASSEMBLY

1

Classic System Assembly

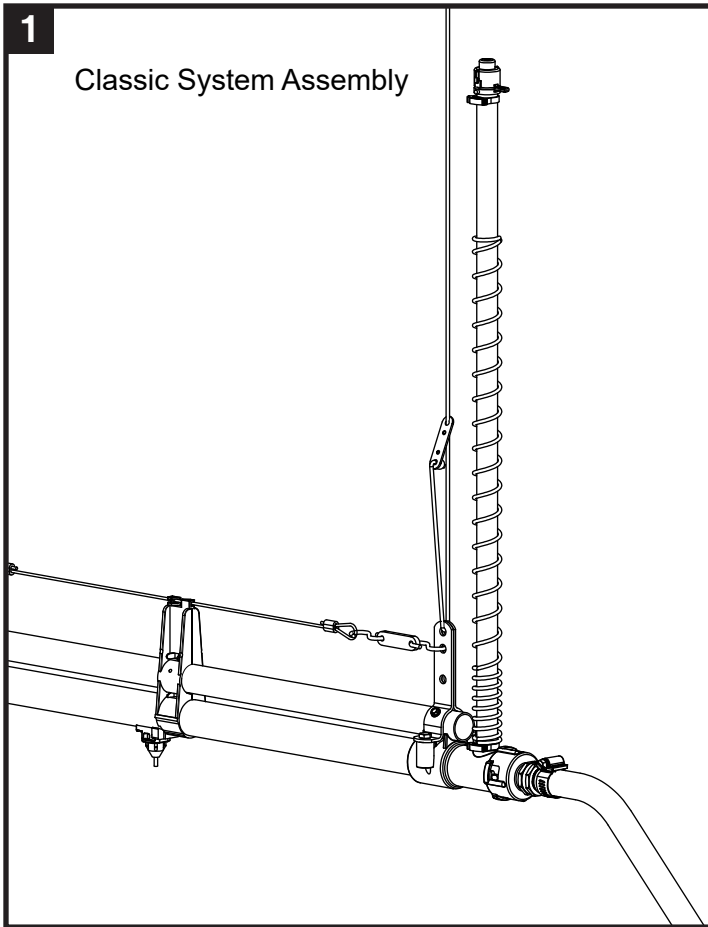

2

Remove the riser tube, spring, cap, clamps, and ball from the regulator assembly.

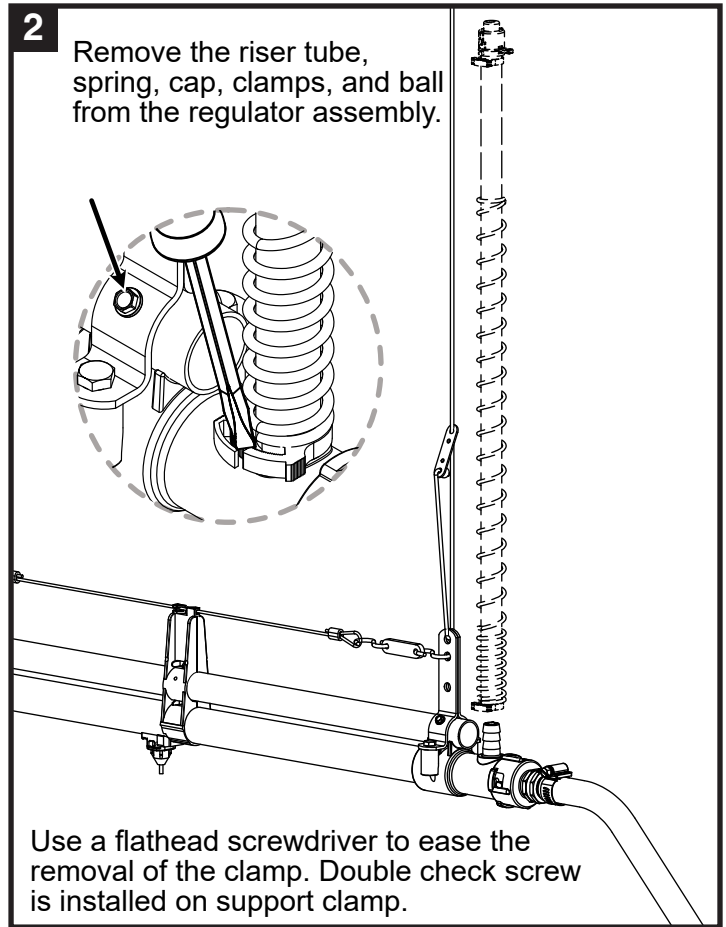

Use a flathead screwdriver to ease the removal of the clamp. Double check screw is installed on support clamp.

SEALING PLUG (PN 4142)

3

Install sealing plug into end assembly stem.

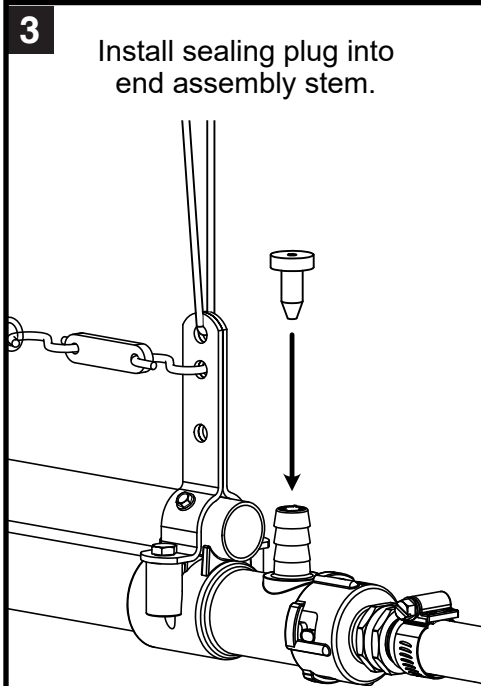

Install screw into sealing plug until fully seated.

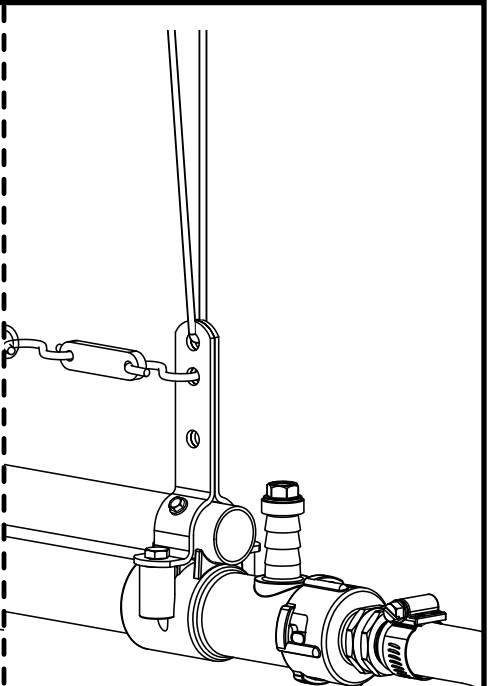
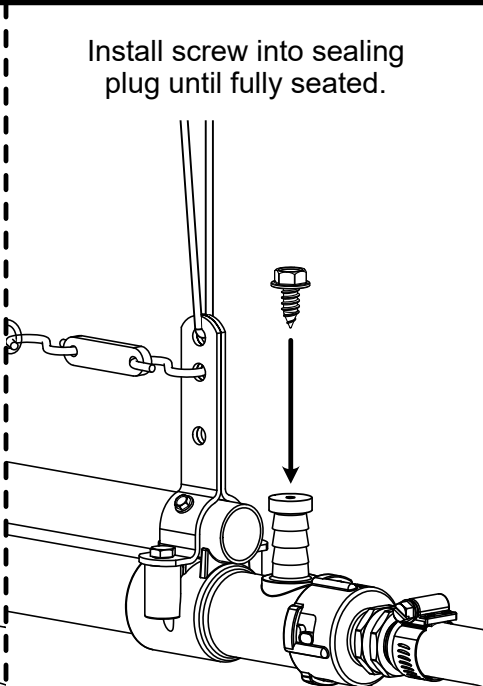

Do Not Overtighten.

Torque Settings: 1.7 Nm / 15 in lbs MAX.

PREPARATION FOR CUT-IN LOCATION: END ASSEMBLY

1

Remove the two bolts from the support clamp.

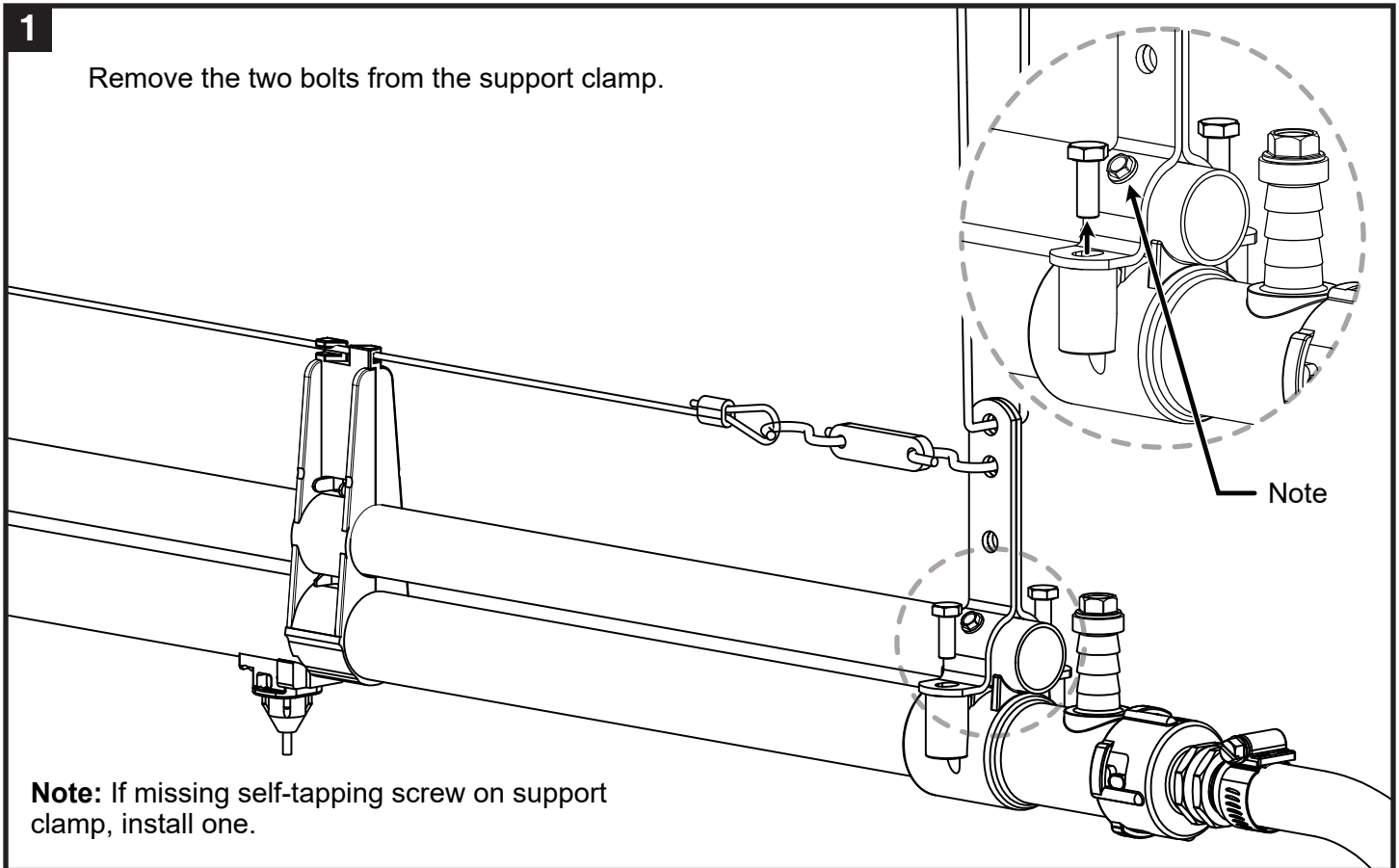

2

Pull the end assembly off the end of the pipes.

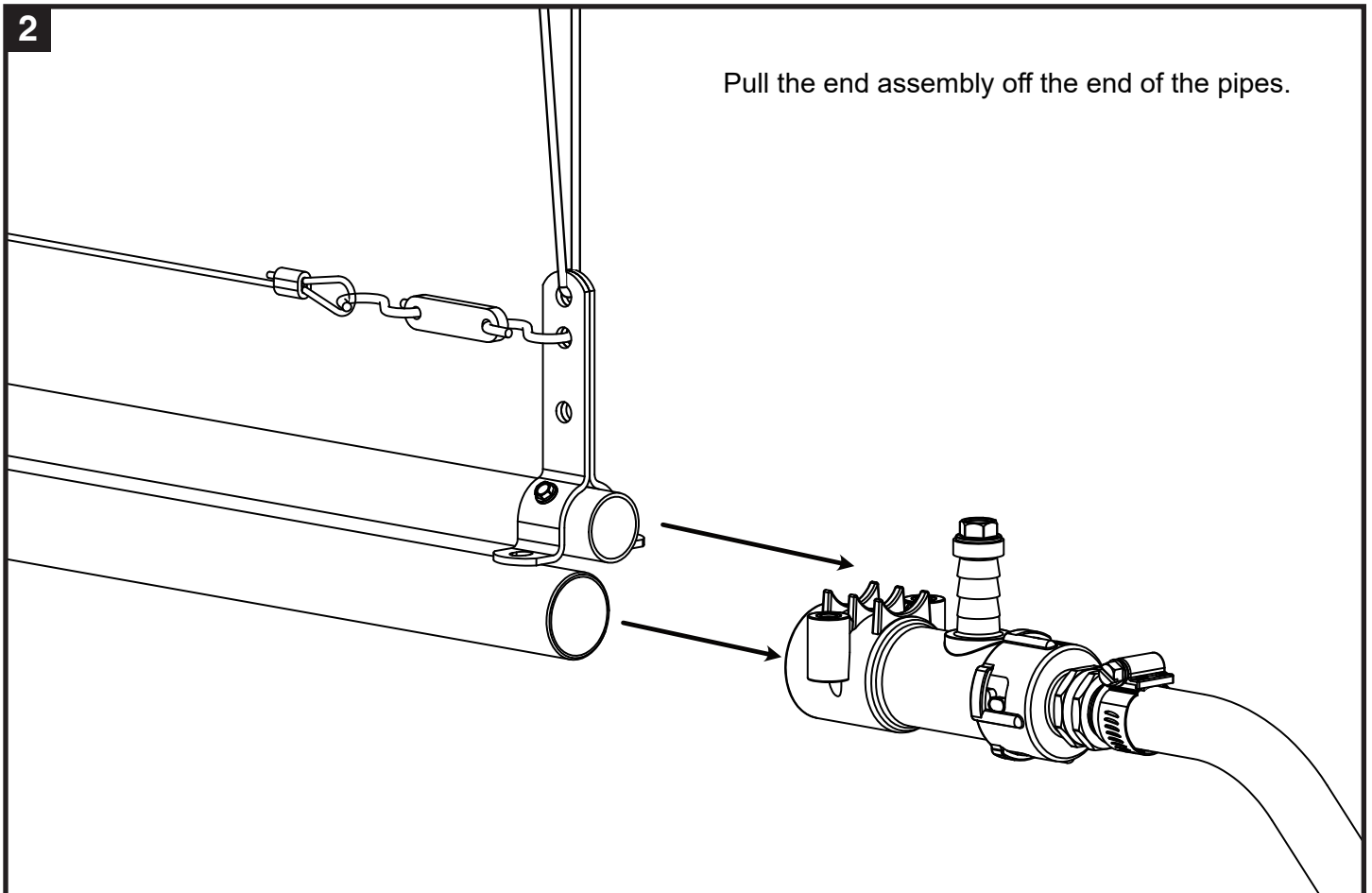

CUT-IN LOCATIONS FOR BIG ACE, BIG Z, & 1 IN PVC SYSTEMS

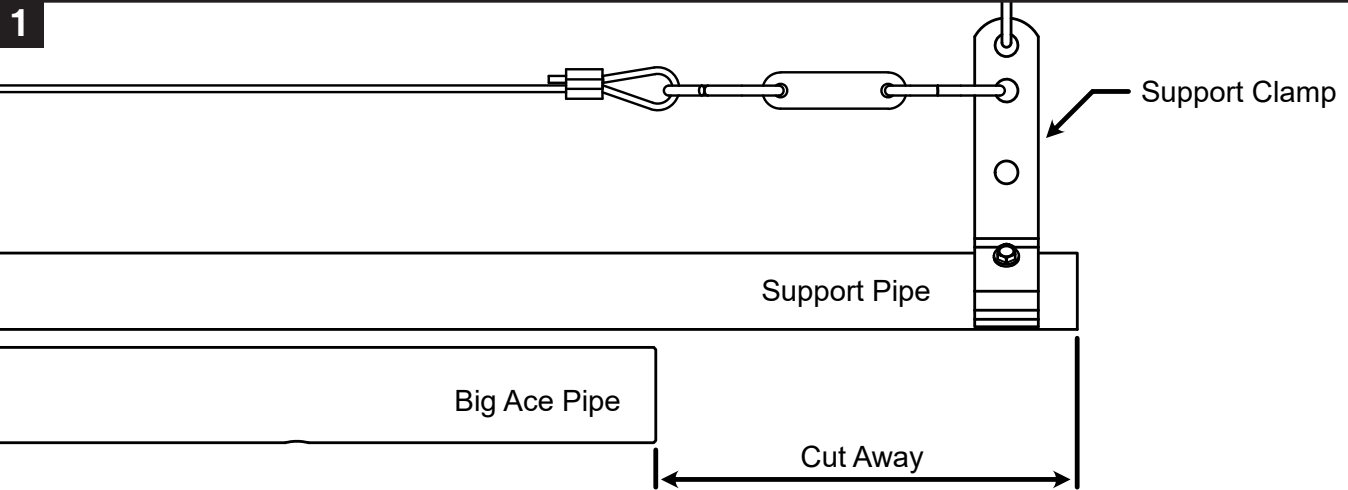

To fit the Endline Riser Assembly onto pipes, make sure the cut away is 155 mm / 6 in.

CUT-IN LOCATION FOR ACE SYSTEMS

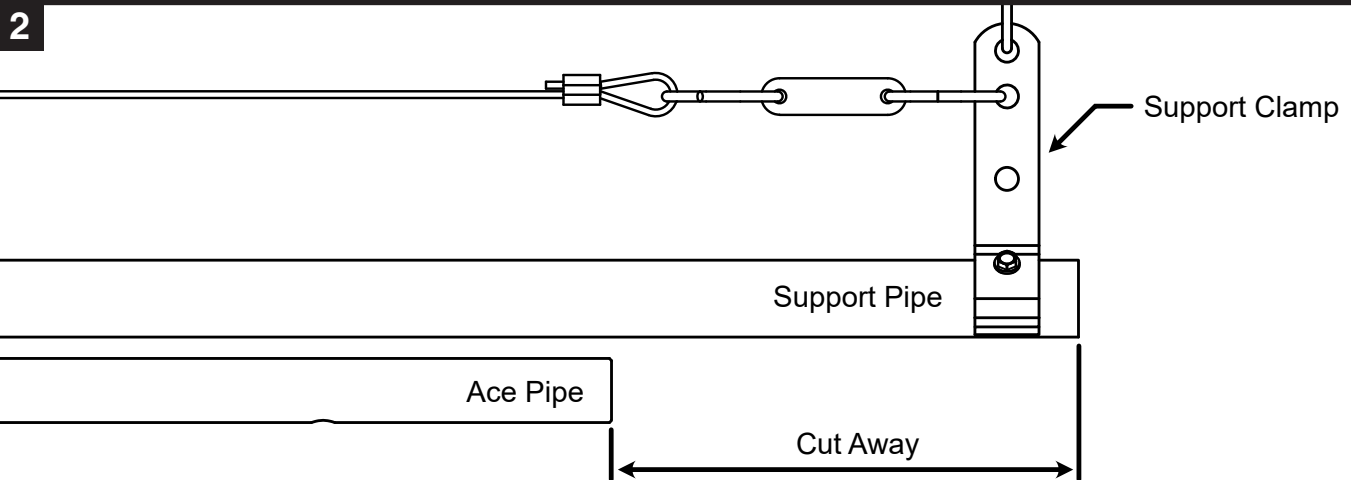

To fit the Endline Riser Assembly onto pipes, make sure the cut away is 165 mm / 6-1/2 in.

NUVO™ ENDLINE RISER ASSEMBLY

ENDLINE RIGID RISER PN 3972 or PN 3978

Note: Rigid Riser Assembly for Broiler Applications only

PN 1369 for
Ace Systems
only

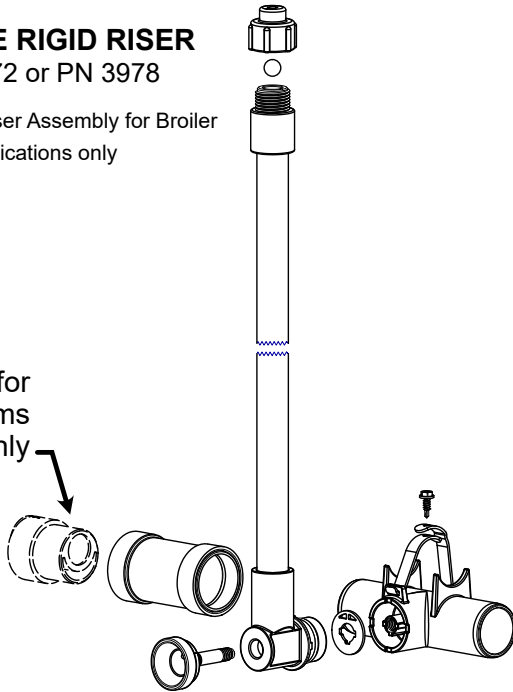

ENDLINE FLEX RISER PN 3970 or PN 3976

PN 1369 for
Ace Systems
only

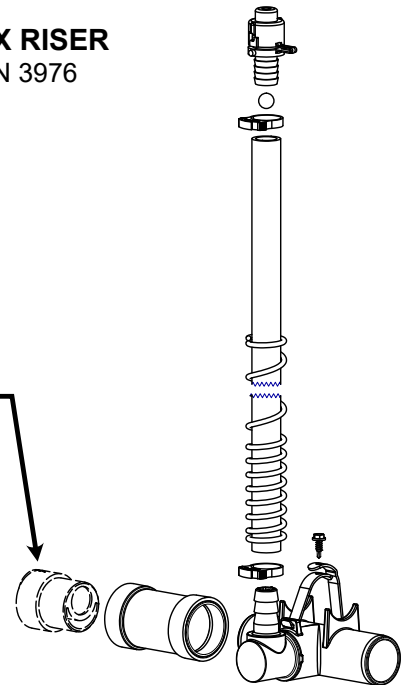

ENDLINE RISER ASSEMBLY ONTO PIPES - BIG ACE, BIG Z, & 1 IN PVC SYSTEMS

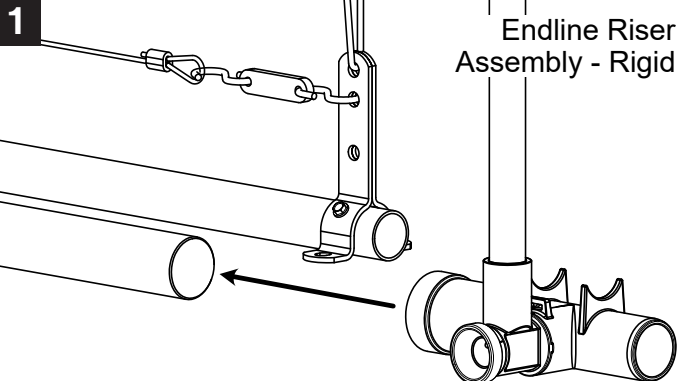

Slide the endline riser assembly onto the Big Ace pipe. Make sure the endline riser assembly is oriented correctly, as illustrated.

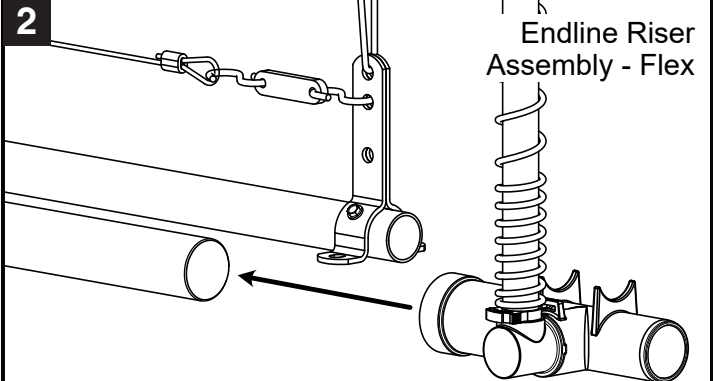

Slide the endline riser assembly onto the Big Ace pipe. Make sure the endline riser assembly is oriented correctly, as illustrated.

ENDLINE RISER ASSEMBLY ONTO PIPES - ACE SYSTEMS

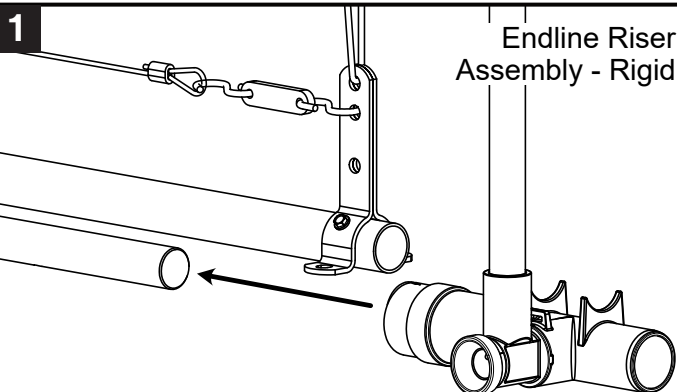

Slide the endline riser assembly onto the Ace pipe. Make sure the endline riser assembly is oriented correctly, as illustrated.

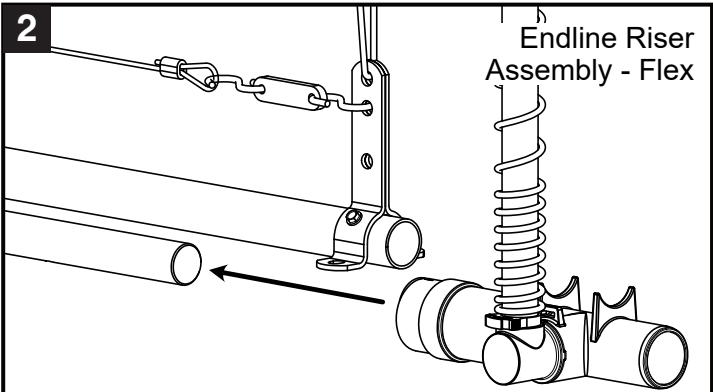

Slide the endline riser assembly onto the Ace pipe. Make sure the endline riser assembly is oriented correctly, as illustrated.

END ASSEMBLY ONTO ENDLINE RISER - BIG ACE, BIG Z, & 1 IN PVC SYSTEMS

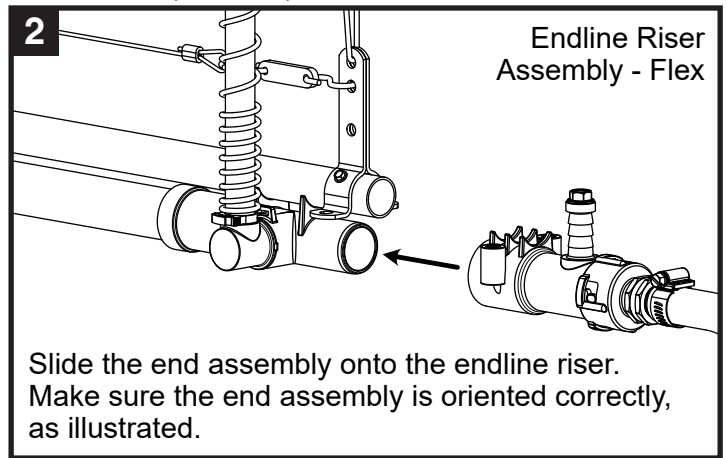
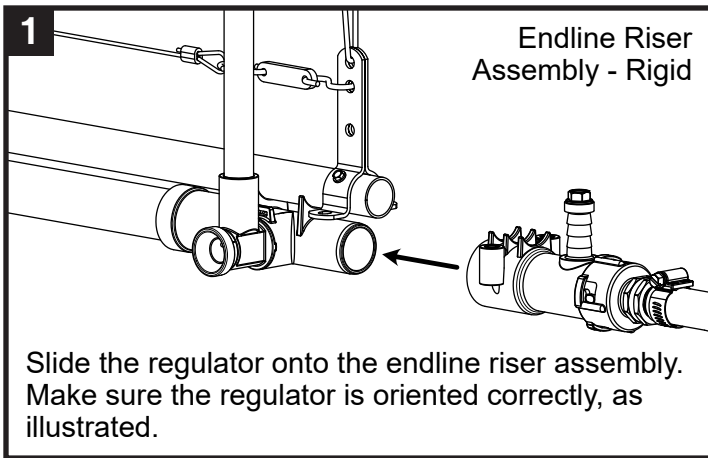

END ASSEMBLY ONTO ENDLINE RISER - ACE SYSTEMS

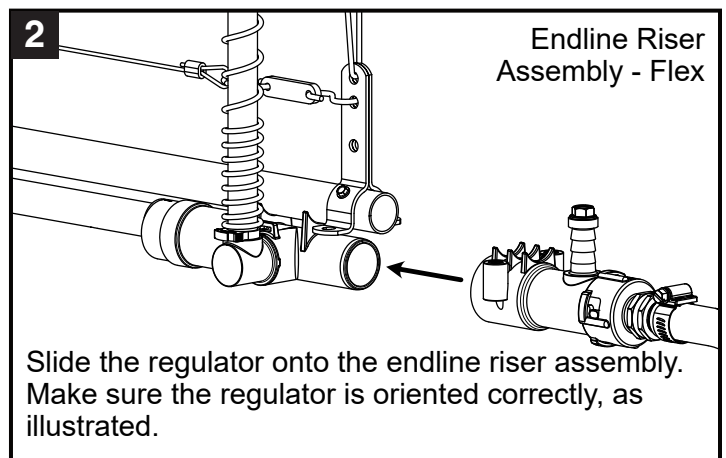
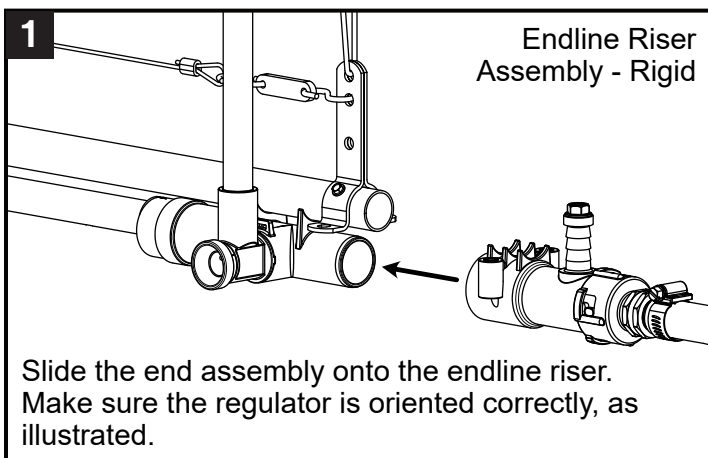

SUPPORT CLAMP FASTENERS

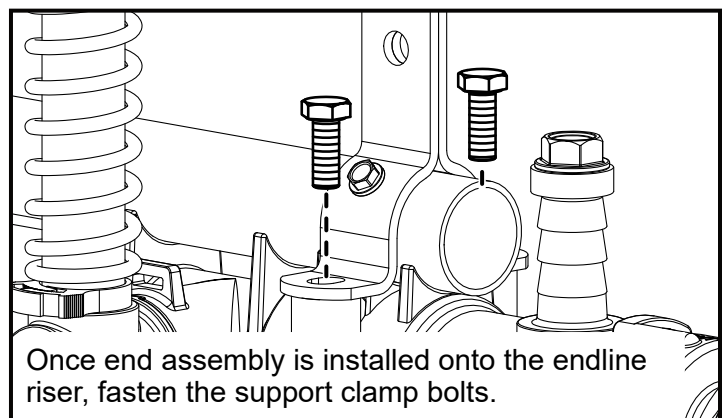
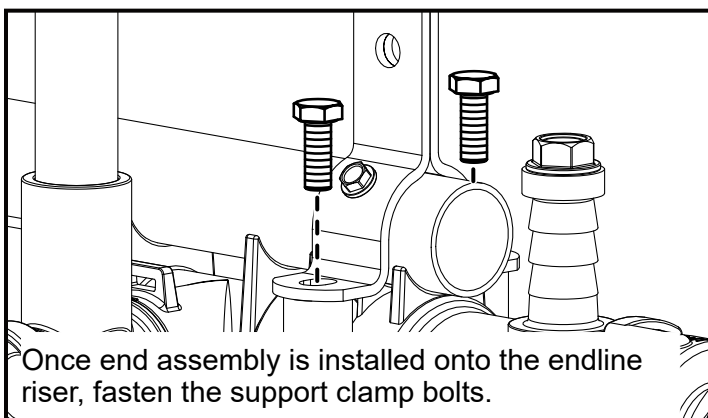

Important: Before fastening the support clamp fasteners, push or pull the endline riser assembly for correct gapping.

NUVO™ ENDLINE RISER ASSEMBLY CONVERSION - BIG ACE, BIG Z, 1 IN PVC SYSTEMS

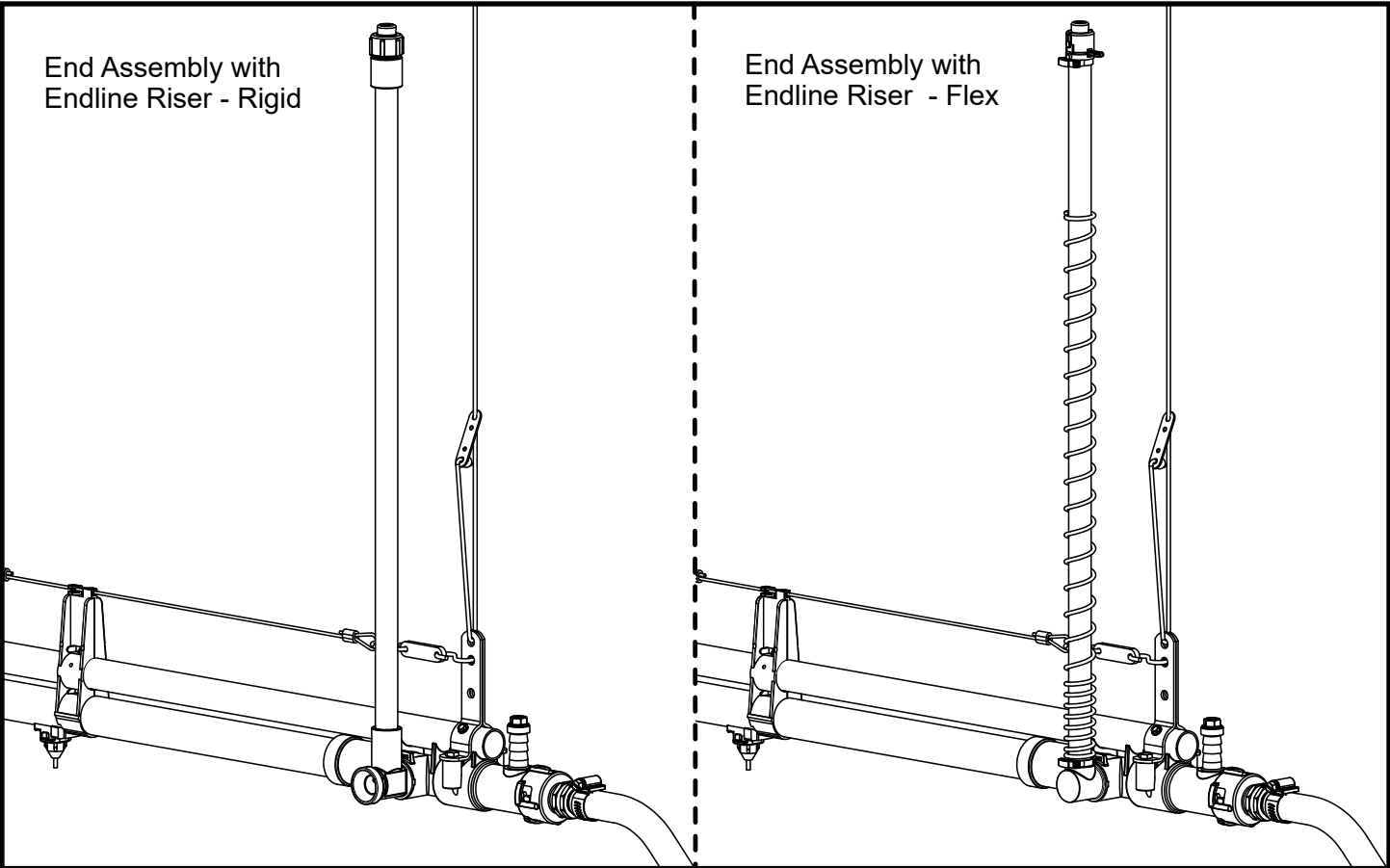

NUVO™ ENDLINE RISER ASSEMBLY CONVERSION - ACE SYSTEMS

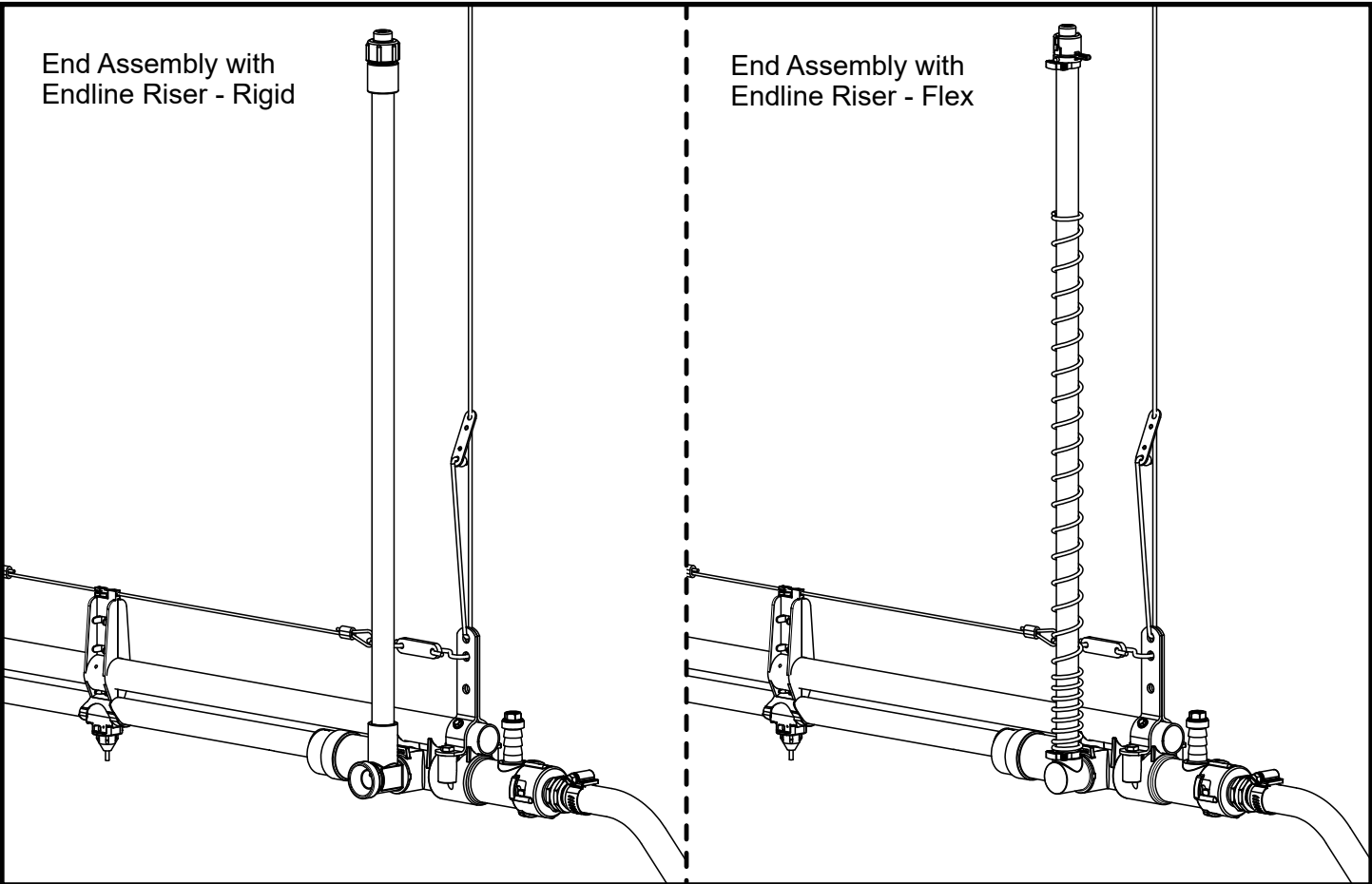

PN 3894 & PN 3895

2

Endline Riser Assembly -
Rigid for Big Ace, Big Z, &
1 in PVC Systems

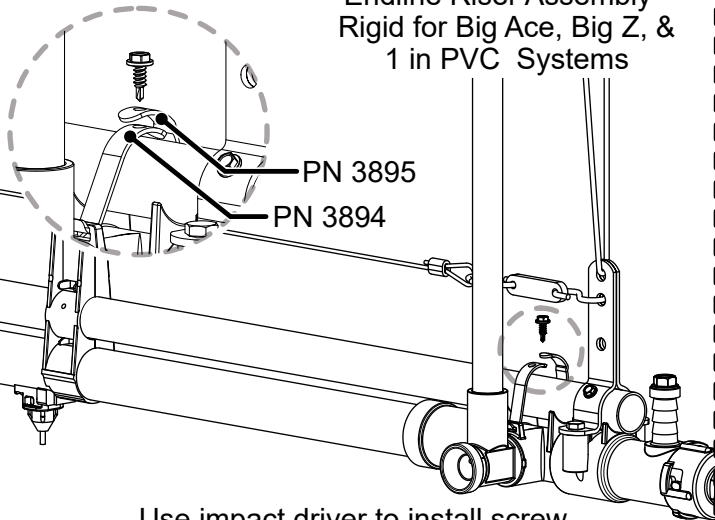

Use impact driver to install screw.
Note: PN 3895 goes over PN 3894.

Endline Riser Assembly -
Flex for Big Ace, Big Z, &
1 in PVC Systems

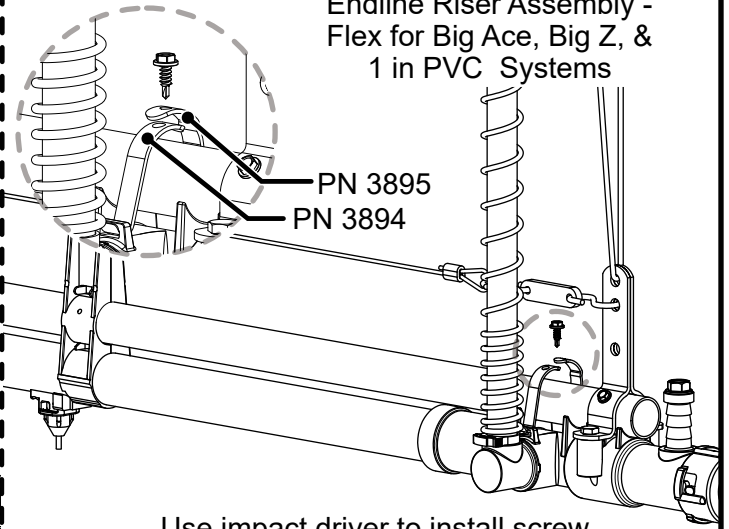

Use impact driver to install screw.
Note: PN 3895 goes over PN 3894.

Endline Riser Assembly -
Rigid for Ace Systems

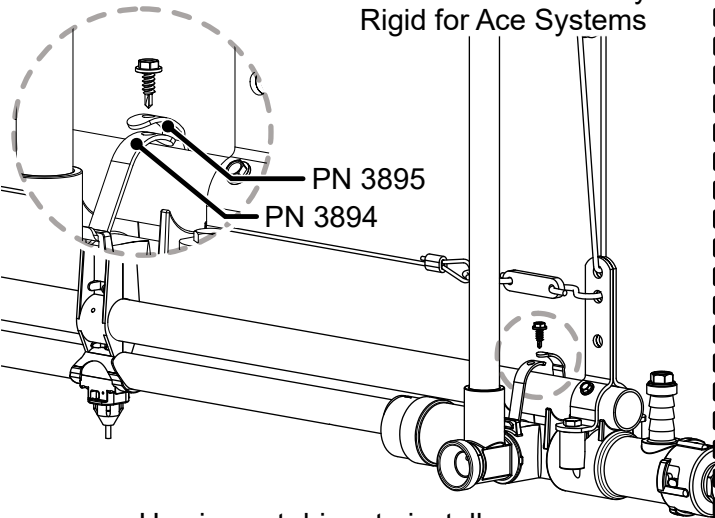

Use impact driver to install screw.
Note: PN 3895 goes over PN 3894.

Endline Riser Assembly -
Flex for Ace Systems

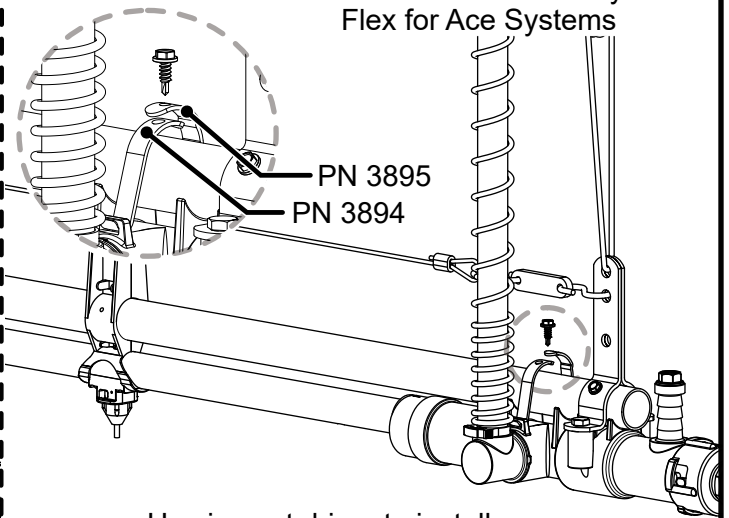

Use impact driver to install screw.
Note: PN 3895 goes over PN 3894.

**For specifics on complete system installation,
Please refer to the Watering System: Floor Application Manual**